

Intensive Japanese Programs

履修案内

Spring and Summer Terms
2025

令和7年度春～夏学期



Center for Japanese Language and Culture
The University of Osaka

大阪大学日本語日本文化教育センター

INTENSIVE JAPANESE PROGRAMS

Spring and Summer Terms

2025

Contents

Academic Calendar	v
Academic Calendar Spring and Summer Terms, 2025	v
Intensive Japanese Programs, CJLC	2
1. Types of Programs	2
2. Classes	2
3. Examinations and Academic Record	4
4. Approval of Completion	6
5. Subject Registration	8
6. Operation of the CJLC Office	10
7. CJLC Library Room	12
8. Forms of Certificates	14
9. Cancellation of classes due to weather warnings, disasters, and suspension of public transportation	16
Undergraduate Students Program [U]	20
1. Program Outline	20
2. Requirements for [U] Program Certificate	20
3. Outline of Subjects	22
3-1. Japanese Language Subjects	24
3-2. Required Subjects Other Than Japanese Subjects	26
4. Entrance into University	28
Japanese Studies Program [J]	30
1. Program Outline	30
2. Requirements for [J] Program Certificate	34
3. Outline of Subjects	36
3-1. Required Subjects	36
3-2. Electives	36
4. Extracurricular Activities	48
Maple Program [M]	50
1. Program Outline	50
2. Requirements for [M] Program Certificate	54
3. Outline of Subjects	56
3-1. Required Subjects	56
3-2. Electives	58
4. Extracurricular Activities	70

The University of Osaka Foundation Program [F]	72
1. Program Outline	72
2. Requirements for [F] Program Certificate	74
3. Outline of Subjects	78
3-1. Japanese Language Subjects	78
3-2. Subjects Other Than Japanese Language	86
3-3. Multicultural Community Cohesion Subject	88
List of Classes	90
Weekly Schedule	98
Abbreviations	107
Minoh Campus Map	108
Floor Map	110
Advisors	114

2025 年度 学年暦 Academic Calendar 2025
《Uプログラム (U Program)》

ようび 曜日(Day) 2月(Month)	にち 日 Sun.	げつ 月 Mon.	か 火 Tue.	すい 水 Wed.	もく 木 Thu.	きん 金 Fri.	ど 土 Sat.
2025年 がっ 4月 April			1	2	3	4	5
		オリエンテーション			①	①	
	6	7	8	9	10	11	12
	13	① 14	健康診断 15	② 16	② 17	② 18	19
	20	② 21	① 22	② 23	③ 24	③ 25	26
	27	③ 28	昭和の日 29	③ 30			
がっ 5月 May					大学祭準備 1	大学祭 2	大学祭 3
	4	大学祭片付け みどりの日 5	こどもの日 6	振替休日 7	④ 8	④ 9	10
	11	④ 12	② 13	④ 14	⑤ 15	⑤ 16	17
	18	⑤ 19	③ 20	⑥ 21	⑥ 22	⑥ 23	24
	25	⑥ 26	④ 27	⑦ 28	⑦ 29	⑦ 30	31
がっ 6月 June							
	1	⑦ 2	⑤ 3	⑧ 4	⑧ 5	⑧ 6	7
	8	⑧ 9	⑥ 10	⑨ 11	⑨ 12	⑨ 13	14
	15	⑨ 16	⑦ 17	見学旅行 (休講) 18	⑩ 19	⑩ 20	21
	22	⑩ 23	⑧ 24	⑩ 25	⑩ 26	⑪ 27	28
	29	⑪ 30					
がっ 7月 July			⑨ 1	⑪ 2	⑪ 3	⑫ 4	5
	6	⑫ 7	⑩ 8	⑫ 9	⑫ 10	⑬ 11	12
	13	⑬ 14	⑪ 15	⑬ 16	⑬ 17	⑭ 18	19
	20	海の日 21	⑫ 22	⑭ 23	⑭ 24	⑮ 25	26
	27	⑭ 28	⑬ 29	⑮ 30	⑮ 31		
						補講 1	2
がっ 8月 August			⑮ 3	⑭ 4	5	6	7
	10	山の日 11	12	13	14	15	16
	17	18	19	20	21	22	23
	24	25	26	27	28	火曜⑮ 29	30
	31						
がっ 9月 September		⑮ 1	⑯ 2	⑯ 3	⑯ 4	⑯ 5	6
	7	⑯ 8	⑰ 9	⑰ 10	⑰ 11	⑰ 12	13
	14	敬老の日 15	⑯ 16	⑯ 17	⑯ 18	⑯ 19	20
	21	⑯ 22	秋分の日 23	⑯ 24	補講 25	⑯ 26	27
	28	⑰ 29	⑰ 30				

ようび 曜日(Day) 2月(Month)	にち 日 Sun.	げつ 月 Mon.	か 火 Tue.	すい 水 Wed.	もく 木 Thu.	きん 金 Fri.	ど 土 Sat.
がっ 10月 October				⑳ 1	㉑ 2	㉑ 3	㉑ 4
	5	㉑ 6	㉑ 7	㉑ 8	㉑ 9	㉑ 10	㉑ 11
	12	スポーツの日 13	㉑ 14	㉑ 15	㉑ 16	㉑ 17	㉑ 18
	19	㉑ 20	㉑ 21	㉑ 22	㉑ 23	㉑ 24	㉑ 25
	26	㉑ 27	㉑ 28	㉑ 29	㉑ 30	㉑ 31	
がっ 11月 November							大学祭 1
	2	大学祭 3	大学祭 4	大学祭片付け 5	㉑ 6	㉑ 7	㉑ 8
	9	㉑ 10	㉑ 11	㉑ 12	㉑ 13	㉑ 14	㉑ 15
	16	㉑ 17	補講 18	補講 19	㉑ 20	㉑ 21	㉑ 22
	23	振替休日 24	㉑ 25	㉑ 26	㉑ 27	㉑ 28	㉑ 29
	30						
がっ 12月 December		㉑ 1	㉑ 2	㉑ 3	㉑ 4	㉑ 5	㉑ 6
	7	㉑ 8	進学相談/再試 9	進学相談/再試 10	進学相談 11	進学相談 12	13
	14	㉑ 15	㉑ 16	㉑ 17	㉑ 18	㉑ 19	㉑ 20
	21	㉑ 22	㉑ 23	㉑ 24	月曜㉑ 25	㉑ 26	㉑ 27
	28	29	30	31			
2026年 がっ 1月 January					元日 1	2	3
	4	㉑ 5	㉑ 6	㉑ 7	㉑ 8	㉑ 9	㉑ 10
	11	成人の日 12	㉑ 13	㉑ 14	㉑ 15	休講 16	17
	18	㉑ 19	㉑ 20	補講 21	補講 22	㉑ 23	㉑ 24
	25	㉑ 26	㉑ 27	㉑ 28	㉑ 29	㉑ 30	㉑ 31
がっ 2月 February	1	㉑ 2	㉑ 3	㉑ 4	㉑ 5	㉑ 6	㉑ 7
	8	㉑ 9	㉑ 10	建国記念の日 11	㉑ 12	㉑ 13	㉑ 14
	15	㉑ 16	㉑ 17	㉑ 18	㉑ 19	再試験 20	㉑ 21
	22	天皇誕生日 23	24	25	26	27	28
がっ 3月 March	1	2	3	4	5	6	7
	8	9	修了式 10	11	12	13	14
	15	16	17	18	19	20	21
	22	23	24	25	26	27	28

はる なつがっつき 春～夏学期 Spring and Summer Terms

4月7日～9日 April 7 - 9	オリエンテーション Orientation
4月15日 April 15	けんこうしんだん 健康診断 Medical checkup
5月1日～4日 May 1 - 4	だいがくさいじゆんぱい だいがくさい だいがくさいれんちづ 大学祭準備、大学祭、大学祭片付け University Festival preparations, University Festival, University Festival clean-up
6月18日～19日 June 18 - 19	けんがくりようこうきやうこう 見学旅行 (休講) Study Trip (No Classes)
8月1日、9月25日 August 1, September 25	ほこう 補講 Make-up Classes
8月6日～28日 August 6 - 28	なつやす 夏休み Summer Holidays
8月29日 29-Aug	かようびじつ じやぎやう 火曜日の授業 Tuesday Classes
9月8日～22日 September 8 - 22	9月試験 September Examination

あき ふゆがっつき 秋～冬学期 Fall and Winter Terms

10月31日 October 31	しんがくがせうかい 進学説明会 Infoemation sessions about Japanese universities
11月1日～4日 November 1 - 4	だいがくさい、だいがくさいれんちづ 大学祭、大学祭片付け University Festival, Festival Clean-up
11月18日、19日 1月21日、22日 November 18, 19 January 21, 22	ほこう 補講 Make-up Classes
11月25日～12月8日 November 25 - December 8	12月試験 December Examination
12月9日～12日 December 9 - 12	しんがくがせうだん / さいししけん 進学相談 / 再試験 Consultation on entrance into university / Make-up Exams
12月25日 December 25	げつようび じやぎやう 月曜日の授業 Monday Classes
1月16日 January 16	きやうこう 休講 No Classes
2月4、6～19日 Feburuary 4, 6 - 19	さいししけん 最終試験 Final Examination
2月20日 Feburuary 20	さいししけん 再試験 Make-up Examinations
3月10日 March 10	しやうりようしき 修了式 Closing Ceremony
	じやぎやうび 授業日 Classes
	ほこうび 補講日 Make-up Classes
	しけんび 試験日 Examinations

しやくくろ <祝日 Public Holidays>

4月29日 April 29	しやわのひ 昭和の日 Shōwa Day	8月11日 August 11	やまのひ 山の日 Mountain Day	11月3日 November 3	ぶんかのひ 文化の日 Culture Day	2月11日 Feburuary 11	けんこくきねん のひ 建国記念の日 National Foundation Day
5月3日、4日、5日、6日 May 3, 4, 5, 6	けんぽうきねんび 憲法記念日、みどりの日、 こどもの日、振替休日 Constitution Memorial Day, Greenery Day, Children's Day Substitute Holiday	9月15日 September 15	けいろう のひ 敬老の日 Respect for the Aged Day	11月23日、24日 November 23, 24	きんろうきんしやう のひ、 勤労感謝の日、振替休日 Labour Thanksgiving Day, Substitute Holiday	2月23日 Feburuary 23	てんのうたんじゆうび 天皇誕生日 Emperor's Birthday
		9月23日 September 23	しゆうぶん のひ 秋分の日 Autumnal Equinox Day	1月1日 January 1	しんにづ 元日 New Year's Day	3月20日 March 20	しゆんぶん のひ 春分の日 Vernal Equinox Day
7月21日 July 21	うみのひ 海の日 Marine Day	10月13日 October 13	スポーツのひ スポーツの日 Sports Day	1月12日 January 12	せいじん のひ 成人の日 Coming-of-age Day		

2025 年度 学年暦 Academic Calendar 2025

《 J/M/O プログラム (J/M/O Program) 》

ようび 曜日 (Day) つき (Month)	にち 日 Sun.	げつ 月 Mon.	か 火 Tue.	すい 水 Wed.	もく 木 Thu.	きん 金 Fri.	ど 土 Sat.
2025 年 がつ 4月 April			1	2	3	4	5
	6	① 7	① 8	① 9	① 10	① 11	12
	13	② 14	② 15	② 16	② 17	② 18	19
	20	③ 21	③ 22	③ 23	③ 24	③ 25	26
	27	④ 28	昭和の日 29	④ 30			
がつ 5月 May					大学祭準備 1	大学祭 2	大学祭 憲法記念日 3
	4	大学祭片付 みどりの日 5	こどもの日 6	振替休日 7	④ 8	④ 9	10
	11	⑤ 12	④ 13	⑥ 14	⑤ 15	⑤ 16	17
	18	⑥ 19	⑤ 20	⑦ 21	⑥ 22	⑥ 23	24
	25	⑦ 26	⑥ 27	⑧ 28	⑦ 29	⑦ 30	31
がつ 6月 June	1	⑧ 2	⑦ 3	⑨ 4	⑧ 5	⑧ 6	7
	8	⑨ 9	⑧ 10	⑩ 11	⑨ 12	⑨ 13	14
	15	⑩ 16	⑨ 17	見学旅行 (休講) 18 19		⑩ 20	21
	22	⑪ 23	⑩ 24	⑪ 25	⑩ 26	⑪ 27	28
	29	⑫ 30					
がつ 7月 July			⑪ 1	⑫ 2	⑪ 3	⑫ 4	5
	6	⑬ 7	⑫ 8	⑬ 9	⑫ 10	⑬ 11	12
	13	⑭ 14	⑬ 15	⑭ 16	⑬ 17	⑭ 18	19
	20	海の日 21	⑭ 22	⑮ 23	⑭ 24	⑮ 25	26
	27	⑮ 28	⑮ 29	補講 30	⑮ 31		
がつ 8月 August						補講 1	2
	3	特別授業 4	5	6	7	修了式 8	9
	10	山の日 11	12	13	14	15	16
	17	18	19	20	21	22	23
	24	25	26	27	28	29	30
	31						
がつ 9月 September		1	2	3	4	5	6
	7	8	9	10	11	12	13
	14	敬老の日 15	16	17	18	19	20
	21	22	秋分の日 23	24	25	26	27
	28	29	30				

はる なつがつき 春～夏学期 Spring and Summer Terms

4月7日～18日
April 7 - 18

履修登録確認期間
Class Registration Confirmation Period

5月1日～4日
May 1 - 4

大学祭準備、大学祭、大学祭片付け
University Festival preparations, University Festival, University Festival clean-up

6月18日～19日
June 18 - 19

見学旅行(休講)
Study Trip (No Classes)

7月30日、8月1日
July 30, August 1

補講
Make-up Classes

7月14、16、18日
July 14, 16, 18

学期末試験
Final Examination

7月22～29日、31日
July 22-29, 31

Final Examination

8月4日
August 4

特別授業
Special Classes

8月8日
August 8

修了式
Closing Ceremony

8月9日～
August 9 -

夏休み
Summer Holidays

しゅくじつ 祝日 Public Holidays

4月29日
April 29

昭和の日
Shōwa Day

5月3日、4日、5日、6日
May 3, 4, 5, 6

憲法記念日、みどりの日、こどもの日
Constitution Memorial Day, Greenery Day, Children's Day
ふりかえきゅうじつ
振替休日
Substitute Holiday

7月21日
July 21

海の日
Marine Day

8月11日
August 11

山の日
Mountain Day

9月15日
September 15

敬老の日
Respect for the Aged Day

9月23日
September 23

秋分の日
Autumnal Equinox Day

じゅぎょうび 授業日 Classes

ほこうび 補講日 Make-up Classes

しけんび 試験日 Examinations

Intensive Japanese Programs

1. Types of Programs

The Center for Japanese Language and Culture, The University of Osaka, offers various short-term intensive Japanese programs, mainly for Monbu-kagaku-sho (MEXT) scholarship students. They are categorized into the following programs according to the content. Each program is described in detail in its proper section.

- ① Undergraduate Students Program [U] (Classes: between April and March)
- ② Japanese Studies Program [J] (Classes: between October and August)
- ③ Maple Program [M] (Classes: between October and August)
- ④ The University of Osaka Foundation Program [F] (Classes: between October and March)
- ⑤ OU-MU Short-term Program in Japanese Language and Culture [O] (Classes: between March and August)

2. Classes

(1) Terms

There are four terms (two semesters) each year: Spring and Summer Terms (Spring Semester) (April 1 to September 30) and Fall and Winter Terms (Fall Semester) (October 1 to March 31 of the following year).

U Program classes are held for 35 weeks per year.

J Program and M Program classes are held for 30 weeks per year – 15 weeks in the spring semester and 15 weeks in the fall semester. F Program classes are held for 15 weeks, only in the fall semester. There are also term courses offered for 8 weeks in the winter term or 8 weeks in the spring term.

(2) Class meeting times

There are five 90-minute time periods, each day from Monday to Friday.

Period	Class meeting times
1st Period	8 : 50 a.m. – 10 : 20 a.m.
2nd Period	10 : 30 a.m. – 12 : 00 p.m.
3rd Period	1 : 30 p.m. – 3 : 00 p.m.
4th Period	3 : 10 p.m. – 4 : 40 p.m.
5th Period	4 : 50 p.m. – 6 : 20 p.m.

(3) Credit hours

According to the type of course, credit hours are prescribed as follows:

Category	Lecture/Seminar		Category	Recitation	
Credit hours	Class: 15 credit hours	Private study: 30 credit hours	Credit hours	Class: 30 credit hours	Private study: 15 credit hours

(4) Cancellation of classes

Cancellation of a class will be announced on the bulletin board near the CJLC Office. Be sure to check the bulletin board before attending a class.

When the instructor in charge does not appear in the classroom within 30 minutes from the start time of the class and there is no cancellation notice on the bulletin board, please contact the CJLC Office and follow its instructions.

Classes may be cancelled when public transportation service is suspended or a storm warning as well as an emergency warning are issued. Please refer to the Guidelines for Cancellation of Classes due to weather warnings, disasters, and suspension of public transportation (see p.16) to see whether classes will be cancelled.

(5) Supplementary classes

Supplementary classes may be held to make up for a delay in progress or a cancelled class. Information on supplementary classes will be given directly by the instructor in charge and posted on the bulletin board.

3. Examinations and Academic Record

(1) Examinations

Evaluation methods include written and oral examinations, reports, papers, practical and other examinations. For some courses, the rate of attendance and marks in unscheduled examinations are also reflected in grading, or substituted for marks in scheduled examinations. For the evaluation method of each course, see the volume Syllabus through KOAN.

● Matters to note regarding examinations

- ① Information on scheduled examinations will be posted on the bulletin board or made an oral announcement from the instructor in charge.
- ② If you appear in the classroom later than 30 minutes from the start time of the examination, you will not be allowed to take the examination. Be careful not to be late for an examination. Students may leave the classroom 45 minutes from the start time of an examination.
- ③ If a student is caught cheating or doing other unfair conduct in an examination, he/she should immediately stop the test, and his/her registration for the subject will be cancelled. Students guilty of unfair conduct will be subjected to disciplinary action in accordance with the school regulations.
- ④ Taking an examination in a subject for which you have not been registered will not receive credit.

(2) Grading

Achievement in each subject is evaluated as Grade S, A, B, C, or F as shown in the table below:

Assessment	Passed				Failed
Grade	S	A	B	C	F
Score (out of 100)	100-90 scores	89-80 scores	79-70 scores	69-60 scores	59-0 scores

(3) Notification of grades

The grades in subjects for which students have registered are notified by Transcript/Academic Record to each student after the closing ceremony.

4. Approval of Completion

(1) Requirements for a certificate

It is necessary to complete all the subjects required in the program. For details, such as the titles of subjects and the numbers of required subjects and electives, see the each program outline given later.

The approval/disapproval of completion of courses is announced in September for the August and summer terms and in March for the fall and winter terms.

(2) Certificate of Completion

Certificates will be issued to students who satisfy all the requirements for completion of the program in the prescribed manner.

5. Subject Registration

(1) Placement: Evaluation of degree of proficiency in Japanese

To register for the subjects offered by the CJLC, students need to be evaluated for their degree of proficiency in Japanese. The evaluation is done through a placement test. You can take grammar, Kanji and composition test at the CJLC website. For more information of the placement test will be notified by Email.

(2) Orientation Sessions by Program

Before or at the beginning of each term, the orientation sessions by program will be held. All the students are required to attend the orientation to take classes in each program. The schedule and location of Orientation Sessions by program will be announced by Email.

(3) Registration

Subject registration questionnaire will be conducted every term.

If you fail to register for a subject, you will not be graded for the subject or considered to have completed the subject, even if you attend the class. Any corrections in the subject registration forms should be made within the registration period. Take care in preparing and submitting your registration form.

The last day of the registration period is usually about two weeks after the beginning of classes.

● Matters to note regarding subject registration

- ① You cannot register for a course which is not a designated subject.
- ② For some subjects, students are allowed to register for designated courses only. At the Orientation Sessions by Program mentioned in section (2) above, information will be given about important matters in registration. Be sure to pay attention to this information and follow the instructions in registering for subjects.
- ③ After the deadline of the subject registrations, double-check that all requirements have been completed. If there are any corrections, you must let CJLC office know immediately.

(4) Paper of completion course

In some programs/courses, students are required to submit a paper for completion of the course. In accordance to the instructions in the each program outline given later, submit the paper by the deadline.

6. Operation of the CJLC Office

(1) Office hours

The location and office hours of the CJLC Office are as follows :

※ Monday-Friday (holidays excluded)

Location	7th floor, Center for Japanese Language and Culture Office	
Office hours	a.m.	10:00 - 11:30
	p.m.	12:30 - 4:30

N.B. Unscheduled closures or changes in the office hours will be announced on the bulletin board.

(2) Communication of curriculum-related information

All curriculum-related information, such as on classes and examinations, will be communicated through the bulletin board or Email. Be sure to check the bulletin board and Email near the office of the CJLC Office before attending a class.

(3) Certificates

For student-related certificates, apply to the CJLC Office, using a Request for Certificate form. A certificate will be issued seven days from the date of application, as a rule. Around the end of the semester (March), when many students make applications, it may take 10 days or so.

Regarding the main student-related certificates issued at the CJLC Office, please refer to page 14.

- ① Transcript / Academic Record
- ② Certificate of Program Completion
- ③ Enrollment Certificate

7. CJLC Library Room

The CJLC Library Room can be found on the 7th floor. The "LIBRARY CARD" is necessary in order to enter the room. In addition to general books, you will find various textbooks as well as workbooks on learning Japanese, and there is an area where students can study while listening to CDs that come with these books.

Regarding Japanese literature material, the library room facilitates equipment for viewing audio visual material: genres ranging from entertainment, movies, drama, to anime and so on. In order to find the material that you want to use, search the "Japanese Literature Data and Audio Visual Materials Database" found on the CJLC website. Students can use the computers and printers in the CJLC Library Room.

The CJLC Library Room is open from Monday through Friday, 10:00-11:30, 12:30-16:20 (holidays excluded).

(Note) The CJLC Library Room will be closed temporarily on an as-needed basis.

8. Forms of Certificates

①- 1 For U Program

TRANSCRIPT				No. _____	
				(Government Sponsored Foreign Student)	
Institution	Center for Japanese Language and Culture			Admission :	
Nationality		Name		Date Of Birth	
ID Number				Sex	

Curriculum Class Evaluation					
Curriculum Class				Grade	Hrs Per Week
Japanese Language	Listening				
	Reading				
	Grammar				
	Kanji				
	Oral Presentation				
	Composition				
Japanese Cultural Background					
English					
Humanities	Political Science and Economics				
	Japanese History				
	Mathematics(Elective)				
Natural Science	Mathematics				
	Chemistry				
	Physics				
	Biology				

Grading Scale
S : 90 ~ 100
A : 80 ~ 89
B : 70 ~ 79
C : 60 ~ 69
F : 0 ~ 59
N/A : Not Applicable

M/D/YYYY

OFFICIAL SEAL OF

Center for Japanese Language and Culture

The University of Osaka

Director

Center for Japanese Language and Culture

The University of Osaka

①-2 For other Programs

[illegible]

② Certificate of Program Completion

CERTIFICATE

Program :
Period of Attendance :
Status :
Name :
Sex :
Date of Birth :
Country :
Date of Graduation :

This is to certify that the above record is true and correct.

OFFICIAL SEAL OF
Center for Japanese Language and Culture
The University of Osaka

Director
Center for Japanese Language and Culture
The University of Osaka

③ Enrollment Certificate

C E R T I F I C A T E	
Name:	
Date of Birth:	
Date of Enrollment:	
This is to certify that the above record is true and correct.	
President of The University of Osaka	Official Seal of The University of Osaka

9. Cancellation of classes due to weather warnings, disasters, and suspension of public transportation

- As a general rule, online classes (including regular examinations) will still be held under severe weather warnings.
- However, if circumstances make it difficult to hold online classes, departments may decide to cancel classes. You will be notified via KOAN if classes have been cancelled.
- If you live in/commute through an area which has been issued a storm warning/emergency warning or has experienced an earthquake with a seismic intensity (*shindo*) of 5+ or higher and you will not be able to attend online classes due to evacuation and/or evacuation preparations, your department will make arrangements to prevent any penalties with regards to your studies, so please contact the academic affairs section of your department.

(1) Cancellation of classes after issuance of weather warnings

If a “Storm Warning (暴風警報)” or an “Emergency Warning* (特別警報)” is issued for the region including Toyonaka, Suita, Ibaraki, and Minoh cities, classes will be cancelled. If either of these warnings are issued during a class, classes will be cancelled beginning with the next class.

*Classes will be cancelled for an issuance of *any type* of Emergency Warning (特別警報).

(2) Cancellation of classes during suspension of public transportation

If service of one or more of the following lines of public transportation has been suspended (including partial suspension) due to a disaster, natural or man-made, classes held on the campus(es) affected by this suspension will be cancelled.

① Toyonaka Campus	Hankyu Railway (Takarazuka Line: Osaka-umeda – Takarazuka) or Osaka Monorail (all lines)
② Suita Campus	Hankyu Railway (Senri Line: Osaka-umeda/Tenjinbashisujirokuchome – Kita-senri) or Osaka Monorail (all lines)
③ Minoh Campus	Osaka Metro (Midosuji Line (including Kita-Osaka Kyuko line): Umeda – Minoh-kayano) or Osaka Monorail (all lines)

However, classes will not be cancelled for temporary suspension of train and/or bus service due to traffic accidents, etc.

(3) Lifting of weather warnings and/or resumption of public transportation service

If weather warnings are lifted or public transportation services have resumed, classes will be held according to the following chart:

If the warning is lifted or transportation service is resumed...	classes will be...
before 6 am	held all day
after 6 am but before 9 am	held in the afternoon
after 9 am or not at all	cancelled all day

*Confirmation of lifting of weather warnings and/or resumption of public transportation service will be conducted via television, radio, and the internet.

(4) Cancellation of classes following an earthquake

If an earthquake with a strength of 5-upper on the Japanese intensity scale is recorded in the cities of Toyonaka, Suita, Ibaraki, and/or Minoh in Osaka Prefecture, classes for that day will be cancelled. If the earthquake is recorded at 5:15 pm or later, classes for the following day will also be cancelled.

In addition, if an earthquake with a strength of 5-upper is recorded outside of the areas listed above or if an earthquake with a strength of less than 5-upper is recorded in the areas listed above, the guidelines in section 2 regarding cancellation of classes due to suspension/stoppage of public transportation service will apply.

(5) Cancellation of classes due to evacuation orders/emergency safety measures

If an evacuation order or emergency safety measures are issued in the cities of Toyonaka, Suita, Ibaraki, and/or Minoh in Osaka Prefecture, classes may be cancelled in departments located in these areas, so follow the instructions provided by your department.

(6) Other notes

*Even if your classes are not cancelled for any of the reasons listed above, if you were not able to attend class due to inevitable reasons, for example, your residence and/or route to the university has had:

- (a) weather warnings listed in (1) issued,
 - (b) an earthquake with the attributes outlined in (4), and/or
 - (c) public transportation services outside of those delineated in (2) suspended,
- the university will take special consideration to avoid any detriment to you in your studies, so please contact the student affairs staff in the department in which your class is held and/or the student affairs staff in your department.

*If weather warnings, suspension of public transportation, and/or evacuation orders are anticipated, or classes must be cancelled for any other reason, the university will make an announcement via The University of Osaka Official Homepage or KOAN.

Maple Program [M]

1. Program Outline

The Maple Program (The University of Osaka Intensive Japanese Language and Culture Program for Exchange Students) is a short-term student exchange program of The University of Osaka hosted by the Center for Japanese Language and Culture (CJLC).

This one-year program is designed to help students improve their Japanese language skills as well as enhance their knowledge of Japanese culture and society, moving them further towards their respective academic goals. Moreover, it aims to cultivate the human resources required to deeply understand Japan from various perspectives by giving students the academic tools to compare and contrast Japanese language, culture and society with their own, and then share that knowledge widely.

A faculty advisor is assigned by the CJLC to each student enrolled in the program to provide advice regarding subject registration and other academic activities.

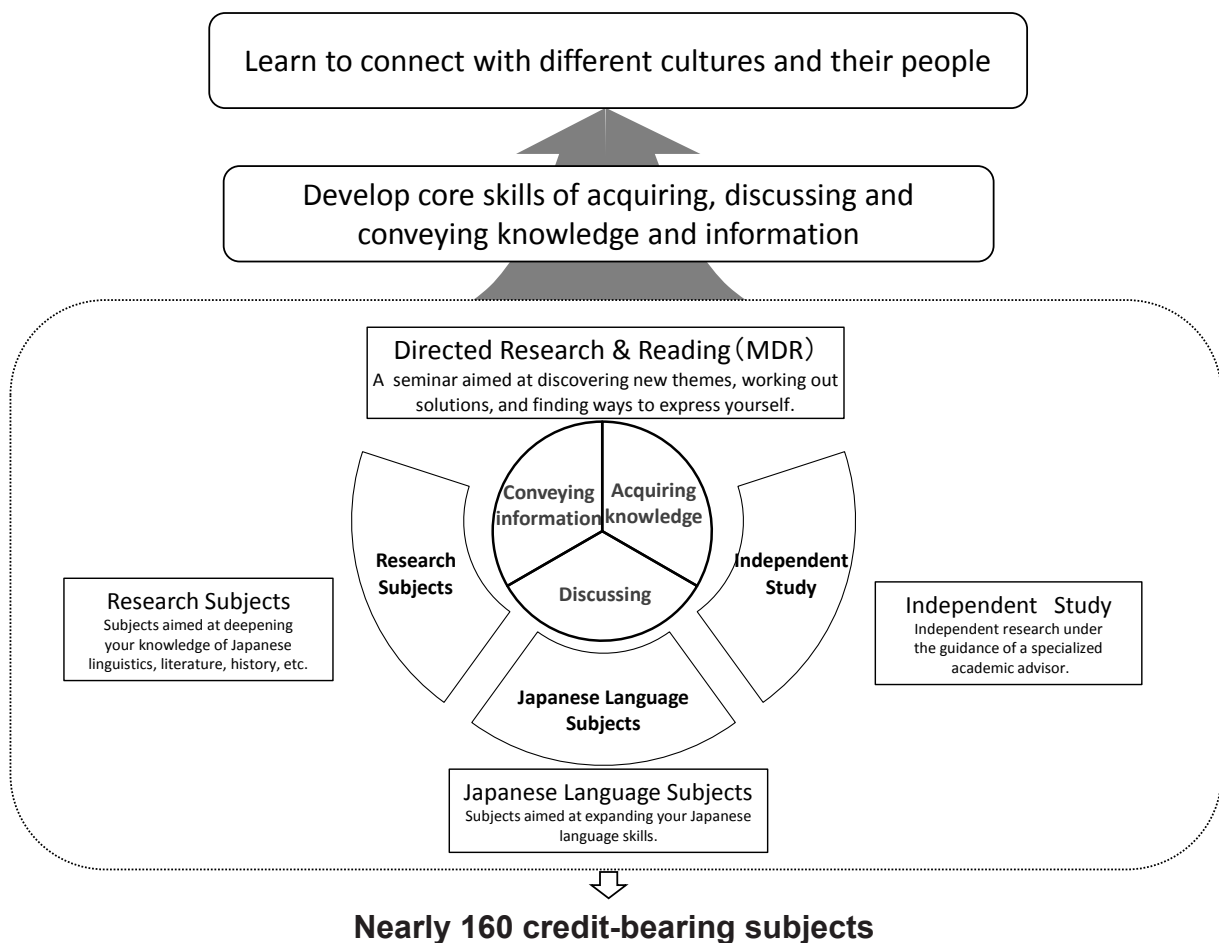

Course information

The Maple Program features four courses: Pre-intermediate, Intermediate, Upper-intermediate and Advanced. Students are placed in one of these four courses based on the results of a preliminary placement test.

Pre-intermediate Course

This course is designed for students evaluated to be within the CJLC's A2 range of Japanese language proficiency. Students learn Japanese language and culture through a range of activities conducted in "Directed Research & Reading" and further refine their grammar and vocabulary through the courses "Pre-intermediate Japanese α: Grammar & Vocabulary" and "Pre-intermediate Japanese β: Grammar & Vocabulary." Students may choose elective classes from both the Pre-intermediate and Intermediate course levels.

Intermediate Course

This course is designed for students evaluated to be within the CJLC's B1 range of Japanese language proficiency. Students learn Japanese language and culture through a range of activities conducted in "Directed Research & Reading" and further refine their grammar and vocabulary through the courses "Intermediate Japanese α: Grammar & Vocabulary" and "Intermediate Japanese β: Grammar & Vocabulary." In addition to classes offered at the Intermediate course level, students may take elective classes from both the Pre-intermediate and Upper-intermediate course levels.

Upper-intermediate Course

The Upper-intermediate Course is intended for students evaluated to be within the CJLC's B2 range of Japanese language proficiency. Students learn Japanese language and culture through a range of activities conducted in "Directed Research & Reading." In addition to classes offered at the Upper-intermediate course level, students may take elective classes from both the Intermediate and Advanced course levels.

Advanced Course

The Advanced Course is designed for students evaluated to be within the CJLC's C1 range of Japanese language proficiency. Students learn Japanese language and culture through a range of activities conducted in "Directed Research & Reading." Advanced Course students may choose elective classes from the Upper-intermediate and Advanced course levels.

2. Requirements for [M] Program Certificate

To complete the program, students must earn 30 or more credits in a year.

Category	Course	Credits	Requirements for completion
Required	Directed Research & Reading (MDR)	2 credits each	30 or more credits in a year
Electives	Research Subjects		
	Independent Study (MIS)		
Required (Pre-intermediate Japanese Course)	Pre-intermediate Japanese α : Grammar & Vocabulary (MGV)	4 credits	
	Pre-intermediate Japanese β : Grammar & Vocabulary (MGV)	2 credits	
Required (Intermediate Japanese Course)	Intermediate Japanese α : Grammar & Vocabulary (MGV)	4 credits	
	Intermediate Japanese β : Grammar & Vocabulary (MGV)	2 credits	
Electives	Japanese Language Subjects	1 credit each	
	Multicultural Community Cohesion Subject (MCC)*		

* “Multicultural Community Cohesion Subject” is a term subject.

※ With their academic advisor’s permission, students may substitute an elective course for Pre-intermediate Japanese α/β : Grammar & Vocabulary and Intermediate Japanese α/β : Grammar & Vocabulary.

3. Outline of Subjects

The Maple Program offers the following subjects: Directed Research & Reading (MDR), Japanese Language Subjects (L), Pre-Intermediate Japanese α/β : Grammar & Vocabulary (MGV), Intermediate Japanese α/β : Grammar & Vocabulary (MGV), Research Subjects in Japanese Studies (R), Independent Study (MIS), and Multicultural Community Cohesion Subject (MCC).

3-1. Required Subjects

All Maple Program students are required to take “Directed Research & Reading.” Students in the Pre- intermediate Course or Intermediate Course are additionally required to take “Pre-intermediate Japanese (α/β): Grammar & Vocabulary” or “Intermediate Japanese (α/β): Grammar & Vocabulary.”

① **【Directed Research & Reading】 (MDR)**

This seminar stimulates comprehensive understanding of Japanese language and culture. By experiencing Japanese culture and society first-hand by going on field trips, and by participating in project-based learning guided by teaching assistants (graduate students), you will come closer to this seminar’s ultimate goal: a comprehensive understanding of Japanese language, culture, and society. To ensure effective and smooth communication, we will focus on the development of three key skills: acquiring knowledge, conveying information, and discussion.

② **【Pre-intermediate Japanese α/β : Grammar & Vocabulary】 (MGV)**

These courses are for students evaluated to be within the CJLC’s A2 range of Japanese language proficiency. The goal of these courses is to improve students’ knowledge of grammar and vocabulary as well as increase their range of practical fluency. Based on the results of a placement examination, students will be required to take either both Pre-intermediate Japanese α (4 units per week) and Pre-intermediate Japanese β (2 units per week), or Pre-intermediate Japanese α alone.

③ **【Intermediate Japanese α/β : Grammar & Vocabulary】 (MGV)**

These courses are for students evaluated to be within the CJLC’s B1 range of Japanese language proficiency. The goal of these courses is to improve students’ knowledge of grammar and vocabulary as well as increase their range of practical fluency. Based on the results of a placement examination, students will be required to take either both Intermediate Japanese α (4 units per week) and Intermediate Japanese β (2 units per week), or Intermediate Japanese α alone.

3-2. Electives

There are three categories of elective class: ① **【Japanese Language Subjects】**, ② **【Research Subjects】**, ③ **【Independent Study】**, ④ **【Multicultural Community Cohesion Subject】**.

For detailed information on classes available each semester, please refer to List of Classes.

① **【Japanese Language Subjects】**

Participating students select from a broad range of elective subjects matched to their individual proficiency level. These include Reading (RDG), Listening (LIS), Writing (WRT), Speaking (SPK), Grammar & Vocabulary (GV), and Kanji & Vocabulary (KV) and are offered at the Pre-intermediate, Intermediate, Upper-intermediate and Advanced course levels.

Japanese Pre-intermediate Reading (RDG)

For A2 students who can:

- understand the Japanese alphabet and basic passages about daily-life situations (for example: pamphlets, schedules, menus, short e-mails, and private letters).

Japanese Pre-intermediate Listening (LIS)

For A2 students who can:

- comprehend audio in daily situations, such as simple short messages or announcements.

Japanese Pre-intermediate Writing (WRT)

For A2 students who can:

- write short messages or memos on daily matters;
- write brief private e-mails.

Japanese Pre-intermediate Speaking (SPK)

For A2 students who can:

- explain daily matters using elementary words, phrases and sentences;
- conduct brief social exchanges with others.

Japanese Pre-intermediate Grammar & Vocabulary (GV)

For A2 students who can:

- understand basic, commonly-used words within elementary vocabulary;
- understand expressions written in basic sentence patterns.

Japanese Pre-intermediate Kanji & Vocabulary (KV)

For A2 students who can:

- read and write basic kanji commonly-used in daily life;
- understand basic and commonly-used kanji expressions.

Japanese Intermediate Reading (RDG)

For B1 students who can:

- comprehend passages written about daily matters or a topic of their interest, for example, newspaper articles or private letter exchanges.

Japanese Intermediate Listening (LIS)

For B1 students who can:

- comprehend audio about daily matters or a topic of their interest, such as weather forecasts or train station announcements.

Japanese Intermediate Writing (WRT)

For B1 students who can:

- write a short essay about their daily life or a topic of their interest;
- write a short letter or e-mail;
- write a cohesive text using basic words and expressions.

Japanese Intermediate Speaking (SPK)

For B1 students who can:

- make a speech about their daily life or a topic of their interest while using tense correctly;
- express their views using subordinate sentences;
- participate in one-to-one conversation;
- pronounce words without causing misunderstandings.

Japanese Intermediate Grammar & Vocabulary (GV)

For B1 students who can:

- understand most elementary vocabulary;
- understand expressions using basic sentence patterns.

Japanese Intermediate Kanji & Vocabulary (KV)

For B1 students who can:

- read and write basic kanji;
- understand basic kanji expressions.

Japanese Upper-intermediate Reading (RDG)

For B2 students who can:

- understand somewhat technical contents within their field of specialty, including introductory textbooks or lecture materials;
- read modern novels;
- infer the meaning of an unfamiliar word;
- read and understand the stance and opinion of the author.

Japanese Upper-intermediate Listening (LIS)

For B2 students who can:

- understand somewhat technical contents in a long conversation or a lecture within their field of specialty;
- understand news, broadcasts, current events or movies;
- infer the meaning of an unfamiliar word.

Japanese Upper-intermediate Writing (WRT)

For B2 students who can:

- write a report relating to their field of specialty;
- write an article or a report given enough time;
- distinguish fact from their own opinion;
- create paragraphs while considering essay structure;
- write a cohesive text.

Japanese Upper-intermediate Speaking (SPK)

For B2 students who can:

- present a speech about their field of specialty clearly and in detail;
- present their research findings with enough preparation;
- distinguish fact from their own opinion;
- actively engage in a conversation;
- speak fluently to a certain extent.

Japanese Upper-intermediate Grammar & Vocabulary (GV)

For B2 students who can:

- understand fundamental vocabulary relating to their field of specialty;
- understand expressions using somewhat high-level sentence patterns.

Japanese Upper-intermediate Kanji & Vocabulary (KV)

For B2 students who can:

- read and write somewhat high-level commonly-used kanji;
- understand commonly-used kanji expressions in addition to somewhat high-level kanji expressions within their field of specialty.

Japanese Advanced Reading (RDG)

For C1 students who can:

- understand texts from various fields written in standard Japanese;
- understand an introductory book even if it is not of their field of specialty;
- understand a technical book, an article or lecture material of a high level if it is of their field of specialty;
- understand the part of a text emphasized by the author.

Japanese Advanced Listening (LIS)

For C1 students who can:

- understand topics from various fields spoken in standard Japanese;
- understand a basic-level lecture even if it is not of their field of specialty;
- understand a higher-level lecture of their field of specialty;
- enjoy most TV programs or movies without any special effort;
- grasp the flow of a conversation with more than three participants.

Japanese Advanced Writing (WRT)

For C1 students who can:

- write a somewhat technical article or report about subjects from various fields;
- write a cohesive text;
- put an emphasis on their opinion in the text.

Japanese Advanced Speaking (SPK)

For C1 students who can:

- present a speech containing somewhat technical content about subjects from various fields;
- coherently present an argument from a single perspective;
- participate in conversations while cooperating with other participants;
- express themselves fluently.

Japanese Advanced Grammar & Vocabulary (GV)

For C1 students who:

- understand fundamental vocabulary within a variety of fields;
- understand the highest level sentence patterns necessary for any social situation.

Japanese Advanced Kanji & Vocabulary (KV)

For C1 students who:

- read and write almost all kanji used in daily life;
- understand almost all kanji expressions necessary for conducting any social situation;
- understand higher-level kanji expressions if it is of their field of specialty.

② **【Research Subjects】**

These subjects offer students the opportunity to pursue academic knowledge in their field. Through language and language education, as well as the study of literature, history, sociology and Japanese thought, students acquire a contrastive perspective of Japanese culture and discuss content learned in class. Classes are conducted in Japanese, with some classes conducted in English.

The following classes are offered: Japanese Linguistics, Japanese Language Education, Japanese Thought, Japanese History, Japanese Literature, Japanese Contemporary Culture, and Japanese Social Sciences.

For each Research Subject, there is an introductory course (“Introduction to XX”) that provides foundational knowledge in the subject concerned while taking into consideration students’ practical ability.

Japanese Linguistics (LIN)

Students analyze various characteristics of the Japanese language from a linguistic perspective. This involves the subfields of phonetics and phonology, morphology and syntax, pragmatics and semantics, typology, contrastive linguistics, social linguistics, and the history of Japanese.

Japanese Language Education (EDU)

This subject provides students with the requisite knowledge and perspective used in examining various aspects of Japanese language education. This includes basic knowledge of Japanese language education, second language acquisition and language pedagogy. Students learn to apply knowledge from related fields such as linguistics and Japanese linguistics in order to deepen their understanding of language education.

Japanese Thought (THO)

This subject examines Japanese thought through disciplines such as religious studies, folkloristics, and cultural anthropology. Students investigate Japanese culture and society from a historical perspective, looking closely at aspects of traditional Japanese culture such as annual festivals and functions.

Japanese History (HIS)

This subject teaches Japanese history spanning from ancient to modern times. Students explore topics in Japanese society and Japanese culture through the lens of Japanese history. This includes cultural history, as well as practices like Japanese calligraphy and tea ceremony.

Japanese Literature (LIT)

This subject teaches Japanese classical literature, dating from the Nara period to the Edo period, as well as modern and contemporary literature, written from the Meiji period onward. This subject deals also with literary history and criticism, as well as traditional Japanese performing arts.

Japanese Contemporary Culture (CON)

This subject teaches contemporary and modern Japanese culture as well as research methodology. Students familiarize themselves with cultural characteristics, historical trends and current problems facing Japanese society. Knowledge of research methods used in sociology and comparative culture deepens students' understanding of cultural research.

Japanese Social Sciences (SOC)

This subject examines Japanese society from a sociological perspective, considering politics, economics and management, including discussion of international relations. Students deepen their understanding of Japanese society through investigations of current affairs and historical analyses.

③ 【Independent Study】 (MIS)

In Independent Study, students read and interpret primary sources they have gathered in Japan and conduct investigative research. Students acquire deeper knowledge of Japanese language and culture through self-directed data collection and analysis, under the guidance and instruction of a supervisor. In order to enroll in the course, students must pass a review based on document submission and an interview exam.

④ 【Multicultural Community Cohesion Subject】 (MCC)

This subject seeks to strengthen exchanges between students and local residents through participation in community development initiatives (まちづくり) alongside local partners, with the objective of realizing a multicultural and cohesive society. The students will plan and manage exchange activities aimed at understanding and accepting the diverse people living in the area, while also building the community together.

This is a term subject designed so that the learning process is completed by enrolling in both the “Multicultural Community Cohesion (Winter)” intensive course in the winter term and the “Multicultural Community Cohesion (Spring)” course in the spring term.

4. Extracurricular Activities

To improve students' Japanese language skills and to deepen their understanding of Japanese language, culture and society, the CJLC plans various activities on and off campus.

- (1) As part of Directed Research and Reading, educational field trips are scheduled for locations in the vicinity. These trips are intended to provide students with an immersive experience of Japanese society and culture.
- (2) The CJLC plans tours of places of interest for students to help them better understand Japanese history, folklore, economy and business management.
- (3) The CJLC also offers opportunities to view Japanese traditional performing arts, such as *kabuki* and *bunraku*, in order to help students deepen their understanding of Japanese art and culture.
- (4) Students enrolled in the “Multicultural Community Cohesion” Subject can participate in planning and managing “No Border Fest in Minoh”, an event organized in collaboration with the community with the objective of strengthening exchanges with local residents.
- (5) To experience the culture of Japanese daily life, students may participate in the host family program and other events organized or introduced by The University of Osaka Center for International Education and Exchange (5th floor, Minoh Campus).

※ Various activities are organized in addition to those listed above. Detailed information will be posted on the bulletin board near the CJLC Office or CJLC Library Room.

授 業 一 覧

List of Classes

※授業の詳しい内容は KOAN を見てください。
See KOAN for details of each subject.

M Code	J Code	Category	Day・Period	Program	Level	Type	種別	授業科目名	Instructor(s)	教員	サブタイトル／授業テーマ
J/M/O (A2) Japanese Language Subjects 日本語実習科目											
1	390020	—	GV	Tue. 2	J/M/O	A2	実習	日本語初中級文法・語彙 (春夏)	DUONG.T	ズオン, T.	基本文型の整理と完成
J/M/O (B1) Japanese Language Subjects 日本語実習科目											
2	390010	39J101	RDG	Wed. 1	J/M/O	B1	実習	日本語中級読解 (春夏)	MATSUZAKI	松崎かおり	速読の練習
3	390011	39J103	RDG	Fri. 1	J/M/O	B1	実習	日本語中級読解 (春夏)	JIN	金珠	音読と理解の発展練習
4	390015	39J201	LIS	Mon. 3	J/M/O	B1	実習	日本語中級聴解 (春夏)	KYOTANI	京谷麻矢	フォーマール・カジュアルな場における対話の聴解
5	390016	39J203	LIS	Wed. 2	J/M/O	B1	実習	日本語中級聴解 (春夏)	HATANO	波多野吉徳	身の回りの日本語を聞く
6	390021	39J301	WRT	Thu. 3	J/M/O	B1	実習	日本語中級文章表現 (春夏)	NAMBA	南場尚子	まとまりのある文章を書く
7	390025	39J401	SPK	Wed. 3	J/M/O	B1	実習	日本語中級口頭表現 (春夏)	MIYAZAKI	宮崎さとみ	交渉会話・交流会話
8	390026	39J403	SPK	Thu. 4	J/M/O	B1	実習	日本語中級口頭表現 (春夏)	KAI	甲斐朋子	描写・説明
9	390030	39J501	GV	Wed. 4	J/M/O	B1	実習	日本語中級文法・語彙 (春夏)	DUONG.T	ズオン, T.	類似表現の整理と使い分け
10	390031	39J503	GV	Thu. 5	J/M/O	B1	実習	日本語中級文法・語彙 (春夏)	KIM	金吉任	類似表現の整理と使い分け
11	390040	39J601	KV	Tue. 1	J/M/O	B1	実習	日本語中級漢字・語彙 (春夏)	DUONG.T	ズオン, T.	語構成から学ぶ漢語
12	390041	39J603	KV	Wed. 5	J/M/O	B1	実習	日本語中級漢字・語彙 (春夏)	WADA	和田亜矢子	漢語と和語での類義表現
13	390042	39J605	KV	Fri. 3	J/M/O	B1	実習	日本語中級漢字・語彙 (春夏)	SHIMOMURA	下村未有美	大学生活に必要な漢字語彙
J/M/O (B2) Japanese Language Subjects 日本語実習科目											
14	390045	39J121	RDG	Mon. 2	J/M/O	B2	実習	日本語中上級読解 (春夏)	MATSUSHIMA	松島弘枝	専門性のある文章の読解
15	390046	39J123	RDG	Thu. 1	J/M/O	B2	実習	日本語中上級読解 (春夏)	TANAKA.S.	田中里美	日本語・日本文化を題材とした文章の読解
16	390047	39J125	RDG	Thu. 4	J/M/O	B2	実習	日本語中上級読解 (春夏)	UEDA. A.	上田安希子	現代社会に関連した文章の読解
17	390048	39J127	RDG	Fri. 1	J/M/O	B2	実習	日本語中上級読解 (春夏)	SHINJO	新庄あいみ	概説等学習用書籍の速読ストラテジー
18	390055	39J221	LIS	Mon. 2	J/M/O	B2	実習	日本語中上級聴解 (春夏)	FUJIMOTO	藤本憲志	日本社会を題材とした独話・対話の聴解
19	390056	39J223	LIS	Tue. 1	J/M/O	B2	実習	日本語中上級聴解 (春夏)	KIDA	木田則子	複数人の会話を聞く技術
20	390057	39J225	LIS	Thu. 2	J/M/O	B2	実習	日本語中上級聴解 (春夏)	NAMBA	南場尚子	複数人の会話を聞く技術
21	390058	39J227	LIS	Thu. 5	J/M/O	B2	実習	日本語中上級聴解 (春夏)	OKUNO	奥野紗衣	日常的な話題・場面の対話や独話の聴解
22	390065	39J321	WRT	Mon. 1	J/M/O	B2	実習	日本語中上級文章表現 (春夏)	FUJIMOTO	藤本憲志	様々な文書作成の基本
23	390066	39J323	WRT	Wed. 1	J/M/O	B2	実習	日本語中上級文章表現 (春夏)	KITAGAWA	北川美香	自然な日本語を書くためのトレーニング
24	390067	39J325	WRT	Wed. 4	J/M/O	B2	実習	日本語中上級文章表現 (春夏)	HIROKAWA	廣川直幸	様々な文書作成の基本
25	390068	39J327	WRT	Thu. 2	J/M/O	B2	実習	日本語中上級文章表現 (春夏)	NONAKA	野中篤	レポート・小論文の日本語
26	390075	39J421	SPK	Mon. 1	J/M/O	B2	実習	日本語中上級口頭表現 (春夏)	MATSUSHIMA	松島弘枝	交渉会話
27	390076	39J423	SPK	Wed. 2	J/M/O	B2	実習	日本語中上級口頭表現 (春夏)	TANAKA. M.	田中舞	描写・説明
28	390077	39J425	SPK	Thu. 3	J/M/O	B2	実習	日本語中上級口頭表現 (春夏)	TANAKA. MA.	田中真衣	関係構築のための日本語会話
29	390078	39J427	SPK	Fri. 2	J/M/O	B2	実習	日本語中上級口頭表現 (春夏)	MATSUZAKI	松崎かおり	スピーチ／プレゼンテーション
30	390085	39J521	GV	Tue. 2	J/M/O	B2	実習	日本語中上級文法・語彙 (春夏)	KASAMATSU	笠松瑞子	日本事情から見える言葉
31	390086	39J523	GV	Wed. 2	J/M/O	B2	実習	日本語中上級文法・語彙 (春夏)	UEDA. M.	植田みのり	文体によって異なる表現形式
32	390087	39J525	GV	Wed. 3	J/M/O	B2	実習	日本語中上級文法・語彙 (春夏)	HATANO	波多野吉徳	類義表現と言い換え
33	390088	39J527	GV	Thu. 3	J/M/O	B2	実習	日本語中上級文法・語彙 (春夏)	KOZAKURA	小椋真未	学術的な場面に見える表現形式
34	390095	39J621	KV	Mon. 3	J/M/O	B2	実習	日本語中上級漢字・語彙 (春夏)	ABE	安部陽子	慣用表現で学ぶ漢字語彙
35	390096	39J623	KV	Wed. 1	J/M/O	B2	実習	日本語中上級漢字・語彙 (春夏)	AKIYAMA	秋山麻衣耶	理解語彙を増やすためのストラテジー
36	390097	39J625	KV	Thu. 1	J/M/O	B2	実習	日本語中上級漢字・語彙 (春夏)	YAMAZAWA	山澤園子	同音異字語
37	390098	39J627	KV	Fri. 2	J/M/O	B2	実習	日本語中上級漢字・語彙 (春夏)	FURUTA	古田朋子	漢語と和語での類義表現

J/M/O (C1) Japanese Language Subjects 日本語実習科目												
		RDG	Tue. 2	J/M/O	C1	Rec.	実習	日本語上級読解(春夏)	NAKATA	中田一志	日本語学の文章の読解	
38	390103	39J141					実習	日本語上級読解(春夏)			日本語学の文章の読解	
39	390104	39J143	Wed. 5	J/M/O	C1	Rec.	実習	日本語上級読解(春夏)	HIROKAWA	廣川直幸	比較文学の読解の練習	
40	390105	39J145	Thu. 1	J/M/O	C1	Rec.	実習	日本語上級読解(春夏)	NONAKA	野中寛	異文化比較・異言語比較に関する読解	
41	390106	39J147	Fri. 1	J/M/O	C1	Rec.	実習	日本語上級読解(春夏)	FURUTA	古田朋子	専門性のある文章の読解	
42	390107	39J149	Fri. 4	J/M/O	C1	Rec.	実習	日本語上級読解(春夏)	ATARASHI	新聖子	クリティカルリーディング	
43	390110	39J241	Mon. 3	J/M/O	C1	Rec.	実習	日本語上級読解(春夏)	CHIDA	千田愛	日本語・日本文化を題材とした対話や独話の聴解	
44	390111	39J243	Tue. 1	J/M/O	C1	Rec.	実習	日本語上級読解(春夏)	FURUKAWA	古川由理子	日本社会を題材とした独話・対話の聴解	
45	390112	39J245	LIS Wed. 1	J/M/O	C1	Rec.	実習	日本語上級読解(春夏)	TANAKA, M.	田中舞	日本語・日本文化を題材とした対話や独話の聴解	
46	390113	39J247	LIS Wed. 3	J/M/O	C1	Rec.	実習	日本語上級読解(春夏)	IWAI, Y.	岩井康雄	複数人の会話を聞く技術	
47	390114	39J249	LIS Thu. 5	J/M/O	C1	Rec.	実習	日本語上級読解(春夏)	MURATA, K.	村田幸一	時事的な話題の独話・対話の詳細な聴解	
48	390121	39J341	WRT Mon. 4	J/M/O	C1	Rec.	実習	日本語上級文章表現(春夏)	BABA	馬場裕子	学術的な文章を書くために必要なこと	
49	390122	39J343	WRT Wed. 2	J/M/O	C1	Rec.	実習	日本語上級文章表現(春夏)	OZAWA	小澤智恵子	多様な場面における文書作成	
50	390123	39J345	WRT Thu. 2	J/M/O	C1	Rec.	実習	日本語上級文章表現(春夏)	TANAKA, S.	田中里美	小論文・レポート作成の技法	
51	390124	39J347	WRT Thu. 3	J/M/O	C1	Rec.	実習	日本語上級文章表現(春夏)	YAMAMOTO, K.	山本一也	映像を見て、文章を書く	
52	390125	39J349	WRT Fri. 2	J/M/O	C1	Rec.	実習	日本語上級文章表現(春夏)	SUZUKI, Y.	鈴木由香里	書くために必要なこと	
53	390130	39J441	SPK Mon. 1	J/M/O	C1	Rec.	実習	日本語上級口頭表現(春夏)	TANAKA, Y.	田中泰子	ビジネス・コミュニケーション	
54	390131	39J443	SPK Mon. 3	J/M/O	C1	Rec.	実習	日本語上級口頭表現(春夏)	ISHIBASHI	石橋玲央	交渉会話	
55	390132	39J445	SPK Tue. 2	J/M/O	C1	Rec.	実習	日本語上級口頭表現(春夏)	UEDA, M.	植田みのり	議論	
56	390133	39J447	SPK Thu. 2	J/M/O	C1	Rec.	実習	日本語上級口頭表現(春夏)	HATANO	波多野吉徳	議論	
57	390134	39J449	SPK Thu. 5	J/M/O	C1	Rec.	実習	日本語上級口頭表現(春夏)	ATSUTA	熱田万美	ビジネス・コミュニケーション	
58	390135	39J451	SPK Fri. 3	J/M/O	C1	Rec.	実習	日本語上級口頭表現(春夏)	FUJII, M.	藤井みゆき	議論	
59	390140	39J541	GV Mon. 2	J/M/O	C1	Rec.	実習	日本語上級文法・語彙(春夏)	KISHIDA	岸田泰浩	関西弁の文法	
60	390141	39J543	GV Mon. 5	J/M/O	C1	Rec.	実習	日本語上級文法・語彙(春夏)	KAWASHIMA	川島信恵	名言・名句	
61	390142	39J545	GV Wed. 4	J/M/O	C1	Rec.	実習	日本語上級文法・語彙(春夏)	NAKATA	中田一志	日本事情から見える言葉	
62	390143	39J547	GV Thu. 1	J/M/O	C1	Rec.	実習	日本語上級文法・語彙(春夏)	FUJII, C.	藤井千枝	名言・名句	
63	390144	39J549	GV Thu. 4	J/M/O	C1	Rec.	実習	日本語上級文法・語彙(春夏)	ATSUTA	熱田万美	役割語	
64	390145	39J551	GV Fri. 1	J/M/O	C1	Rec.	実習	日本語上級文法・語彙(春夏)	FURUKAWA	古川由理子	文体によって異なる表現形式	
65	390150	39J641	KV Mon. 1	J/M/O	C1	Rec.	実習	日本語上級漢字・語彙(春夏)	CHIDA	千田愛	新聞で用いられる漢語	
66	390151	39J643	KV Mon. 4	J/M/O	C1	Rec.	実習	日本語上級漢字・語彙(春夏)	KAWASHIMA	川島信恵	四字熟語	
67	390153	39J647	KV Tue. 1	J/M/O	C1	Rec.	実習	日本語上級漢字・語彙(春夏)	KASAMATSU	笠松瑞子	同音異字語	
68	390154	39J649	KV Wed. 1	J/M/O	C1	Rec.	実習	日本語上級漢字・語彙(春夏)	OZAWA	小澤智恵子	理解語彙を増やすためのストラテジー	
69	390155	39J651	KV Wed. 3	J/M/O	C1	Rec.	実習	日本語上級漢字・語彙(春夏)	KOGA	古賀静香	漢語の類義表現	
70	390156	39J653	KV Thu. 3	J/M/O	C1	Rec.	実習	日本語上級漢字・語彙(春夏)	MITO	三登由利子	漢字で読み解く日本	

J/M/O (B2) Research Subjects 研究 科 目												
71	390166	39JN01	LIN	Mon. 5	J/M/O	B2	Lec./Sem.	講義/演習	日本語学研究基礎(春夏)1	IMAI	今井忍	意味論
72	390168	39JN03	LIN	Wed. 4	J/M/O	B2	Lec./Sem.	講義/演習	日本語学研究基礎(春夏)2	IWAI Y.	岩井康雄	言語学概論
73	390240	39JE01	EDU	Wed. 5	J/M/O	B2	Lec./Sem.	講義/演習	日本語教育学研究基礎(春夏)1	KOMORI	小森万里	日本語教育学概論
74	390241	39JE03	EDU	Fri. 3	J/M/O	B2	Lec./Sem.	講義/演習	日本語教育学研究基礎(春夏)2	SUZUKI, Y.	鈴木由香里	文法・語彙の指導
75	390185	39JT99	THO	Tue. 1	J/M/O	B2	Lec./Sem.	講義/演習	日本思想文化学研究基礎(春夏)1	SHIBATA etc.	柴田芳成ほか	日本文化入門
76	390186	39JT01	THO	Tue. 2	J/M/O	B2	Lec./Sem.	講義/演習	日本思想文化学研究基礎(春夏)2	MATSUMURA	松村薫子	日本民俗文化論
77	390187	39JT03	THO	Fri. 4	J/M/O	B2	Lec./Sem.	講義/演習	日本思想文化学研究基礎(春夏)3	ONISHI	大西薫	日本宗教文化論
78	390191	39JH01	HIS	Mon. 3	J/M/O	B2	Lec./Sem.	講義/演習	日本歴史文化学研究基礎(春夏)2	HISAOKA	久岡明穂	茶道
79	390192	39JH03	HIS	Mon. 5	J/M/O	B2	Lec./Sem.	講義/演習	日本歴史文化学研究基礎(春夏)3	FUKUMITSU	福光由布	書道
80	390193	39JH05	HIS	Wed. 3	J/M/O	B2	Lec./Sem.	講義/演習	日本歴史文化学研究基礎(春夏)4	SANO. M.	佐野方郁	日本史入門
81	390194	39JH07	HIS	Thu. 4	J/M/O	B2	Lec./Sem.	講義/演習	日本歴史文化学研究基礎(春夏)5	INOMO	井面舞	日本美術史
82	390195	39JH09	HIS	Fri. 1	J/M/O	B2	Lec./Sem.	講義/演習	日本歴史文化学研究基礎(春夏)6	SATO, S.	佐藤早紀子	日本文化史入門
83	390296	39JH11	HIS	Fri. 3	J/M/O	B2	Lec./Sem.	講義/演習	日本歴史文化学研究基礎(春夏)7	INOUE	井上徳子	東西交渉史
84	390205	39JL99	LIT	Mon. 3	J/M/O	B2	Lec./Sem.	講義/演習	日本文献文化学研究基礎(春夏)1	GONOJI	五之治昌比呂	日本近現代文学
85	390206	39JL01	LIT	Mon. 4	J/M/O	B2	Lec./Sem.	講義/演習	日本文献文化学研究基礎(春夏)2	HISAOKA	久岡明穂	日本近現代文学
86	390207	39JL03	LIT	Fri. 4	J/M/O	B2	Lec./Sem.	講義/演習	日本文献文化学研究基礎(春夏)3	SHIBATA	柴田芳成	日本古典芸能
87	390227	39JC03	CON	Mon. 5	J/M/O	B2	Lec./Sem.	講義/演習	日本近現代文化学研究基礎(春夏)3	TSUNODA	角田燎	社会学
88	390228	39JC05	CON	Wed. 5	J/M/O	B2	Lec./Sem.	講義/演習	日本近現代文化学研究基礎(春夏)4	IWAI S.	岩井茂樹	比較文化学
89	390229	39JC07	CON	Thu. 4	J/M/O	B2	Lec./Sem.	講義/演習	日本近現代文化学研究基礎(春夏)5	KOBAYASHI, S.	小林翔	マンガ・アニメ学
90	390430	39JC09	CON	Thu. 5	J/M/O	B2	Lec./Sem.	講義/演習	日本近現代文化学研究基礎(春夏)6	PENG	彭永成	日本のメディア文化
91	390235	39JS11	SOC	Mon. 4	J/M/O	B2	Lec./Sem.	講義/演習	日本社会文化学研究基礎(春夏)1	HAYASHI, H.	林光	日本政治学

J/M/O (C1) Research Subjects 研究 科 目												
92	390160	39JN21	LIN	Mon. 4	J/M/O	C1	Lec./Sem.	講義/演習	日本語学研究(春夏)1	YAMAKAWA	山川太	統語論
93	390161	39JN23	LIN	Wed. 3	J/M/O	C1	Lec./Sem.	講義/演習	日本語学研究(春夏)2	NAKATA	中田一志	語用論
94	390162	39JN25	LIN	Wed. 5	J/M/O	C1	Lec./Sem.	講義/演習	日本語学研究(春夏)3	SHOJI	莊司育子	形態論
95	390180	39JT21	THO	Mon. 1	J/M/O	C1	Lec./Sem.	講義/演習	日本思想文化学研究(春夏)1	MOTOBAYASHI	本林靖久	日本民俗文化論
96	390181	39JT23	THO	Fri. 3	J/M/O	C1	Lec./Sem.	講義/演習	日本思想文化学研究(春夏)2	WATANABE.C.	渡邊親文	日本宗教思想論
97	390196	39JH21	HIS	Wed. 4	J/M/O	C1	Lec./Sem.	講義/演習	日本歴史文化学研究(春夏)1	SANO, M.	佐野方郁	日本現代史
98	390197	39JH23	HIS	Thu. 1	J/M/O	C1	Lec./Sem.	講義/演習	日本歴史文化学研究(春夏)2	TAIRA	平良聡弘	日本近代史
99	390198	39JH25	HIS	Thu. 3	J/M/O	C1	Lec./Sem.	講義/演習	日本歴史文化学研究(春夏)3	INOMO	井面舞	日本美術史
100	390199	39JH27	HIS	Thu. 4	J/M/O	C1	Lec./Sem.	講義/演習	日本歴史文化学研究(春夏)4	YAMAMOTO.K.	山本一也	日本中世史
101	390300	39JH29	HIS	Fri. 4	J/M/O	C1	Lec./Sem.	講義/演習	日本歴史文化学研究(春夏)5	KOYAMA	小山有子	日本美術史
102	390200	39JL21	LIT	Mon. 5	J/M/O	C1	Lec./Sem.	講義/演習	日本文献文化学研究(春夏)1	MIZUNO	水野亜紀子	日本近現代文学
103	390201	39JL23	LIT	Fri. 2	J/M/O	C1	Lec./Sem.	講義/演習	日本文献文化学研究(春夏)2	SATO, S.	佐藤早紀子	日本古典文法
104	390202	39JL25	LIT	Fri. 3	J/M/O	C1	Lec./Sem.	講義/演習	日本文献文化学研究(春夏)3	SHIBATA	柴田芳成	日本古典文学
105	390220	39JC21	CON	Mon. 2	J/M/O	C1	Lec./Sem.	講義/演習	日本近現代文化学研究(春夏)1	MOTOBAYASHI	本林靖久	日本現代社会
106	390221	39JC23	CON	Wed. 1	J/M/O	C1	Lec./Sem.	講義/演習	日本近現代文化学研究(春夏)2	BEREZIKOVA	ベレジコワ, T.	日本近現代文化史
107	390222	39JC25	CON	Fri. 3	J/M/O	C1	Lec./Sem.	講義/演習	日本近現代文化学研究(春夏)3	KOYAMA	小山有子	女性学
108	390230	39JS21	SOC	Wed. 2	J/M/O	C1	Lec./Sem.	講義/演習	日本社会文化学研究(春夏)1	IMURA	井村美根	日本経営学
109	390231	39JS23	SOC	Fri. 4	J/M/O	C1	Lec./Sem.	講義/演習	日本社会文化学研究(春夏)2	ITO	伊藤敏雄	日本経済学

J (B2) Japanese Language Subjects 日本語実習科目 (JWRT)												
		JWRT	Mon. 2	J	B2	Rec.	実習	日本語中上級文章表現 (春夏)	CHIDA	千田愛	修了論文・修了レポート作成の指導補助	
110	—	39J001	Mon. 3	J	B2	Rec.	実習	日本語中上級文章表現 (春夏)	KANEDA	金田英里	修了論文・修了レポート作成の指導補助	
111	—	39J002	Mon. 3	J	B2	Rec.	実習	日本語中上級文章表現 (春夏)	TANAKA, Y.	田中泰子	修了論文・修了レポート作成の指導補助	
112	—	39J003	Tue. 2	J	B2	Rec.	実習	日本語中上級文章表現 (春夏)	KIDA	木田則子	修了論文・修了レポート作成の指導補助	
113	—	39J004	Tue. 2	J	B2	Rec.	実習	日本語中上級文章表現 (春夏)	FURUKAWA	古川由理子	修了論文・修了レポート作成の指導補助	
114	—	39J005	Wed. 2	J	B2	Rec.	実習	日本語中上級文章表現 (春夏)	AKIYAMA	秋山麻衣耶	修了論文・修了レポート作成の指導補助	
115	—	39J006	Wed. 3	J	B2	Rec.	実習	日本語中上級文章表現 (春夏)	UEDA, M.	植田みのり	修了論文・修了レポート作成の指導補助	
116	—	39J007	Wed. 3	J	B2	Rec.	実習	日本語中上級文章表現 (春夏)	KYOTANI	京谷麻矢	修了論文・修了レポート作成の指導補助	
117	—	39J008	Wed. 4	J	B2	Rec.	実習	日本語中上級文章表現 (春夏)	WADA	和田亜矢子	修了論文・修了レポート作成の指導補助	
118	—	39J009	Thu. 2	J	B2	Rec.	実習	日本語中上級文章表現 (春夏)	TANAKA, MA.	田中真衣	修了論文・修了レポート作成の指導補助	
119	—	39J010	Thu. 3	J	B2	Rec.	実習	日本語中上級文章表現 (春夏)	FUKUTOMI	福富奈美	修了論文・修了レポート作成の指導補助	
120	—	39J011	Thu. 3	J	B2	Rec.	実習	日本語中上級文章表現 (春夏)	MASHITA	真下恭子	修了論文・修了レポート作成の指導補助	
121	—	39J012	Thu. 3	J	B2	Rec.	実習	日本語中上級文章表現 (春夏)	FUJII, C.	藤井千枝	修了論文・修了レポート作成の指導補助	
122	—	39J017	Thu. 4	J	B2	Rec.	実習	日本語中上級文章表現 (春夏)	OKUNO	奥野紗衣	修了論文・修了レポート作成の指導補助	
123	—	39J013	Fri. 2	J	B2	Rec.	実習	日本語中上級文章表現 (春夏)	SHINJO	新庄あいみ	修了論文・修了レポート作成の指導補助	
124	—	39J014	Fri. 3	J	B2	Rec.	実習	日本語中上級文章表現 (春夏)	ATARASHI	新聖子	修了論文・修了レポート作成の指導補助	
125	—	39J015	Fri. 3	J	B2	Rec.	実習	日本語中上級文章表現 (春夏)	HIGUCHI	樋口尊子	修了論文・修了レポート作成の指導補助	
126	—	39J016	Fri. 3	J	B2	Rec.	実習	日本語中上級文章表現 (春夏)	FURUTA	古田阴子	修了論文・修了レポート作成の指導補助	
127	—	39J018	Fri. 3	J	B2	Rec.	実習	日本語中上級文章表現 (春夏)	Directed Research & Reading Subjects 日本語・日本文化研究 / 研修指導 (JDR)			
128	—	39J020	Tue. 3	J	—	Sem.	演習	日本語・日本文化研究指導 (春夏)	IWAI, Y.	岩井康雄	—	
129	—	39J021	Tue. 3	J	—	Sem.	演習	日本語・日本文化研究指導 (春夏)	GONOJI	五之治昌比呂	—	
130	—	39J022	Tue. 3	J	—	Sem.	演習	日本語・日本文化研究指導 (春夏)	SHOJI	莊司宵子	—	
131	—	39J023	Tue. 3	J	—	Sem.	演習	日本語・日本文化研究指導 (春夏)	NAKATA	中田一志	—	
132	—	39J024	Tue. 3	J	—	Sem.	演習	日本語・日本文化研究指導 (春夏)	MURATAM.	村田真実	—	
133	—	39J037	Tue. 3	J	—	Sem.	演習	日本語・日本文化研修指導 (春夏)	SHIBATA	柴田芳成	—	
134	—	39J038	Tue. 3	J	—	Sem.	演習	日本語・日本文化研修指導 (春夏)	MIZUNO	水野亜紀子	—	
135	—	39J025	Tue. 4	J	—	Sem.	演習	日本語・日本文化研究指導 (春夏)	IWAI, S.	岩井茂樹	—	
136	—	39J026	Tue. 4	J	—	Sem.	演習	日本語・日本文化研究指導 (春夏)	GONOJI	五之治昌比呂	—	
137	—	39J027	Tue. 4	J	—	Sem.	演習	日本語・日本文化研究指導 (春夏)	KOMORI	小森万里	—	
138	—	39J028	Tue. 4	J	—	Sem.	演習	日本語・日本文化研究指導 (春夏)	SANO, M.	佐野方郁	—	
139	—	39J029	Tue. 4	J	—	Sem.	演習	日本語・日本文化研究指導 (春夏)	SHIBATA	柴田芳成	—	
140	—	39J030	Tue. 4	J	—	Sem.	演習	日本語・日本文化研究指導 (春夏)	TAKAI	高井美穂	—	
141	—	39J031	Tue. 4	J	—	Sem.	演習	日本語・日本文化研究指導 (春夏)	MIZUNO	水野亜紀子	—	
142	—	39J032	Tue. 4	J	—	Sem.	演習	日本語・日本文化研究指導 (春夏)	MURATAM.	村田真実	—	
143	—	39J033	Tue. 5	J	—	Sem.	演習	日本語・日本文化研究指導 (春夏)	FUJHIRA	藤平愛美	—	
144	—	39J034	Tue. 5	J	—	Sem.	演習	日本語・日本文化研究指導 (春夏)	MATSUMURA	松村薫子	—	
145	—	39J035	Tue. 5	J	—	Sem.	演習	日本語・日本文化研究指導 (春夏)	YAMAKAWA	山川太	—	
146	—	39J039	Tue. 5	J	—	Sem.	演習	日本語・日本文化研修指導 (春夏)	IMAI	今井忍	—	
147	—	39J040	Tue. 5	J	—	Sem.	演習	日本語・日本文化研修指導 (春夏)	MATSUURA	松浦幸祐	—	

M (B1) Japanese Language Subjects 日本語実習科目 (MGV)													
			MGV α 1	Mon. 2	M	B1	Rec.	実習		TANAKA, Y.	田中泰子	—	
148	390001	—							現代日本語中級文法・語彙 α (春夏)	TAKAI	高井美穂	—	
149	390001	—		Tue. 2	M	B1	Rec.	実習			FUJII.C.	藤井千枝	—
150	390001	—		Thu. 2	M	B1	Rec.	実習			HIGUCHI	樋口尊子	—
151	390001	—		Fri. 2	M	B1	Rec.	実習			KYOTANI	京谷麻矢	—
152	390002	—		Mon. 2	M	B1	Rec.	実習	現代日本語中級文法・語彙 α (春夏)	MATSUOKA	松岡里奈	—	
153	390002	—		Tue. 2	M	B1	Rec.	実習			KOZAKURA	小桜真未	—
154	390002	—		Thu. 2	M	B1	Rec.	実習			FUJII.M.	藤井みゆき	—
155	390002	—		Fri. 2	M	B1	Rec.	実習			Directed Research and Reading Subjects 日本語日本文化専門演習 (MDR)		
156	390260	—		MDR	Tue. 3	M	Sem.	演習	日本語日本文化専門演習 (春夏)	IWAI, S.	岩井茂樹	—	
157	390261	—		MDR	Tue. 3	M	Sem.	演習	日本語日本文化専門演習 (春夏)	KOMORI	小森万里	—	
158	390262	—		MDR	Tue. 3	M	Sem.	演習	日本語日本文化専門演習 (春夏)	SHIMOMURA CIOLCA, R.	下村朱有美 チヨルカ, R.	—	
159	390263	—		MDR	Tue. 3	M	Sem.	演習	日本語日本文化専門演習 (春夏)	TAKAI	高井美穂	—	
160	390264	—		MDR	Tue. 3	M	Sem.	演習	日本語日本文化専門演習 (春夏)	MATSUOKA	松岡里奈		
Independent Studies Subjects 自主研究科目 (MIS)													
161	390250	—		MIS	Tue. 5	M	Sem.	演習	自主研究 (春夏)	IWAI, S.	岩井茂樹	—	
162	390251	—		MIS	Tue. 5	M	Sem.	演習	自主研究 (春夏)	GONOJI	五之治昌比呂	—	
163	390252	—		MIS	Tue. 5	M	Sem.	演習	自主研究 (春夏)	MURATA.M.	村田真実	—	
M/O (—) Research Subjects in English 英語による研究科目													
164	390190	—		HIS	Mon. 4	M/O	Lec./Sem.	講義/演習	日本歴史文化研究基礎 (春夏)1	FUKUMITSU	福光由布	書道	
165	390225	—		CON	Wed. 2	M/O	Lec./Sem.	講義/演習	日本近現代文化研究基礎 (春夏)1	LUKMINAITES.	ルクミナイテ, S.	日本現代社会	
166	390226	—		CON	Fri. 4	M/O	Lec./Sem.	講義/演習	日本近現代文化研究基礎 (春夏)2	WATANABE.C.	渡邊朝文	日本現代社会	

春学期開講科目 Spring Term Courses

J/M (—) Research Subjects 多文化・地域共生 (MCC) * 冬学期の「多文化・地域共生 (冬) 」と合わせて履修することがぞましい											
167	390M01	39JM01	MCC	Fri. 5	J/M	—	演習	多文化・地域共生 (春)	KOMORI	小森万里	—
168	390M02	39JM03	MCC	Fri. 5	J/M	—	演習	多文化・地域共生 (春)	SANO, M.	佐野方都	—
169	390M03	39JM05	MCC	Fri. 5	J/M	—	演習	多文化・地域共生 (春)	SHOJI	荘司育子	—

じ かん わり
時 間 割
Weekly Schedule

令和7年度春～夏学期時間割表

[illegible]

Spring and Summer Terms, 2025

Monday			Tuesday			Wednesday			Thursday			Friday		
Rq	U1	UJPN KANEDA	Rq	U1	UJPN KONDO	Rq	U	UJPN INUI	Rq	U1	UJPN KAN	Rq	U	UJPN HIBI
Rq	U2	UJPN SHIMA	Rq	U2	UJPN KOBAYASHI, K.	Rq	U	UJPN HAYASHI, KA.	Rq	U2	UJPN MASHITA	Rq	U	UJPN YAMAMOTO
Rq	U3	UJPN MIYAZAKI	Rq	U3	UJPN FUKUSHIMA	Rq	U4	UJPN YAMAZAWA	Rq	U3	UJPN NAKAMURA	Rq	U4	UJPN FUJIMOTO
Rq	U4	UJPN ISHIBASHI	Rq	U4	UJPN SAITO	Rq	U5	UJPN KYOTANI	Rq	U4	UJPN FUKUTOMI	Rq	U5	UJPN SUZUKI, M.
Rq	U5	UJPN KIDA	Rq	U5	UJPN YAMASHITA	Rq	U6	UJPN SUZUKI, M.	Rq	U5	UJPN HAYASHI, KI.	Rq	U6	UJPN SAITO
Rq	U6	UJPN ABE	Rq	U6	UJPN SUZUKI, M.	Rq	U7	UJPN MIYAZAKI	Rq	U6	UJPN HIBI	Rq	U7	UJPN OTSUKA
Rq	U7	UJPN MARUYAMA	Rq	U7	UJPN AKIYAMA	Rq	U8	UJPN KOGA	Rq	U7	UJPN MATSUMOTO, E.	Rq	U8	UJPN INUI
Rq	U8	UJPN HAYASHI, KI.	Rq	U8	UJPN OTSUKA	Rq	U8	UJPN MATSUZAKI	Rq	U8	UJPN MITO	Rq	U8	UJPN JIN
E1	J/M/0	B2 WRT FUJIMOTO	E1	J/M/0	B1 KV DUONG, T.	E1	J/M/0	B1 WRT KITAGAWA	E1	J/M/0	B2 RDG TANAKA, S.	E1	J/M/0	B1 RDG SHINJO
E1	J/M/0	B2 SPK MATSUSHIMA	E1	J/M/0	B2 LIS KIDA	E1	J/M/0	B2 KV AKIYAMA	E1	J/M/0	B2 KV YAMAZAWA	E1	J/M/0	C1 RDG FURUTA
E1	J/M/0	C1 SPK TANAKA, Y.	E1	J/M/0	C1 LIS FURUKAWA	E1	J/M/0	C1 LIS TANAKA, M.	E1	J/M/0	C1 RDG NONAKA	E1	J/M/0	C1 GV FURUKAWA
E1	J/M/0	C1 KV CHIDA	E1	J/M/0	C1 KV KASAMATSU	E1	J/M/0	C1 KV OZAWA	E1	J/M/0	C1 GV FUJII, C.	E1	J/M/0	B2 HIS SATO, S.
E1	J/M/0	C1 THO MOTOBAYASHI	E1	J/M/0	B2 THO SHIBATA etc.	E1	J/M/0	C1 CON BEREZIKOVA	E1	J/M/0	C1 HIS TAIRA			
I														
Rq	U1	UJPN KANEDA	Rq	U1	UJPN KONDO	Rq	U	UJPN INUI	Rq	U1	UJPN KAN	Rq	U	UJPN HIBI
Rq	U2	UJPN SHIMA	Rq	U2	UJPN KOBAYASHI, K.	Rq	U	UJPN HAYASHI, KA.	Rq	U2	UJPN MASHITA	Rq	U	UJPN YAMAMOTO
Rq	U3	UJPN MIYAZAKI	Rq	U3	UJPN FUKUSHIMA	Rq	U4	UJPN YAMAZAWA	Rq	U3	UJPN NAKAMURA	Rq	U4	UJPN FUJIMOTO
Rq	U4	UJPN ISHIBASHI	Rq	U4	UJPN SAITO	Rq	U5	UJPN KYOTANI	Rq	U4	UJPN FUKUTOMI	Rq	U5	UJPN SUZUKI, M.
Rq	U5	UJPN KIDA	Rq	U5	UJPN YAMASHITA	Rq	U6	UJPN SUZUKI, M.	Rq	U5	UJPN HAYASHI, KI.	Rq	U6	UJPN SAITO
Rq	U6	UJPN ABE	Rq	U6	UJPN SUZUKI, M.	Rq	U7	UJPN MIYAZAKI	Rq	U6	UJPN HIBI	Rq	U7	UJPN OTSUKA
Rq	U7	UJPN MARUYAMA	Rq	U7	UJPN AKIYAMA	Rq	U8	UJPN KOGA	Rq	U7	UJPN MATSUMOTO, E.	Rq	U8	UJPN INUI
Rq	U8	UJPN HAYASHI, KI.	Rq	U8	UJPN OTSUKA	Rq	U8	UJPN HATANO	Rq	U8	UJPN MITO	Rq	M	B1 MGVS α 1 HIGUCHI
Rq	M	B1 MGVS α 1 TANAKA, Y.	Rq	M	B1 MGVS α 1 TAKAI	Rq	J/M/0	B1 LIS TANAKA, M.	Rq	M	B1 MGVS α 1 FUJII, C.	Rq	M	B1 MGVS α 2 FUJII, M.
Rq	M	B1 MGVS α 2 KYOTANI	Rq	M	B1 MGVS α 2 MATSUOKA	E1	J/M/0	B2 SPK UEDA, M.	Rq	M	B1 MGVS α 2 KOZAKURA	E1	J/M/0	B2 SPK MATSUZAKI
E1	J/M/0	B2 RDG MATSUSHIMA	E1	J/M/0	A2 GV DUONG, T.	E1	J/M/0	B2 GV OZAWA	Rq	M	B2 LIS NAMBA	E1	J/M/0	B2 KV FURUTA
E1	J/M/0	B2 LIS FUJIMOTO	E1	J/M/0	B2 GV KASAMATSU	E1	J/M/0	C1 CON LURMINAITE, S.	E1	J/M/0	B2 WRT NONAKA	E1	J/M/0	C1 WRT SUZUKI, Y.
E1	J/M/0	C1 GV KISHIDA	E1	J/M/0	C1 RDG NAKATA	E1	M/0	C1 CON IMURA	E1	J/M/0	C1 WRT TANAKA, S.	E1	J/M/0	C1 LIT SATO, S.
E1	J/M/0	C1 CON MOTOBAYASHI	E1	J/M/0	C1 SPK UEDA, M.	E1	J/M/0	C1 SOC AKIYAMA	E1	J/M/0	C1 SPK HATANO	E1	J	B2 JWRT SHINJO
E1	J	JWRT CHIDA	E1	J	B2 THO MATSUMURA	E1	J	B2 JWRT	E1	J	B2 JWRT TANAKA, MA.			
Rq	0	OJPN FUJIIHARA	E1	J	B2 KIDA				E1					
			E1		B2 FURUKAWA									
II														

Monday			Tuesday			Wednesday			Thursday			Friday								
E1	J/M/O	B1	LIS	KYOTANI	Rq	U1	JC	IMAI	RqE1	U	PHYS	OGAWA	Rq	U	MATH	MIGUCHI	Rq	U	CHEM	IWASA
E1	J/M/O	B2	KV	ABE	Rq	U2	JC	MATSUURA	RqE1	U	PHYS	SATO, T.	Rq	U	MATH	GOMYO	Rq	U	CHEM	NAITO
E1	J/M/O	C1	LIS	CHIDA	Rq	U3	JC	NAKATANI	RqE1	U	PHYS	TOGAWA	Rq	U	MATH	TAKAHASHI	Rq	U	CHEM	NAKAYAMA
E1	J/M/O	C1	SPK	ISHIBASHI	Rq	U4	JC	HIBI	RqE1	U	PHYS	HADA	Rq	U	MATH	FUJI	Rq	U	CHEM	HARADA
E1	J/M/O	B2	HIS	HISAOKA	Rq	U5	JC	MATSUMURA	RqE1	U	PHYS	NEMURA	Rq	U	MATH	MIYATA	Rq	U	CHEM	HONMA
E1	J/M/O	B2	LIT	GONOJJI	Rq	U6	JC	FUJITHIRA	RqE1	U	PHYS	HANDA	Rq	U	MATH	MORITA	Rq	U	CHEM	MATSUMOTO, A.
E1	J	B2	JWRT	KANEDA	Rq	U7	JC	SHIMOMURA	RqE1	U	BIOL	OHOKA	Rq	U	MATH	YAMADA	Rq	U	CHEM	MIKURIYA
E1	J	B2	JWRT	TANAKA, Y.	Rq	U8	JC	YAMAKAWA	RqE1	U	BIOL	TAKISAWA	Rq	U	MATH	NAMBA	Rq	U	B1 KV	SHIMOMURA
E1	J/M/O	C1	SPK	IWAI, S.	Rq	M	MDR	IWAI, S.	RqE1	J/M/O	B1 SPK	MIYAZAKI	E1	J/M/O	B2 SPK	TANAKA, MA.	E1	J/M/O	C1 SPK	FUJII, M.
E1	J/M/O	C1	LIS	KOMORI	Rq	M	MDR	KOMORI	E1	J/M/O	B2 GV	HATANO	E1	J/M/O	B2 GV	KOZAKURA	E1	J/M/O	C1 THO	WATANABE, C.
E1	J/M/O	C1	SPK	CIOLOCA, R.	Rq	M	MDR	CIOLOCA, R.	E1	J/M/O	C1 LIS	IWAI, Y.	E1	J/M/O	C1 WRT	YAMAMOTO, K.	E1	J/M/O	C1 LIT	SHIBATA
E1	J/M/O	B2	LIT	TAKAI	Rq	M	MDR	TAKAI	E1	J/M/O	C1 KV	KOGA	E1	J/M/O	C1 KV	MITO	E1	J/M/O	C1 CON	KOYAMA
E1	J/M/O	B2	LIT	MATSUOKA	Rq	M	MDR	MATSUOKA	E1	J/M/O	C1 LIN	NAKATA	E1	J/M/O	C1 HIS	INOMO	E1	J/M/O	B2 EDU	SUZUKI, Y.
E1	J	B2	JWRT	IWAI, Y.	Rq	J	JDR	IWAI, Y.	E1	J/M/O	B2 HIS	SANO, M.	E1	J	B2 JWRT	FUKUTOMI	E1	J	B2 HIS	INOUE
E1	J	B2	JWRT	GONOJJI	Rq	J	JDR	GONOJJI	E1	J	B2 JWRT	UEDA, M.	E1	J	B2 JWRT	MASHITA	E1	J	B2 JWRT	ATARASHI
E1	J	B2	JWRT	SHOJI	Rq	J	JDR	SHOJI	E1	J	B2 JWRT	KYOTANI	E1	J	B2 JWRT	FUJII, C.	E1	J	B2 JWRT	HIGUCHI
E1	J	B2	JWRT	NAKATA	Rq	J	JDR	NAKATA	E1	J	B2 JWRT	KYOTANI	E1	J	B2 JWRT	FUJII, C.	E1	J	B2 JWRT	FURUTA
E1	J	B2	JWRT	MURATA, M.	Rq	J	JDR	MURATA, M.	E1	J	B2 JWRT	KYOTANI	E1	J	B2 JWRT	FUJII, C.	E1	J	B2 JWRT	FURUTA
E1	J	B2	JWRT	SHIBATA	Rq	J	JDR	SHIBATA	E1	J	B2 JWRT	KYOTANI	E1	J	B2 JWRT	FUJII, C.	E1	J	B2 JWRT	FURUTA
E1	J	B2	JWRT	MIZUNO	Rq	J	JDR	MIZUNO	E1	J	B2 JWRT	KYOTANI	E1	J	B2 JWRT	FUJII, C.	E1	J	B2 JWRT	FURUTA
E1	J	B2	JWRT	MIZUNO	Rq	J	JDR	MIZUNO	E1	J	B2 JWRT	KYOTANI	E1	J	B2 JWRT	FUJII, C.	E1	J	B2 JWRT	FURUTA
E1	J	B2	JWRT	MIZUNO	Rq	J	JDR	MIZUNO	E1	J	B2 JWRT	KYOTANI	E1	J	B2 JWRT	FUJII, C.	E1	J	B2 JWRT	FURUTA
E1	J	B2	JWRT	MIZUNO	Rq	J	JDR	MIZUNO	E1	J	B2 JWRT	KYOTANI	E1	J	B2 JWRT	FUJII, C.	E1	J	B2 JWRT	FURUTA
E1	J	B2	JWRT	MIZUNO	Rq	J	JDR	MIZUNO	E1	J	B2 JWRT	KYOTANI	E1	J	B2 JWRT	FUJII, C.	E1	J	B2 JWRT	FURUTA
E1	J	B2	JWRT	MIZUNO	Rq	J	JDR	MIZUNO	E1	J	B2 JWRT	KYOTANI	E1	J	B2 JWRT	FUJII, C.	E1	J	B2 JWRT	FURUTA
E1	J	B2	JWRT	MIZUNO	Rq	J	JDR	MIZUNO	E1	J	B2 JWRT	KYOTANI	E1	J	B2 JWRT	FUJII, C.	E1	J	B2 JWRT	FURUTA
E1	J	B2	JWRT	MIZUNO	Rq	J	JDR	MIZUNO	E1	J	B2 JWRT	KYOTANI	E1	J	B2 JWRT	FUJII, C.	E1	J	B2 JWRT	FURUTA
E1	J	B2	JWRT	MIZUNO	Rq	J	JDR	MIZUNO	E1	J	B2 JWRT	KYOTANI	E1	J	B2 JWRT	FUJII, C.	E1	J	B2 JWRT	FURUTA
E1	J	B2	JWRT	MIZUNO	Rq	J	JDR	MIZUNO	E1	J	B2 JWRT	KYOTANI	E1	J	B2 JWRT	FUJII, C.	E1	J	B2 JWRT	FURUTA
E1	J	B2	JWRT	MIZUNO	Rq	J	JDR	MIZUNO	E1	J	B2 JWRT	KYOTANI	E1	J	B2 JWRT	FUJII, C.	E1	J	B2 JWRT	FURUTA
E1	J	B2	JWRT	MIZUNO	Rq	J	JDR	MIZUNO	E1	J	B2 JWRT	KYOTANI	E1	J	B2 JWRT	FUJII, C.	E1	J	B2 JWRT	FURUTA
E1	J	B2	JWRT	MIZUNO	Rq	J	JDR	MIZUNO	E1	J	B2 JWRT	KYOTANI	E1	J	B2 JWRT	FUJII, C.	E1	J	B2 JWRT	FURUTA
E1	J	B2	JWRT	MIZUNO	Rq	J	JDR	MIZUNO	E1	J	B2 JWRT	KYOTANI	E1	J	B2 JWRT	FUJII, C.	E1	J	B2 JWRT	FURUTA
E1	J	B2	JWRT	MIZUNO	Rq	J	JDR	MIZUNO	E1	J	B2 JWRT	KYOTANI	E1	J	B2 JWRT	FUJII, C.	E1	J	B2 JWRT	FURUTA
E1	J	B2	JWRT	MIZUNO	Rq	J	JDR	MIZUNO	E1	J	B2 JWRT	KYOTANI	E1	J	B2 JWRT	FUJII, C.	E1	J	B2 JWRT	FURUTA
E1	J	B2	JWRT	MIZUNO	Rq	J	JDR	MIZUNO	E1	J	B2 JWRT	KYOTANI	E1	J	B2 JWRT	FUJII, C.	E1	J	B2 JWRT	FURUTA
E1	J	B2	JWRT	MIZUNO	Rq	J	JDR	MIZUNO	E1	J	B2 JWRT	KYOTANI	E1	J	B2 JWRT	FUJII, C.	E1	J	B2 JWRT	FURUTA
E1	J	B2	JWRT	MIZUNO	Rq	J	JDR	MIZUNO	E1	J	B2 JWRT	KYOTANI	E1	J	B2 JWRT	FUJII, C.	E1	J	B2 JWRT	FURUTA
E1	J	B2	JWRT	MIZUNO	Rq	J	JDR	MIZUNO	E1	J	B2 JWRT	KYOTANI	E1	J	B2 JWRT	FUJII, C.	E1	J	B2 JWRT	FURUTA
E1	J	B2	JWRT	MIZUNO	Rq	J	JDR	MIZUNO	E1	J	B2 JWRT	KYOTANI	E1	J	B2 JWRT	FUJII, C.	E1	J	B2 JWRT	FURUTA
E1	J	B2	JWRT	MIZUNO	Rq	J	JDR	MIZUNO	E1	J	B2 JWRT	KYOTANI	E1	J	B2 JWRT	FUJII, C.	E1	J	B2 JWRT	FURUTA
E1	J	B2	JWRT	MIZUNO	Rq	J	JDR	MIZUNO	E1	J	B2 JWRT	KYOTANI	E1	J	B2 JWRT	FUJII, C.	E1	J	B2 JWRT	FURUTA
E1	J	B2	JWRT	MIZUNO	Rq	J	JDR	MIZUNO	E1	J	B2 JWRT	KYOTANI	E1	J	B2 JWRT	FUJII, C.	E1	J	B2 JWRT	FURUTA
E1	J	B2	JWRT	MIZUNO	Rq	J	JDR	MIZUNO	E1	J	B2 JWRT	KYOTANI	E1	J	B2 JWRT	FUJII, C.	E1	J	B2 JWRT	FURUTA
E1	J	B2	JWRT	MIZUNO	Rq	J	JDR	MIZUNO	E1	J	B2 JWRT	KYOTANI	E1	J	B2 JWRT	FUJII, C.	E1	J	B2 JWRT	FURUTA
E1	J	B2	JWRT	MIZUNO	Rq	J	JDR	MIZUNO	E1	J	B2 JWRT	KYOTANI	E1	J	B2 JWRT	FUJII, C.	E1	J	B2 JWRT	FURUTA
E1	J	B2	JWRT	MIZUNO	Rq	J	JDR	MIZUNO	E1	J	B2 JWRT	KYOTANI	E1	J	B2 JWRT	FUJII, C.	E1	J	B2 JWRT	FURUTA
E1	J	B2	JWRT	MIZUNO	Rq	J	JDR	MIZUNO	E1	J	B2 JWRT	KYOTANI	E1	J	B2 JWRT	FUJII, C.	E1	J	B2 JWRT	FURUTA
E1	J	B2	JWRT	MIZUNO	Rq	J	JDR	MIZUNO	E1	J	B2 JWRT	KYOTANI	E1	J	B2 JWRT	FUJII, C.	E1	J	B2 JWRT	FURUTA
E1	J	B2	JWRT	MIZUNO	Rq	J	JDR	MIZUNO	E1	J	B2 JWRT	KYOTANI	E1	J	B2 JWRT	FUJII, C.	E1	J	B2 JWRT	FURUTA
E1	J	B2	JWRT	MIZUNO	Rq	J	JDR	MIZUNO	E1	J	B2 JWRT	KYOTANI	E1	J	B2 JWRT	FUJII, C.	E1	J	B2 JWRT	FURUTA
E1	J	B2	JWRT	MIZUNO	Rq	J	JDR	MIZUNO	E1	J	B2 JWRT	KYOTANI	E1	J	B2 JWRT	FUJII, C.	E1	J	B2 JWRT	FURUTA
E1	J	B2	JWRT	MIZUNO	Rq	J	JDR	MIZUNO	E1	J	B2 JWRT	KYOTANI	E1	J	B2 JWRT	FUJII, C.	E1	J	B2 JWRT	FURUTA
E1	J	B2	JWRT	MIZUNO	Rq	J	JDR	MIZUNO	E1	J	B2 JWRT	KYOTANI	E1	J	B2 JWRT	FUJII, C.	E1	J	B2 JWRT	FURUTA
E1	J	B2	JWRT	MIZUNO	Rq	J	JDR	MIZUNO	E1	J	B2 JWRT	KYOTANI	E1	J	B2 JWRT	FUJII, C.	E1	J	B2 JWRT	FURUTA
E1	J	B2	JWRT	MIZUNO	Rq	J	JDR	MIZUNO	E1	J	B2 JWRT	KYOTANI	E1	J	B2 JWRT	FUJII, C.	E1	J	B2 JWRT	FURUTA
E1	J	B2	JWRT	MIZUNO	Rq	J	JDR	MIZUNO	E1	J	B2 JWRT	KYOTANI	E1	J	B2 JWRT	FUJII, C.	E1	J	B2 JWRT	FURUTA
E1	J	B2	JWRT	MIZUNO	Rq	J	JDR	MIZUNO	E1	J	B2 JWRT	KYOTANI	E1	J	B2 JWRT	FUJII, C.	E1	J	B2 JWRT	FURUTA
E1	J	B2	JWRT	MIZUNO	Rq	J	JDR	MIZUNO	E1	J	B2 JWRT	KYOTANI	E1	J	B2 JWRT	FUJII, C.	E1	J	B2 JWRT	FURUTA
E1	J	B2	JWRT	MIZUNO	Rq	J	JDR	MIZUNO	E1	J	B2 JWRT	KYOTANI	E1	J	B2 JWRT	FUJII, C.	E1	J	B2 JWRT	FURUTA
E1	J	B2	JWRT	MIZUNO	Rq	J	JDR	MIZUNO	E1	J	B2 JWRT	KYOTANI	E1	J	B2 JWRT	FUJII, C.	E1	J	B2 JWRT	FURUTA
E1	J	B2	JWRT	MIZUNO	Rq	J	JDR	MIZUNO	E1	J	B2 JWRT	KYOTANI	E1	J	B2 JWRT	FUJII, C.	E1	J	B2 JWRT	FURUTA
E1	J	B2	JWRT	MIZUNO	Rq	J	JDR	MIZUNO	E1	J	B2 JWRT	KYOTANI	E1	J	B2 JWRT	FUJII, C.	E1	J	B2 JWRT	FURUTA
E1	J	B2	JWRT	MIZUNO	Rq	J	JDR	MIZUNO	E1	J	B2 JWRT	KYOTANI	E1	J	B2 JWRT	FUJII, C.	E1	J	B2 JWRT	FURUTA
E1	J	B2	JWRT	MIZUNO	Rq	J	JDR	MIZUNO	E1	J	B2 JWRT	KYOTANI	E1	J	B2 JWRT	FUJII, C.	E1	J	B2 JWRT	FURUTA
E1	J	B2	JWRT	MIZUNO	Rq	J	JDR	MIZUNO	E1	J	B2 JWRT	KYOTANI	E1	J	B2 JWRT	FUJII, C.	E1	J	B2 JWRT	FURUTA
E1	J	B2	JWRT	MIZUNO	Rq	J	JDR	MIZUNO	E1	J	B2 JWRT	KYOTANI	E1	J	B2 JWRT	FUJII, C.	E1	J	B2 JWRT	FURUTA
E1	J	B2	JWRT	MIZUNO	Rq	J	JDR	MIZUNO	E1	J	B2 JWRT	KYOTANI	E1	J	B2 JWRT	FUJII, C.	E1	J	B2 JWRT	FURUTA
E1	J	B2	JWRT	MIZUNO	Rq	J	JDR	MIZUNO	E1	J	B2 JWRT	KYOTANI	E1	J	B2 JWRT	FUJII, C.	E1	J	B2 JWRT	FURUTA
E1	J	B2	JWRT	MIZUNO	Rq	J	JDR	MIZUNO	E1	J	B2 JWRT	KYOTANI	E1	J	B2 JWRT	FUJII, C.	E1	J	B2 JWRT	FURUTA
E1	J	B2	JWRT	MIZUNO	Rq	J	JDR	MIZUNO	E1	J	B2 JWRT	KYOTANI	E1	J	B2 JWRT	FUJII, C.	E1	J	B2 JWRT	FURUTA
E1	J	B2	JWRT	MIZUNO	Rq	J	JDR	MIZUNO	E1	J	B2 JWRT	KYOTANI	E1	J	B2 JWRT	FUJII, C.	E1	J	B2 JWRT	FURUTA
E1	J	B2	JWRT	MIZUNO	Rq	J	JDR	MIZUNO	E1	J	B2 JWRT	KYOTANI	E1	J	B2 JWRT	FUJII, C.	E1	J	B2 JWRT	FURUTA
E1	J	B2	JWRT	MIZUNO	Rq	J	JDR	MIZUNO	E1	J	B2 JWRT	KYOTANI	E1	J	B2 JWRT	FUJII, C.	E1	J	B2 JWRT	FURUTA
E1	J	B2	JWRT	MIZUNO	Rq	J	JDR	MIZUNO	E1	J	B2 JWRT	KYOTANI	E1	J	B2 JWRT	FUJII, C.	E1	J	B2 JWRT	FURUTA
E1	J	B2	JWRT	MIZUNO	Rq	J	JDR	MIZUNO	E1	J	B2 JWRT	KYOTANI	E1	J	B2 JWRT	FUJII, C.	E1	J	B2 JWRT	FURUTA
E1	J	B2	JWRT	MIZUNO	Rq	J	JDR	MIZUNO	E1	J	B2 JWRT	KYOTANI	E1	J	B2 JWRT	FUJII, C.	E1	J	B2 JWRT	FURUTA
E1	J	B2	JWRT	MIZUNO	Rq	J	JDR	MIZUNO	E1	J	B2 JWRT	KYOTANI	E1	J	B2 JWRT	FUJII, C.	E1	J	B2 JWRT	FURUTA
E1	J	B2	JWRT	MIZUNO	Rq	J	JDR	MIZUNO	E1	J	B2 JWRT	KYOTANI	E1	J	B2 JWRT	FUJII, C.	E1	J	B2 JWRT	FURUTA
E1	J	B2	JWRT	MIZUNO	Rq	J	JDR	MIZUNO	E1	J	B2 JWRT	KYOTANI	E1	J	B2 JWRT	FUJII, C.	E1	J	B2 JWRT	FURUTA
E1	J	B2	JWRT	MIZUNO	Rq	J	JDR	MIZUNO	E1	J	B2 JWRT	KYOTANI	E1	J	B2 JWRT	FUJII, C.	E1	J	B2 JWRT	FURUTA
E1	J	B2	JWRT	MIZUNO	Rq	J	JDR	MIZUNO	E1	J	B2 JWRT	KYOTANI	E1	J	B2 JWRT	FUJII, C.	E1	J	B2 JWRT	FURUTA
E1	J	B2	JWRT	MIZUNO	Rq	J	JDR	MIZUNO	E1	J	B2 JWRT	KYOTANI	E1	J	B2 JWRT	FUJII, C.	E1	J	B2 JWRT	FURUTA
E1	J	B2	JWRT	MIZUNO	Rq	J	JDR	MIZUNO	E1	J	B2 JWRT	KYOTANI	E1	J	B2 JWRT	FUJII, C.	E1	J	B2 JWRT	FURUTA
E1	J	B2	JWRT	MIZUNO	Rq	J	JDR	MIZUNO	E1	J	B2 JWRT	KYOTANI	E1	J	B2 JWRT	FUJII, C.	E1	J	B2 JWRT	FURUTA
E1	J	B2	JWRT	MIZUNO	Rq	J	JDR	MIZUNO	E1	J	B2 JWRT	KYOTANI	E1	J	B2 JWRT	F				

M

Spring and Summer Terms, 2025

	Monday				Tuesday				Wednesday				Thursday				Friday			
	level	subject	code	Instructor(s)	level	subject	code	Instructor(s)	level	subject	code	Instructor(s)	level	subject	code	Instructor(s)	level	subject	code	Instructor(s)
I	B2	WRT	390065	FUJIMOTO	B1	KV	390040	DUONG, T.	B1	RDG	390010	MATSUZAKI	B2	RDG	390046	TANAKA, S.	B1	RDG	390011	JIN
	B2	SPK	390075	MATSUSHIMA	B2	LIS	390056	KIDA	B2	WRT	390066	KITAGAWA	B2	KV	390097	YAMAZAWA	B2	RDG	390048	SHINJO
	C1	SPK	390130	TANAKA, Y.	C1	LIS	390111	FURUKAWA	B2	KV	390096	AKIYAMA	C1	RDG	390105	NONAKA	C1	RDG	390106	FURUTA
	C1	KV	390150	CHIDA	C1	KV	390153	KASAMATSU	C1	LIS	390112	TANAKA, M.	C1	GV	390143	FUJII, C.	C1	GV	390145	FURUKAWA
	C1	THO	390180	MOTOBAYASHI	B2	THO	390185	SHIBATA etc.	C1	KV	390154	OZAWA	C1	HIS	390197	TAIRA	B2	HIS	390195	SATO, S.
II	B1	MGV α 1	390001	TANAKA, Y.	B1	MGV α 1	390001	TAKAI	B1	LIS	390016	HATANO	B1	MGV α 1	390001	FUJII, C.	B1	MGV α 1	390001	HIGUCHI
	B1	MGV α 2	390002	KYOTANI	B1	MGV α 2	390002	MATSUOKA	B2	SPK	390076	TANAKA, M.	B1	MGV α 2	390002	KOZAKURA	B1	MGV α 2	390002	FUJII, M.
	B2	RDG	390045	MATSUSHIMA	A2	GV	390020	DUONG, T.	B2	GV	390086	UEDA, M.	B2	LIS	390057	NAMBA	B2	SPK	390078	MATSUZAKI
	B2	LIS	390055	FUJIMOTO	B2	GV	390085	KASAMATSU	C1	WRT	390122	OZAWA	B2	WRT	390068	NONAKA	B2	KV	390098	FURUTA
	C1	GV	390140	KISHIDA	C1	RDG	390103	NAKATA	—	CON	390225	LUKMINAITE, S.	C1	WRT	390123	TANAKA, S.	C1	WRT	390125	SUZUKI, Y.
III	C1	CON	390220	MOTOBAYASHI	C1	SPK	390132	UEDA, M.	C1	SOC	390230	IMURA	C1	SPK	390133	HATANO	C1	LIT	390201	SATO, S.
	B2	THO			B2	THO	390186	MATSUMURA												
	B1	LIS	390015	KYOTANI	B1	MDR	390260	IWAI, S.	B1	SPK	390025	MIYAZAKI	B1	WRT	390021	NAMBA	B1	KV	390042	SHIMOMURA
	B2	KV	390095	ABE	MDR	MDR	390261	KOMORI	B2	GV	390087	HATANO	B2	SPK	390077	TANAKA, MA.	C1	SPK	390135	FUJII, M.
	C1	LIS	390110	CHIDA	MDR	MDR	390262	CIOLCA, R.	C1	LIS	390113	IWAI, Y.	B2	GV	390088	KOZAKURA	C1	THO	390181	WATANABE, C.
IV	C1	SPK	390131	ISHIBASHI	MDR	MDR	390263	TAKAI	C1	KV	390155	KOGA	C1	WRT	390124	YAMAMOTO, K.	C1	LIT	390202	SHIBATA
	B2	HIS	390191	HISAOKA	MDR	MDR	390264	MATSUOKA	C1	LIN	390161	NAKATA	C1	KV	390156	MITO	C1	CON	390222	KOYAMA
	B2	LIT	390205	GONOJI					B2	HIS	390193	SANO, M.	C1	HIS	390198	INOMO	B2	EDU	390241	SUZUKI, Y.
V	C1	WRT	390121	BABA					B1	GV	390030	DUONG, T.	B1	SPK	390026	KAI	C1	RDG	390107	ATARASHI
	C1	KV	390151	KAWASHIMA					B2	WRT	390067	HIROKAWA	B2	RDG	390047	UEDA, A.	B2	THO	390187	ONISHI
	C1	LIN	390160	YAMAKAWA					C1	GV	390142	NAKATA	C1	GV	390144	ATSUTA	B2	LIT	390207	SHIBATA
	—	HIS	390190	FUKUMITSU					B2	LIN	390168	IWAI, Y.	B2	HIS	390194	INOMO	—	CON	390226	WATANABE, C.
	B2	LIT	390206	HISAOKA					C1	HIS	390196	SANO, M.	C1	HIS	390199	YAMAMOTO, K.	C1	SOC	390231	IITO
	B2	SOC	390235	HAYASHI, H.					B2	CON	390229	KOBAYASHI, S.	B2	CON	390229	KOBAYASHI, S.	C1	HIS	390230	KOYAMA
	C1	GV	390141	KAWASHIMA					B1	KV	390041	WADA	B1	GV	390031	KIM	MCC	390M01	KOMORI	
	B2	LIN	390166	IMAI	MIS	MIS	390250	IWAI, S.	C1	RDG	390104	HIROKAWA	B2	LIS	390058	OKUNO	MCC	390M02	SANO, M.	
	B2	HIS	390192	FUKUMITSU	MIS	MIS	390251	GONOJI	C1	LIN	390162	SHOJI	C1	LIS	390114	MURATA, K.	MCC	390M03	SHOJI	
	C1	LIT	390200	MIZUNO					B2	CON	390228	IWAI, S.	C1	SPK	390134	ATSUTA				
	B2	CON	390227	TSUNODA					B2	EDU	390240	KOMORI	B2	CON	390430	PENG				

My Weekly Schedule

I	II	III	IV	V
Monday				
Tuesday				
Wednesday				
Thursday				
Friday				

略号 / Abbreviations

プログラム/Programs	
【U】	Undergraduate Students Program
【J】	Japanese Studies Program
【M】	Maple Program
【F】	The University of Osaka Foundation Program (秋～冬学期のみ)
【O】	OU-MU Program (春～夏学期のみ)

日本語レベル/Japanese Levels	
A2	初中級/Pre-intermediate
B1	中級/Intermediate
B2	中上級/Upper-intermediate
C1	上級/Advanced

授業科目/Subjects for 【J】 【M】 【F】 【O】 Program	
日本語実習科目/Japanese Language Subjects	
RDG	読解/Reading
LIS	聴解/Listening
WRT	文章表現/Writing
SPK	口頭表現/Speaking
GV	文法・語彙/Grammar & Vocabulary
KV	漢字・語彙/Kanji & Vocabulary
JWRT	J文章表現/Writing for 【J】 Program Students (春～夏学期のみ)
JGV	日本語初中級文法・語彙/日本語中級文法・語彙/Grammar & Vocabulary for 【J】 Program Students (秋～冬学期のみ)
MGV	現代日本語初中級文法・語彙/現代日本語中級文法・語彙/Grammar & Vocabulary for 【M】 Program Students
FGV	日本語初中級文法・語彙/日本語中級文法・語彙/Grammar & Vocabulary for 【F】 Program Students (秋～冬学期のみ)
研究科目/Research Subjects	
LIN	日本語学研究基礎/日本語学研究/Japanese Linguistics
EDU	日本語教育学研究基礎/日本語教育学研究/Japanese Language Education
THO	日本思想文化学研究基礎/日本思想文化学研究/Japanese Thought
HIS	日本歴史文化学研究基礎/日本歴史文化学研究/Japanese History
LIT	日本文献文化学研究基礎/日本文献文化学研究/Japanese Literature
CON	日本近現代文化学研究基礎/日本近現代文化学研究/Japanese Contemporary Culture
SOC	日本社会文化学研究基礎/日本社会文化学研究/Japanese Social Sciences
演習科目/Seminar Subjects	
JDR	日本語・日本文化研究指導/日本語・日本文化研修指導/Directed Research and Reading for 【J】 Program Students
MDR	日本語日本文化専門演習/Directed Research and Reading for 【M】 Program Students
MIS	自主研究/Independent Studies for 【M】 Program Students
MCC	多文化・地域共生/Multicultural Community Cohesion

授業科目/Subjects for 【U】 【F】 【O】 Program	
UJPN	学部留学生日本語/Japanese for 【U】 Program Students
FJPN	大阪大学学部留学生日本語/Japanese for 【F】 Program Students (秋～冬学期のみ)
OJPN	大阪・マヒドン留学生日本語/Japanese for 【O】 Program Students (春～夏学期のみ)
JC	日本事情/Japanese Cultural Background
BIOL	生物/Biology
CHEM	化学/Chemistry
MATH	数学/Mathematics
PHYS	物理/Physics
HIST	日本史/History (秋～冬学期のみ)
POLI	政治・経済/Politics & Economics (秋～冬学期のみ)
ENG	英語/English

み の お
箕面キャンパスマップ
Minoh Campus Map

箕面キャンパスマップ Minoh Campus Map

- ① Graduate School of Language and Culture/School of Foreign Studies
② **Center for Japanese Language and Culture**
③ International Studies Library

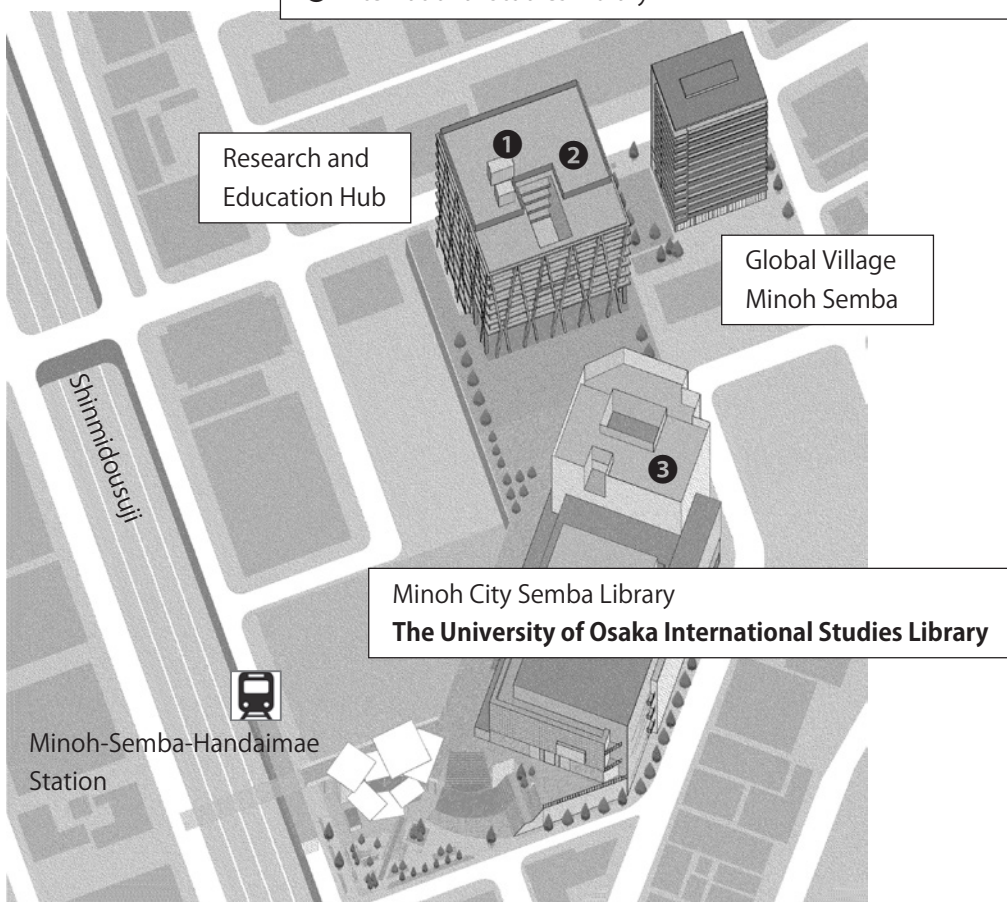

○住所

〒562-8678 大阪府箕面市船場東3丁目5番10号 / 3-5-10, Senba-higashi, Minoh, Osaka

【周辺駅・バス停地図／Map of the surrounding Area】



○アクセス

電車 北大阪急行線 箕面船場阪大前駅下車 徒歩約3分

バス 阪急バス [千里中央バスターミナルから]

箕面中央線 箕面船場阪大前駅バス停下車 徒歩約3分
小野原東線(※朝・夕のみ) 船場団地バス停下車 徒歩
約1分

豊中市内線 新船場南橋バス停下車 徒歩約7分

○How to get to Minoh Campus

By railway

Kita Osaka Kyuko Railway, get off at
Minoh-Semba-Handai-mae Station
→ 3 minutes on foot

By Bus

Hankyu Bus [From Senri-Chuo Bus Terminal]
Minoh Chuo Line, get off at Minoh-Semba-Handai-mae
Station bus stop

→ 3 minutes on foot
Onohara Higashi Line (*only in the morning and evening),
get off at Senba Danchi bus stop
→ 1 minute on foot

Toyonaka City Line , get off at ShinSamba Minami-bashi bus stop

→ 7 minutes on foot

フロア図（関連部分抜粋）

外国学研究講義棟 Research and Education Hub	
10F	外国語学部
9F	外国語学部
8F	外国語学部
7F	日日センター CJLC (Center for Japanese Language and Culture)
6F	講義室
5F	講義室・交流空間
4F	D3(旧サイバー)・講義
3F	食堂、ロビー、 南玄関
2F	事務部門・会議等
1F	北玄関, 記念ホール, 設備等

ピロティ

1F

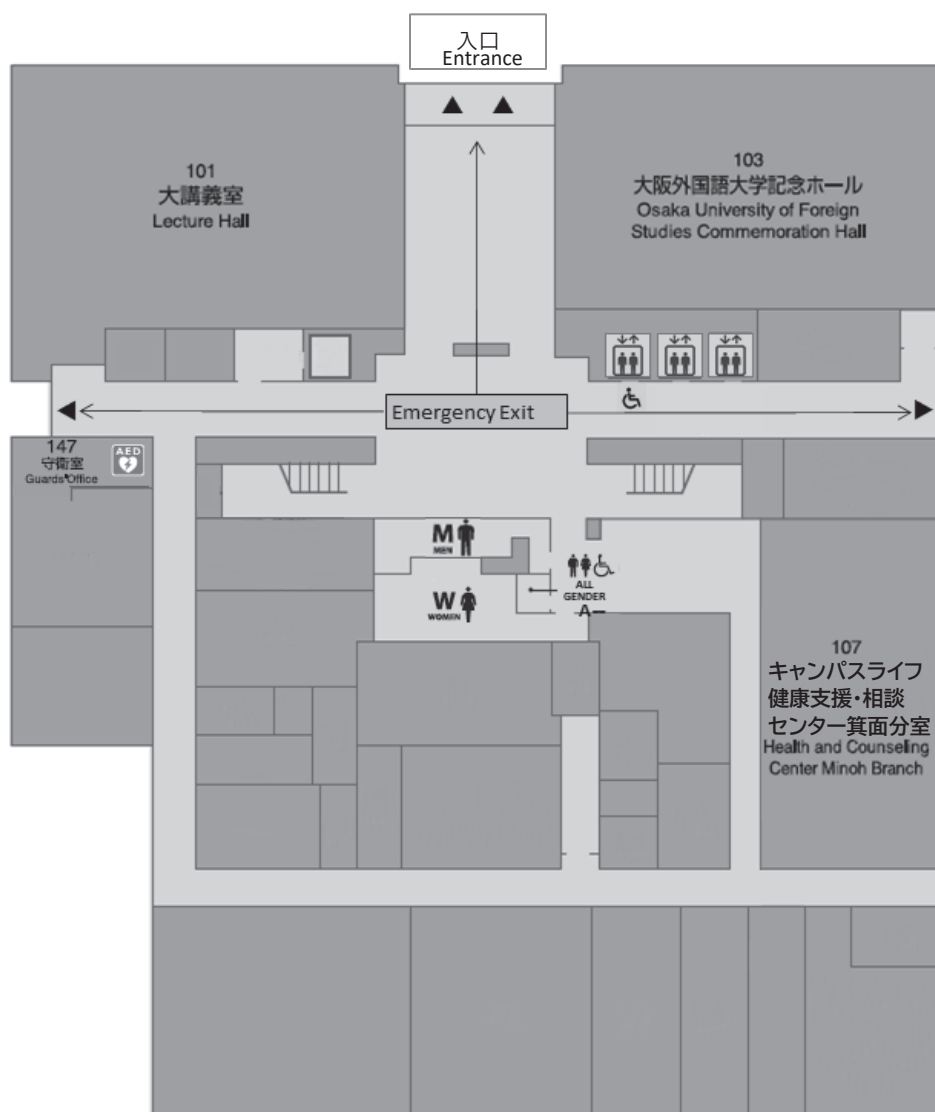

2F

吹き抜け

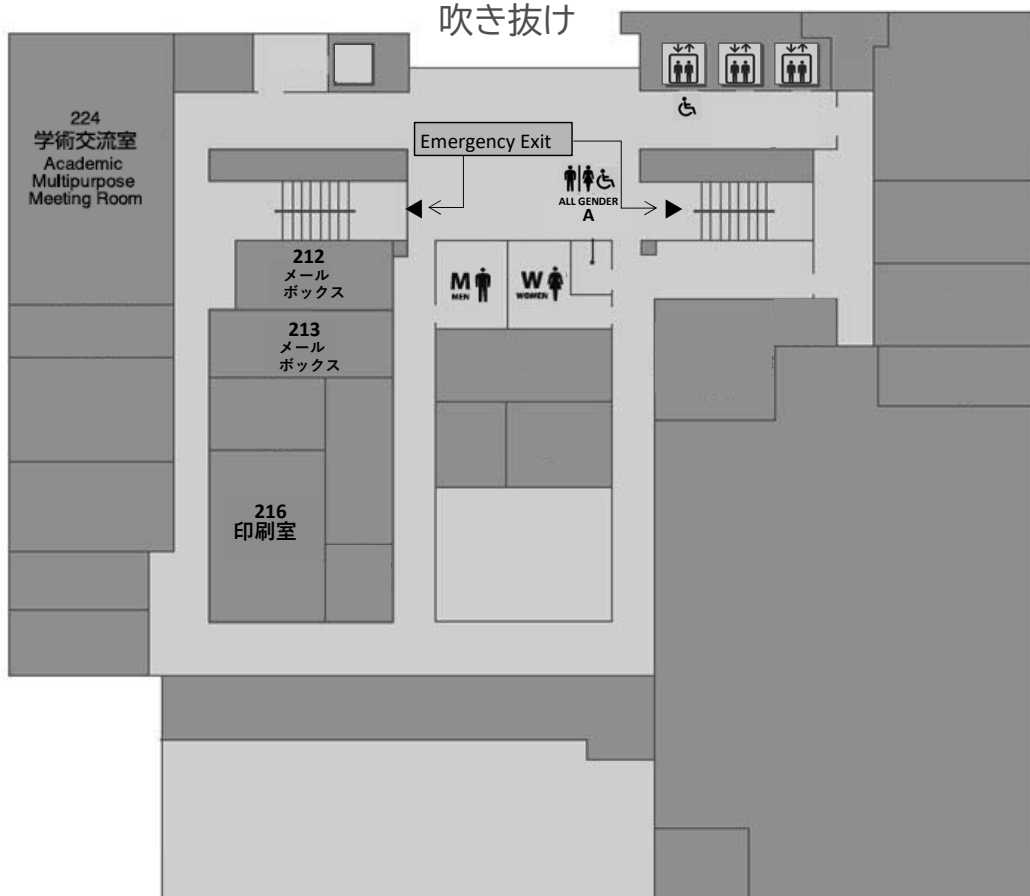

5F

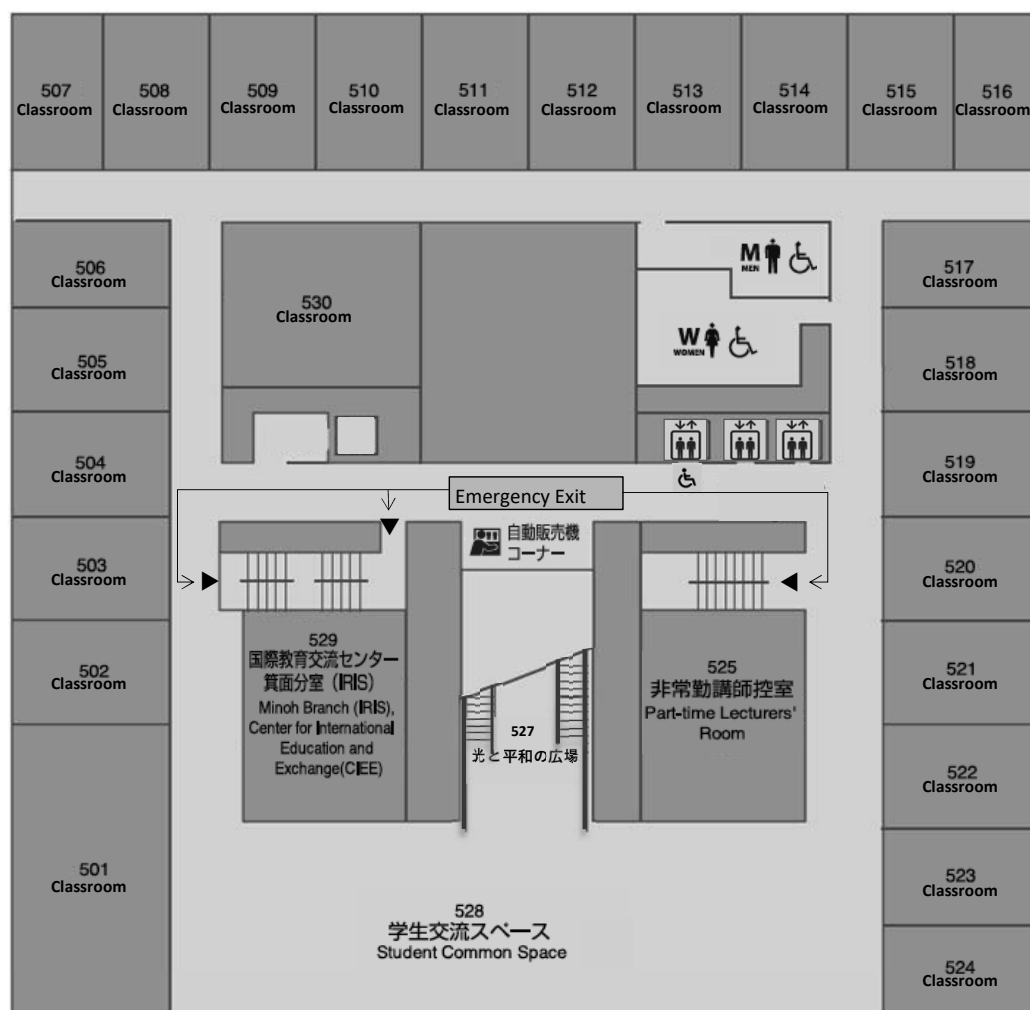

6F

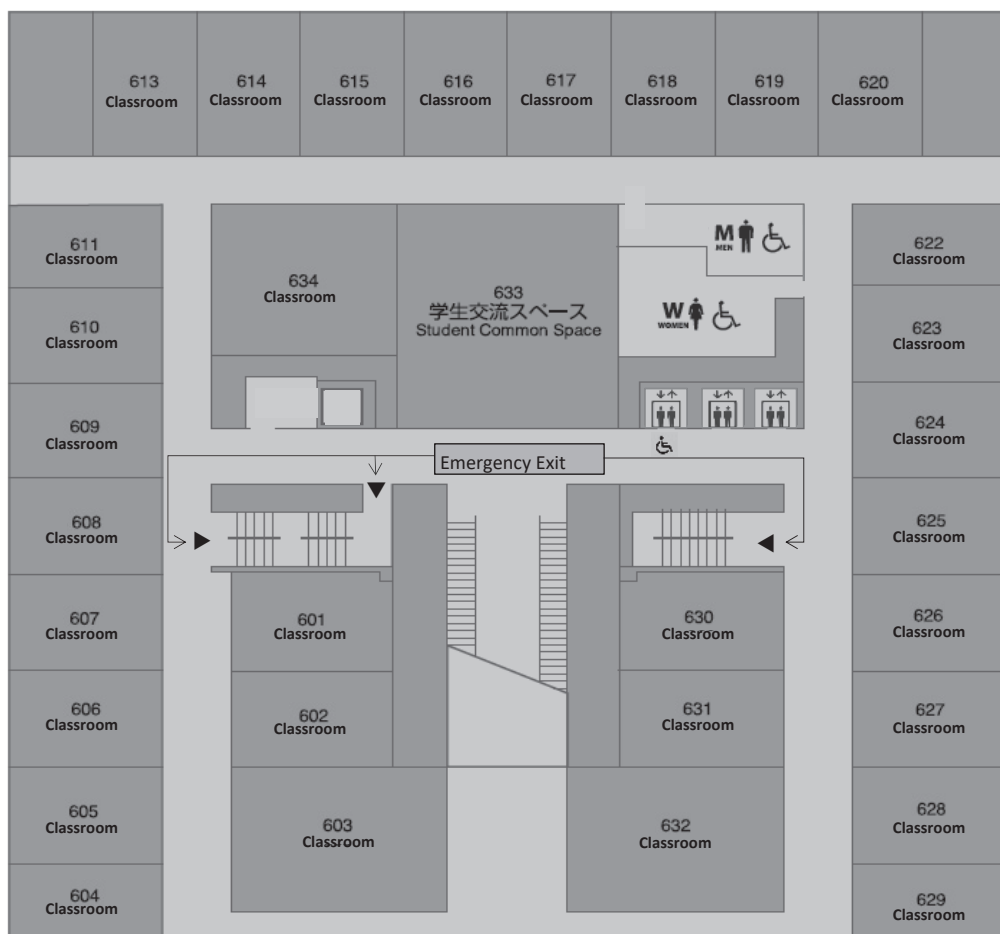

7F

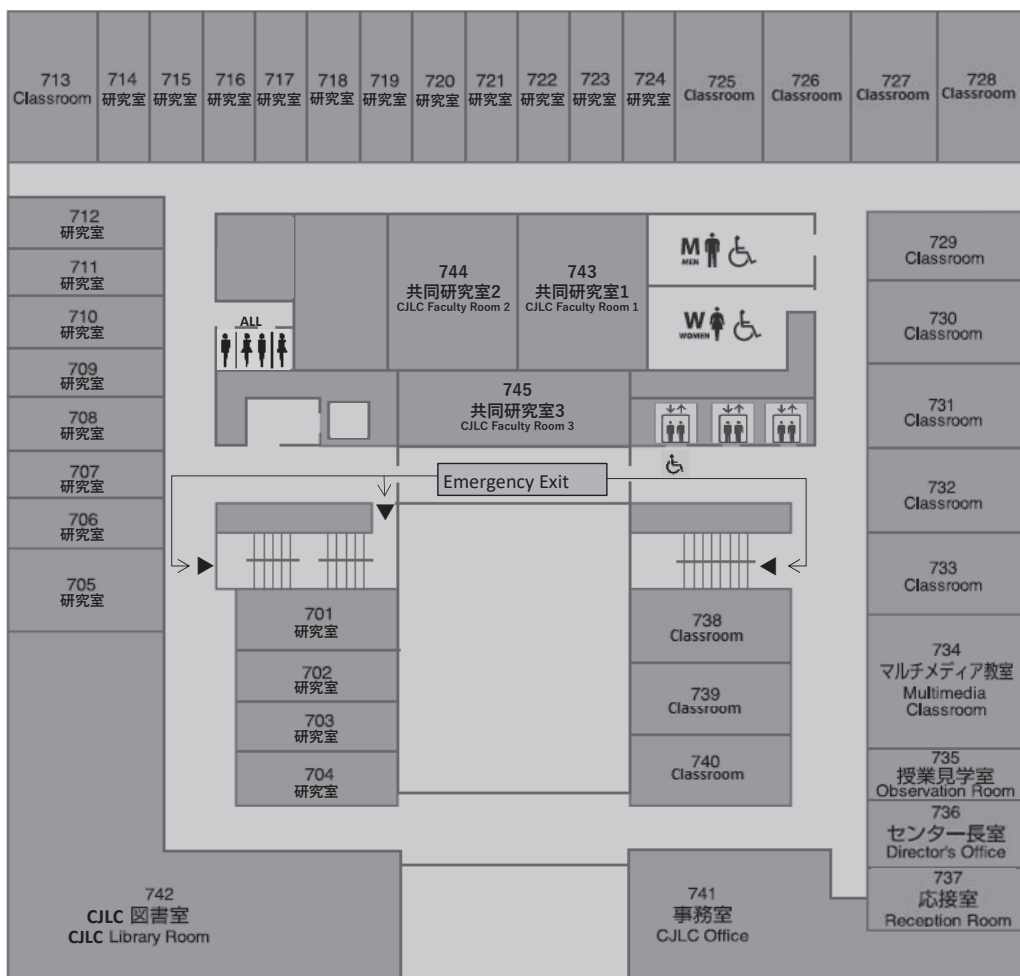

部屋番号 Room Number	施設 Facility
743	共同研究室 1 CJLC Faculty Room 1
744	共同研究室 2 CJLC Faculty Room 2
745	共同研究室 3 CJLC Faculty Room 3

教員研究室

Instructor's Office

部屋番号 Room Number	教 員 名 Instructor's Name	部屋番号 Room Number	教 員 名 Instructor's Name
701	日比 伊奈穂 HIBI I. ズオンティ ホア DUONG, T.	714	松浦 幸祐 MATSUURA K.
702	松岡 里奈 MATSUOKA R.	715	岩井 康雄 IWAI Y.
703	下村 朱有美 SHIMOMURA A.	716	佐野 方郁 SANO M.
704	藤平 愛美 FUJIHIRA M.	717	高井 美穂 TAKAI M.
705	チョルカ ラルカ マリア CIOLCA, R.	718	岸田 泰浩 KISHIDA Y.
706	松村 薫子 MATSUMURA K.	719	荘司 育子 SHOJI I.
707	中谷 真也 NAKATANI S.	720	小森 万里 KOMORI M.
708	岩井 茂樹 IWAI S.	721	水野 亜紀子 MIZUNO A.
709	中田 一志 NAKATA H.	722	立川 真紀絵 TACHIKAWA M.
710	柴田 芳成 SHIBATA Y.	723	五之治 昌比呂 GONOJI M.
711	今井 忍 IMAI S.	724	村田 真実 MURATA M.
712	山川 太 YAMAKAWA F.		

アドバイザー /Advisors

[U] Program		[J] Program	
U1 } U8	YAMAKAWA F.	SHIBATA Y.	
	IMAI S.	IWAI Y.	
	MATSUMURA K.	NAKATA H.	
	FUJIHIRA M.	IMAI S.	
	MATSUURA K.	SHOJI I.	
	HIBI I.	GONOJI M.	
	NAKATANI S.	IWAI S.	
	SHIMOMURA A.	KOMORI M.	
[M] Program		YAMAKAWA F.	
M1 } M5	TAKAI M.	MATSUMURA K.	
	IWAI S.	SANO M.	
	KOMORI M.	MIZUNO A.	
	MATSUOKA R.	TAKAI M.	
	CIOLCA R.	MURATA M.	
		FUJIHIRA M.	
		MATSUURA K.	
[O] Program			
		FUJIHIRA M.	

発 行 令和 7 年 3 月

Published in March, 2025

編 集 大阪大学日本語日本文化教育センター

Edited by Center for Japanese Language and Culture,
The University of Osaka

〒562-8678 大阪府箕面市船場東 3 丁目 5 番10号

3-5-10, Senba-higashi, Minoh, Osaka

Phone (072) 730-5075, 5072

(日本語日本文化教育センター事務室)

<https://www.cjlc.osaka-u.ac.jp/>

Email cjlc@office.osaka-u.ac.jp