

Intensive Japanese Programs

履修案内

Fall and Winter Terms

2025

令和7年度秋～冬学期



Center for Japanese Language and Culture
The University of Osaka

大阪大学日本語日本文化教育センター

INTENSIVE JAPANESE PROGRAMS

Fall and Winter Terms

2025

Contents

Academic Calendar	v
Academic Calendar Fall and Winter Terms, 2025	v
Intensive Japanese Programs, CJLC	2
1. Types of Programs	2
2. Classes	2
3. Examinations and Academic Record	4
4. Approval of Completion	6
5. Subject Registration	8
6. Operation of the CJLC Office	10
7. CJLC Library Room	12
8. Forms of Certificates	14
9. Cancellation of classes due to weather warnings, disasters, and suspension of public transportation	16
Undergraduate Students Program [U]	20
1. Program Outline	20
2. Requirements for [U] Program Certificate	20
3. Outline of Subjects	22
3-1. Japanese Language Subjects	24
3-2. Required Subjects Other Than Japanese Subjects	26
4. Entrance into University	28
Japanese Studies Program [J]	30
1. Program Outline	30
2. Requirements for [J] Program Certificate	34
3. Outline of Subjects	36
3-1. Required Subjects	36
3-2. Electives	36
4. Extracurricular Activities	48
Maple Program [M]	50
1. Program Outline	50
2. Requirements for [M] Program Certificate	54
3. Outline of Subjects	56
3-1. Required Subjects	56
3-2. Electives	58
4. Extracurricular Activities	70

The University of Osaka Foundation Program [F]	72
1. Program Outline	72
2. Requirements for [F] Program Certificate	74
3. Outline of Subjects	80
3-1. Japanese Language Subjects	80
3-2. Subjects Other Than Japanese Language	88
3-3. Multicultural Community Cohesion Subject	90
List of Classes	92
Weekly Schedule	100
Abbreviations	110
Minoh Campus Map	112
Floor Map	114
Advisors	118

2025 年度 学年暦 Academic Calendar 2025
《Uプログラム (U Program)》

ようび 曜日(Day) 2月(Month)	にち 日 Sun.	げつ 月 Mon.	か 火 Tue.	すい 水 Wed.	もく 木 Thu.	きん 金 Fri.	ど 土 Sat.
2025年 4月 April			1	2	3	4	5
		オリエンテーション			①	①	
	6	7	8	9	10	11	12
	13	① 14	健康診断 15	② 16	② 17	② 18	19
	20	② 21	① 22	② 23	③ 24	③ 25	26
	27	③ 28	昭和の日 29	③ 30			
5月 May					大学祭準備 1	大学祭 2	大学祭 兼施設祭当日 3
	4	大学祭片付 みどりの日 5	こどもの日 6	振替休日 7	④ 8	④ 9	10
	11	④ 12	② 13	④ 14	⑤ 15	⑤ 16	17
	18	⑤ 19	③ 20	⑥ 21	⑥ 22	⑥ 23	24
	25	⑥ 26	④ 27	⑦ 28	⑦ 29	⑦ 30	31
6月 June							
	1	⑦ 2	⑤ 3	⑧ 4	⑧ 5	⑧ 6	7
	8	⑧ 9	⑥ 10	⑨ 11	⑨ 12	⑨ 13	14
	15	⑨ 16	⑦ 17	⑩ 18	⑩ 19	⑩ 20	21
	22	⑩ 23	⑧ 24	⑪ 25	⑪ 26	⑪ 27	28
	29	⑪ 30					
7月 July			⑨ 1	⑪ 2	⑪ 3	⑫ 4	5
	6	⑫ 7	⑩ 8	⑫ 9	⑫ 10	⑬ 11	12
	13	⑬ 14	⑪ 15	⑬ 16	⑬ 17	⑭ 18	19
	20	海の日 21	⑫ 22	⑭ 23	⑭ 24	⑮ 25	26
	27	⑭ 28	⑬ 29	⑮ 30	⑮ 31		
8月 August						補講 1	2
	3	⑮ 4	⑭ 5	6	7	8	9
	10	山の日 11	12	13	14	15	16
	17	18	19	20	21	22	23
	24	25	26	27	28	火曜⑮ 29	30
	31						
9月 September		⑮ 1	⑯ 2	⑯ 3	⑯ 4	⑯ 5	6
	7	⑯ 8	⑰ 9	⑰ 10	⑰ 11	⑰ 12	13
	14	敬老の日 15	⑯ 16	⑱ 17	⑱ 18	⑱ 19	20
	21	⑱ 22	秋分の日 23	⑱ 24	補講 25	⑱ 26	27
	28	⑲ 29	⑲ 30				

ようび 曜日(Day) 2月(Month)	にち 日 Sun.	げつ 月 Mon.	か 火 Tue.	すい 水 Wed.	もく 木 Thu.	きん 金 Fri.	ど 土 Sat.
10月 October				⑳ 1	㉑ 2	㉑ 3	㉑ 4
	5	㉑ 6	㉑ 7	㉑ 8	㉑ 9	㉑ 10	㉑ 11
	12	スポーツの日 13	㉑ 14	㉑ 15	㉑ 16	㉑ 17	㉑ 18
	19	㉑ 20	㉑ 21	㉑ 22	㉑ 23	㉑ 24	㉑ 25
	26	㉑ 27	㉑ 28	㉑ 29	㉑ 30	㉑ 31	
11月 November							大学祭 1
	2	大学祭 文楽の日 3	大学祭片付け 4	㉑ 5	㉑ 6	㉑ 7	㉑ 8
	9	㉑ 10	㉑ 11	㉑ 12	㉑ 13	㉑ 14	㉑ 15
	16	㉑ 17	補講 18	補講 19	㉑ 20	㉑ 21	㉑ 22
	23	勤労感謝の日 24	振替休日 25	㉑ 26	㉑ 27	㉑ 28	㉑ 29
	30						
12月 December		㉑ 1	㉑ 2	㉑ 3	㉑ 4	㉑ 5	㉑ 6
	7	㉑ 8	進学相談/再試 9	進学相談/再試 10	進学相談 11	進学相談 12	㉑ 13
	14	㉑ 15	㉑ 16	㉑ 17	㉑ 18	㉑ 19	㉑ 20
	21	㉑ 22	㉑ 23	㉑ 24	月曜㉑ 25	㉑ 26	㉑ 27
	28	29	30	31			
2026年 1月 January					元日 1	2	3
	4	㉑ 5	㉑ 6	㉑ 7	㉑ 8	㉑ 9	㉑ 10
	11	成人の日 12	㉑ 13	㉑ 14	㉑ 15	㉑ 16	㉑ 17
	18	㉑ 19	㉑ 20	補講 21	補講 22	㉑ 23	㉑ 24
	25	㉑ 26	㉑ 27	㉑ 28	㉑ 29	㉑ 30	㉑ 31
2月 February	1	㉑ 2	㉑ 3	㉑ 4	㉑ 5	㉑ 6	㉑ 7
	8	㉑ 9	㉑ 10	建国記念の日 11	㉑ 12	㉑ 13	㉑ 14
	15	㉑ 16	㉑ 17	㉑ 18	㉑ 19	㉑ 20	㉑ 21
	22	天皇誕生日 23	24	25	26	27	28
3月 March	1	2	3	4	5	6	7
	8	9	修了式 10	11	12	13	14
	15	16	17	18	19	春分の日 20	21
	22	23	24	25	26	27	28
	29	30	31				

はる なつ げつ 2025 春～夏学期 Spring and Summer Terms

4月7日～9日 April 7 - 9	オリエンテーション Orientation
4月15日 April 15	けんこうしん 健康診断 Medical checkup
5月1日～4日 May 1 - 4	だいがくさいじゅんび 大学祭準備、大学祭、大学祭片付け University Festival preparations, University Festival, University Festival clean-up
6月18日～19日 June 18 - 19	けんがくりょこうきょうこう 見学旅行（休講） Study Trip (No Classes)
8月1日、9月25日 August 1, September 25	ほこう 補講 Make-up Classes
8月6日～28日 August 6 - 28	なつやす 夏休み Summer Holidays
8月29日 August 29	かようび 火曜日の授業 Tuesday Classes
9月8日～22日 September 8 - 22	9月試験 September Examination

あき ふゆ 2025 秋～冬学期 Fall and Winter Terms

10月31日 October 31	しんがくせい 進学説明会 Infoemation sessions about Japanese universities
11月1日～4日 November 1 - 4	だいがくさい、だいがくさいかたづけ 大学祭、大学祭片付け University Festival, Festival Clean-up
11月18日、19日 November 18, 19	ほこう 補講 Make-up Classes
11月25日～12月8日 November 25 - December 8	12月試験 December Examination
12月9日～12日 December 9 - 12	しんがくせい 進学相談 / 再試験 Consultation on entrance into university / Make-up Exams
12月25日 December 25	げつようび 月曜日の授業 Monday Classes
1月16日 January 16	きょうこう 休講 No Classes
2月4日、6日～19日 February 4, 6 - 19	さいしゅうしけん 最終試験 Final Examination
2月20日 February 20	さいしけん 再試験 Make-up Examinations
3月10日 March 10	しゅうりょうしき 修了式 Closing Ceremony
	じゅぎょう 授業日 Classes
	ほこう 補講日 Make-up Classes
	しけん 試験日 Examinations

しめくろ 祝日 Public Holidays

4月29日 April 29	しょうわの日 Shōwa Day	8月11日 August 11	やまの山の日 Mountain Day	11月3日 November 3	ぶんかの文化の日 Culture Day	2月11日 February 11	けんこくねんの建国記念の日 National Foundation Day
5月3日、4日、5日、6日 May 3, 4, 5, 6	けんぽうきねんび 憲法記念日、みどりの日、 こどもの日、振替休日 Constitution Memorial Day, Greenery Day, Children's Day Substitute Holiday	9月15日 September 15	けいろの敬老の日 Respect for the Aged Day	11月23日、24日 November 23, 24	きんろうきんしやふりやまきょうじつ 勤労感謝の日、振替休日 Labour Thanksgiving Day, Substitute Holiday	2月23日 February 23	てんのうたんの天皇誕生日 Emperor's Birthday
		9月23日 September 23	しゅうぶん 秋分の日 Autumnal Equinox Day	1月1日 January 1	げんじつ 元日 New Year's Day	3月20日 March 20	しゅんぶん 春分の日 Vernal Equinox Day
7月21日 July 21	うみの海の日 Marine Day	10月13日 October 13	スポーツの日 Sports Day	1月12日 January 12	せいじん 成人の日 Coming-of-age Day		

2025 年度 学年暦 Academic Calendar 2025

《 J/M/F プログラム (J/M/F Program) 》

ようび 曜日(Day) つき 月(Month)	にち 日	げつ 月	か 火	すい 水	もく 木	きん 金	ど 土
2025 年				1	2	3	4
10 月	5	① 6	健康診断 7	① 8	① 9	① 10	11
October	12	スポーツの日 13	① 14	② 15	② 16	② 17	18
	19	② 20	② 21	③ 22	③ 23	③ 24	25
	26	③ 27	③ 28	④ 29	④ 30	大学祭準備 31	
11 月							大学祭 1
November	2	大学祭 3	大学祭後片付け 4	⑤ 5	⑤ 6	④ 7	8
	9	④ 10	④ 11	⑥ 12	⑥ 13	⑤ 14	15
	16	⑤ 17	見学旅行 (休講) 18	⑦ 19	⑦ 20	⑥ 21	22
	23	勤労感謝の日 24	振替休日 25	⑤ 26	⑦ 27	⑦ 28	29
	30						
12 月		⑥ 1	⑥ 2	⑧ 3	⑨ 4	⑧ 5	6
December	7	⑦ 8	⑦ 9	⑨ 10	⑩ 11	⑨ 12	13
	14	⑧ 15	⑧ 16	⑩ 17	⑪ 18	⑩ 19	20
	21	⑨ 22	⑨ 23	⑪ 24	月曜⑩ 25	⑪ 26	27
	28	29	30	31			
2026 年					元日 1	2	3
1 月	4	⑪ 5	⑩ 6	⑫ 7	⑫ 8	⑫ 9	10
January	11	成人の日 12	⑪ 13	⑬ 14	⑬ 15	休講 16	17
	18	⑫ 19	⑫ 20	補講 21	補講 22	⑬ 23	24
	25	⑬ 26	⑬ 27	⑭ 28	⑭ 29	⑭ 30	31
2 月	1	⑭ 2	⑭ 3	⑮ 4	⑮ 5	⑮ 6	7
February	8	⑮ 9	⑮ 10	建国記念日 11		特別授業 13	14
	15	特別授業 16					21
	22	天皇誕生日 23					28
3 月	1						
March	2						
	8		*F修了式 10				
	15					春分の日 20	21
	22						
	29						

あき ふゆがつき 秋～冬学期 Fall and Winter Terms

10月6日～21日	履修登録確認期間 Class Registration Confirmation Period
October 6 - 21	
10月7日	健康診断 Medical checkup
October 7	
10月31日、11月1日～4日	大学祭(準備と片付けを含む) University Festival
October 31, November 1 - 4	(including preparation and cleanup)
11月18日～19日	見学旅行(休講) Study Trip (No Classes)
November 18 - 19	
12月25日	月曜日の授業 Monday Classes
December 25	
12月27日～1月4日	冬休み Winter Holidays
December 27 - January 4	
1月16日	休講 No Classes
January 16	
1月21日、22日	補講 Make-up Classes
January 21, 22	
1月28日～2月10日	学期末試験 Final Examination
January 28 - February 10	
2月13日、16日	特別授業 Special Classes
February 12, 16	
*3月10日	*Fプログラム修了式
*March 10	*F Program Closing Ceremony

<祝日 Public Holidays>

10月13日	スポーツの日 Sports Day
October 13	
11月3日	文化の日 Culture Day
November 3	
11月23日	勤労感謝の日 Labour Thanksgiving Day
November 23	
11月24日	振替休日 Substitute Holiday
November 24	
1月1日	元日 New Year's Day
January 1	
1月12日	成人の日 Coming-of-age Day
January 12	
2月11日	建国記念の日 National Foundation Day
February 11	
2月23日	天皇誕生日 Emperor's Birthday
February 23	
3月20日	春分の日 Vernal Equinox Day
March 20	
	授業日 Classes
	補講日 Make-up Classes
	試験日 Examinations

Intensive Japanese Programs

1. Types of Programs

The Center for Japanese Language and Culture, The University of Osaka, offers various short-term intensive Japanese programs, mainly for Monbu-kagaku-sho (MEXT) scholarship students. They are categorized into the following programs according to the content. Each program is described in detail in its proper section.

- ① Undergraduate Students Program [U] (Classes: between April and March)
- ② Japanese Studies Program [J] (Classes: between October and August)
- ③ Maple Program [M] (Classes: between October and August)
- ④ The University of Osaka Foundation Program [F] (Classes: between October and March)
- ⑤ Osaka-Mahidol Short-term Program in Japanese Language and Culture [O] (Classes: between March and August)

2. Classes

(1) Terms

There are four terms (two semesters) each year: Spring and Summer Terms (Spring Semester) (April 1 to September 30) and Fall and Winter Terms (Fall Semester) (October 1 to March 31 of the following year).

U Program classes are held for 35 weeks per year.

J Program and M Program classes are held for 30 weeks per year – 15 weeks in the spring semester and 15 weeks in the fall semester. F Program classes are held for 15 weeks, only in the fall semester. There are also term courses offered for 8 weeks in the winter term or 8 weeks in the spring term.

(2) Class meeting times

There are five 90-minute time periods, each day from Monday to Friday.

Period	Class meeting times
1st Period	8 : 50 a.m. – 10 : 20 a.m.
2nd Period	10 : 30 a.m. – 12 : 00 p.m.
3rd Period	1 : 30 p.m. – 3 : 00 p.m.
4th Period	3 : 10 p.m. – 4 : 40 p.m.
5th Period	4 : 50 p.m. – 6 : 20 p.m.

(3) Credit hours

According to the type of course, credit hours are prescribed as follows:

Category	Lecture/Seminar		Category	Recitation	
Credit hours	Class: 15 credit hours	Private study: 30 credit hours	Credit hours	Class: 30 credit hours	Private study: 15 credit hours

(4) Cancellation of classes

Cancellation of a class will be announced on the bulletin board near the CJLC Office. Be sure to check the bulletin board before attending a class.

When the instructor in charge does not appear in the classroom within 30 minutes from the start time of the class and there is no cancellation notice on the bulletin board, please contact the CJLC Office and follow its instructions.

Classes may be cancelled when public transportation service is suspended or a storm warning as well as an emergency warning are issued. Please refer to the Guidelines for Cancellation of Classes due to weather warnings, disasters, and suspension of public transportation (see p.16) to see whether classes will be cancelled.

(5) Supplementary classes

Supplementary classes may be held to make up for a delay in progress or a cancelled class. Information on supplementary classes will be given directly by the instructor in charge and posted on the bulletin board.

3. Examinations and Academic Record

(1) Examinations

Evaluation methods include written and oral examinations, reports, papers, practical and other examinations. For some courses, the rate of attendance and marks in unscheduled examinations are also reflected in grading, or substituted for marks in scheduled examinations. For the evaluation method of each course, see the volume Syllabus through KOAN.

● Matters to note regarding examinations

- ① Information on scheduled examinations will be posted on the bulletin board or made an oral announcement from the instructor in charge.
- ② If you appear in the classroom later than 30 minutes from the start time of the examination, you will not be allowed to take the examination. Be careful not to be late for an examination. Students may leave the classroom 45 minutes from the start time of an examination.
- ③ If a student is caught cheating or doing other unfair conduct in an examination, he/she should immediately stop the test, and his/her registration for the subject will be cancelled. Students guilty of unfair conduct will be subjected to disciplinary action in accordance with the school regulations.
- ④ Taking an examination in a subject for which you have not been registered will not receive credit.

(2) Grading

Achievement in each subject is evaluated as Grade S, A, B, C, or F as shown in the table below:

Assessment	Passed				Failed
Grade	S	A	B	C	F
Score (out of 100)	100-90 scores	89-80 scores	79-70 scores	69-60 scores	59-0 scores

(3) Notification of grades

The grades in subjects for which students have registered are notified by Transcript/Academic Record to each student after the closing ceremony.

4. Approval of Completion

(1) Requirements for a certificate

It is necessary to complete all the subjects required in the program. For details, such as the titles of subjects and the numbers of required subjects and electives, see the each program outline given later.

The approval/disapproval of completion of courses is announced in September for the August and summer terms and in March for the fall and winter terms.

(2) Certificate of Completion

Certificates will be issued to students who satisfy all the requirements for completion of the program in the prescribed manner.

5. Subject Registration

(1) Placement: Evaluation of degree of proficiency in Japanese

To register for the subjects offered by the CJLC, students need to be evaluated for their degree of proficiency in Japanese. The evaluation is done through a placement test. You can take grammar, Kanji and composition test at the CJLC website. For more information of the placement test will be notified by Email.

(2) Orientation Sessions by Program

Before or at the beginning of each term, the orientation sessions by program will be held. All the students are required to attend the orientation to take classes in each program. The schedule and location of Orientation Sessions by program will be announced by Email.

(3) Registration

Subject registration questionnaire will be conducted every term.

If you fail to register for a subject, you will not be graded for the subject or considered to have completed the subject, even if you attend the class. Any corrections in the subject registration forms should be made within the registration period. Take care in preparing and submitting your registration form.

The last day of the registration period is usually about two weeks after the beginning of classes.

● Matters to note regarding subject registration

- ① You cannot register for a course which is not a designated subject.
- ② For some subjects, students are allowed to register for designated courses only. At the Orientation Sessions by Program mentioned in section (2) above, information will be given about important matters in registration. Be sure to pay attention to this information and follow the instructions in registering for subjects.
- ③ After the deadline of the subject registrations, double-check that all requirements have been completed. If there are any corrections, you must let CJLC office know immediately.

(4) Paper of completion course

In some programs/courses, students are required to submit a paper for completion of the course. In accordance to the instructions in the each program outline given later, submit the paper by the deadline.

6. Operation of the CJLC Office

(1) Office hours

The location and office hours of the CJLC Office are as follows :

※ Monday-Friday (holidays excluded)

Location	7th floor, Center for Japanese Language and Culture Office	
Office hours	a.m.	10:00 - 11:30
	p.m.	12:30 - 4:30

N.B. Unscheduled closures or changes in the office hours will be announced on the bulletin board.

(2) Communication of curriculum-related information

All curriculum-related information, such as on classes and examinations, will be communicated through the bulletin board or Email. Be sure to check the bulletin board and Email near the office of the CJLC Office before attending a class.

(3) Certificates

For student-related certificates, apply to the CJLC Office, using a Request for Certificate form. A certificate will be issued seven days from the date of application, as a rule. Around the end of the semester (March), when many students make applications, it may take 10 days or so.

Regarding the main student-related certificates issued at the CJLC Office, please refer to page 14.

- ① Transcript / Academic Record
- ② Certificate of Program Completion
- ③ Enrollment Certificate

7. CJLC Library Room

The CJLC Library Room can be found on the 7th floor. The "LIBRARY CARD" is necessary in order to enter the room. In addition to general books, you will find various textbooks as well as workbooks on learning Japanese, and there is an area where students can study while listening to CDs that come with these books.

Regarding Japanese literature material, the library room facilitates equipment for viewing audio visual material: genres ranging from entertainment, movies, drama, to anime and so on. In order to find the material that you want to use, search the "Japanese Literature Data and Audio Visual Materials Database" found on the CJLC website. Students can use the computers and printers in the CJLC Library Room.

The CJLC Library Room is open from Monday through Friday, 10:00-11:30, 12:30-16:20 (holidays excluded).

(Note) The CJLC Library Room will be closed temporarily on an as-needed basis.

8. Forms of Certificates

①- 1 For U Program

No. _____

TRANSCRIPT

(Government Sponsored Foreign Student)

Institution	Center for Japanese Language and Culture			Admission :	
				Completion :	
Nationality		Name		Date Of Birth	
ID Number				Sex	

Curriculum Class Evaluation				
Curriculum Class			Grade	Hrs Per Week
Japanese Language	Listening			
	Reading			
	Grammar			
	Kanji			
	Oral Presentation			
	Composition			
	Japanese Cultural Background			
Humanities	English			
	Political Science and Economics			
	Japanese History			
	Mathematics(Elective)			
Natural Science	Mathematics			
	Chemistry			
	Physics			
	Biology			

Grading Scale
S : 90 ~ 100
A : 80 ~ 89
B : 70 ~ 79
C : 60 ~ 69
F : 0 ~ 59
N/A : Not Applicable

M/D/YYYY

OFFICIAL SEAL OF

Center for Japanese Language and Culture

The University of Osaka

Director

Center for Japanese Language and Culture

The University of Osaka

①-2 For other Programs

SUBJECT	Credits	Year	Grade
(. )			

Under: S-120-85, S-69-85, S-79-75, C-69-65, P-Pass, Americanization

[Subjects under Academic Major (Major Subjects/Advanced Global Literacy Education) are categorized as Major Subjects.
[Subjects under Global Literacy (Advanced Global Literacy Education)/Major Subjects] are categorized as Advanced Global Literacy Education.
Leading is shorthand for "Program for Leading Graduate Schools".]

This is to certify that the above record is true and correct.

President of The University of Osaka

Official Seal of
The University of Osaka

Date:

② Certificate of Program Completion

CERTIFICATE	
Program :	
Period of Attendance :	
Status :	
Name :	
Sex :	
Date of Birth :	
Country :	
Date of Graduation :	
This is to certify that the above record is true and correct.	
OFFICIAL SEAL OF Center for Japanese Language and Culture The University of Osaka	
_____ Director Center for Japanese Language and Culture The University of Osaka	

③ Enrollment Certificate

C E R T I F I C A T E

Name:

Date of Birth:

Date of Enrollment:

This is to certify that the above record is true and correct.

President of The University of Osaka

Official Seal of
The University of Osaka

9. Cancellation of classes due to weather warnings, disasters, and suspension of public transportation

- As a general rule, online classes (including regular examinations) will still be held under severe weather warnings.
- However, if circumstances make it difficult to hold online classes, departments may decide to cancel classes. You will be notified via KOAN if classes have been cancelled.
- If you live in/commute through an area which has been issued a storm warning/emergency warning or has experienced an earthquake with a seismic intensity (*shindo*) of 5+ or higher and you will not be able to attend online classes due to evacuation and/or evacuation preparations, your department will make arrangements to prevent any penalties with regards to your studies, so please contact the academic affairs section of your department.

(1) Cancellation of classes after issuance of weather warnings

If a “Storm Warning (暴風警報)” or an “Emergency Warning* (特別警報)” is issued for the region including Toyonaka, Suita, Ibaraki, and Minoh cities, classes will be cancelled. If either of these warnings are issued during a class, classes will be cancelled beginning with the next class.

*Classes will be cancelled for an issuance of *any type* of Emergency Warning (特別警報).

(2) Cancellation of classes during suspension of public transportation

If service of one or more of the following lines of public transportation has been suspended (including partial suspension) due to a disaster, natural or man-made, classes held on the campus(es) affected by this suspension will be cancelled.

① Toyonaka Campus	Hankyu Railway (Takarazuka Line: Osaka-umeda – Takarazuka) or Osaka Monorail (all lines)
② Suita Campus	Hankyu Railway (Senri Line: Osaka-umeda/Tenjinbashisujirokuchome – Kita-senri) or Osaka Monorail (all lines)
③ Minoh Campus	Osaka Metro (Midosuji Line (including Kita-Osaka Kyuko line): Umeda – Minoh-kayano) or Osaka Monorail (all lines)

However, classes will not be cancelled for temporary suspension of train and/or bus service due to traffic accidents, etc.

(3) Lifting of weather warnings and/or resumption of public transportation service

If weather warnings are lifted or public transportation services have resumed, classes will be held according to the following chart:

If the warning is lifted or transportation service is resumed...	classes will be...
before 6 am	held all day
after 6 am but before 9 am	held in the afternoon
after 9 am or not at all	cancelled all day

*Confirmation of lifting of weather warnings and/or resumption of public transportation service will be conducted via television, radio, and the internet.

(4) Cancellation of classes following an earthquake

If an earthquake with a strength of 5-upper on the Japanese intensity scale is recorded in the cities of Toyonaka, Suita, Ibaraki, and/or Minoh in Osaka Prefecture, classes for that day will be cancelled. If the earthquake is recorded at 5:15 pm or later, classes for the following day will also be cancelled.

In addition, if an earthquake with a strength of 5-upper is recorded outside of the areas listed above or if an earthquake with a strength of less than 5-upper is recorded in the areas listed above, the guidelines in section 2 regarding cancellation of classes due to suspension/stoppage of public transportation service will apply.

(5) Cancellation of classes due to evacuation orders/emergency safety measures

If an evacuation order or emergency safety measures are issued in the cities of Toyonaka, Suita, Ibaraki, and/or Minoh in Osaka Prefecture, classes may be cancelled in departments located in these areas, so follow the instructions provided by your department.

(6) Other notes

*Even if your classes are not cancelled for any of the reasons listed above, if you were not able to attend class due to inevitable reasons, for example, your residence and/or route to the university has had:

- (a) weather warnings listed in (1) issued,
 - (b) an earthquake with the attributes outlined in (4), and/or
 - (c) public transportation services outside of those delineated in (2) suspended,
- the university will take special consideration to avoid any detriment to you in your studies, so please contact the student affairs staff in the department in which your class is held and/or the student affairs staff in your department.

*If weather warnings, suspension of public transportation, and/or evacuation orders are anticipated, or classes must be cancelled for any other reason, the university will make an announcement via The University of Osaka Official Homepage or KOAN.

Maple Program [M]

1. Program Outline

The Maple Program (The University of Osaka Intensive Japanese Language and Culture Program for Exchange Students) is a short-term student exchange program of The University of Osaka hosted by the Center for Japanese Language and Culture (CJLC).

This one-year program (arrival in Japan in September, classes held from October to August of the following year) is designed to help students improve their Japanese language skills as well as enhance their knowledge of Japanese culture and society, moving them further towards their respective academic goals. Moreover, it aims to cultivate the human resources required to deeply understand Japan from various perspectives by giving students the academic tools to compare and contrast Japanese language, culture and society with their own, and then share that knowledge widely.

A faculty advisor is assigned by the CJLC to each student enrolled in the program to provide advice regarding subject registration and other academic activities.

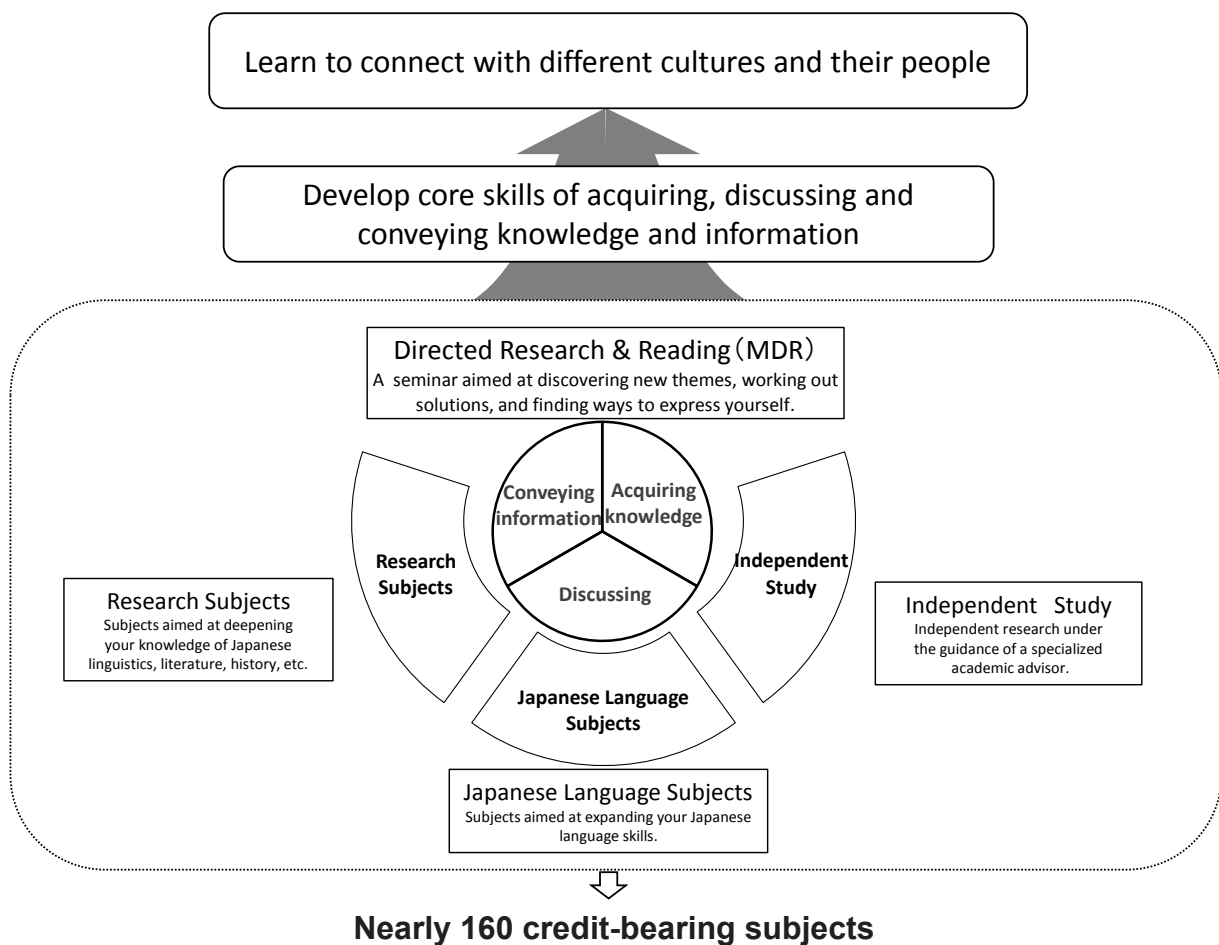

Course information

The Maple Program features four courses: Pre-intermediate, Intermediate, Upper-intermediate and Advanced. Students are placed in one of these four courses based on the results of a preliminary placement test.

Pre-intermediate Course

This course is designed for students evaluated to be within the CJLC's A2 range of Japanese language proficiency. Students learn Japanese language and culture through a range of activities conducted in "Directed Research & Reading" and further refine their grammar and vocabulary through the courses "Pre-intermediate Japanese α : Grammar & Vocabulary" and "Pre-intermediate Japanese β : Grammar & Vocabulary." Students may choose elective classes from both the Pre-intermediate and Intermediate course levels.

Intermediate Course

This course is designed for students evaluated to be within the CJLC's B1 range of Japanese language proficiency. Students learn Japanese language and culture through a range of activities conducted in "Directed Research & Reading" and further refine their grammar and vocabulary through the courses "Intermediate Japanese α : Grammar & Vocabulary" and "Intermediate Japanese β : Grammar & Vocabulary." In addition to classes offered at the Intermediate course level, students may take elective classes from both the Pre-intermediate and Upper-intermediate course levels.

Upper-intermediate Course

The Upper-intermediate Course is intended for students evaluated to be within the CJLC's B2 range of Japanese language proficiency. Students learn Japanese language and culture through a range of activities conducted in "Directed Research & Reading." In addition to classes offered at the Upper-intermediate course level, students may take elective classes from both the Intermediate and Advanced course levels.

Advanced Course

The Advanced Course is designed for students evaluated to be within the CJLC's C1 range of Japanese language proficiency. Students learn Japanese language and culture through a range of activities conducted in "Directed Research & Reading." Advanced Course students may choose elective classes from the Upper-intermediate and Advanced course levels.

2. Requirements for [M] Program Certificate

To complete the program, students must earn 30 or more credits in a year.

Category	Course	Credits	Requirements for completion
Required	Directed Research & Reading (MDR)	2 credits each	30 or more credits in a year
Electives	Research Subjects		
	Independent Study (MIS)		
Required (Pre-intermediate Japanese Course)	Pre-intermediate Japanese α : Grammar & Vocabulary (MGV)	4 credits	
	Pre-intermediate Japanese β : Grammar & Vocabulary (MGV)	2 credits	
Required (Intermediate Japanese Course)	Intermediate Japanese α : Grammar & Vocabulary (MGV)	4 credits	
	Intermediate Japanese β : Grammar & Vocabulary (MGV)	2 credits	
Electives	Japanese Language Subjects	1 credit each	
	Multicultural Community Cohesion Subject (MCC)*		

* “Multicultural Community Cohesion Subject” is a term subject.

※ With their academic advisor’s permission, students may substitute an elective course for Pre-intermediate Japanese α/β : Grammar & Vocabulary and Intermediate Japanese α/β : Grammar & Vocabulary.

3. Outline of Subjects

The Maple Program offers the following subjects: Directed Research & Reading (MDR), Japanese Language Subjects (L), Pre-Intermediate Japanese α/β : Grammar & Vocabulary (MGV), Intermediate Japanese α/β : Grammar & Vocabulary (MGV), Research Subjects in Japanese Studies (R), Independent Study (MIS), and Multicultural Community Cohesion Subject (MCC).

3-1. Required Subjects

All Maple Program students are required to take “Directed Research & Reading.” Students in the Pre- intermediate Course or Intermediate Course are additionally required to take “Pre-intermediate Japanese (α/β): Grammar & Vocabulary” or “Intermediate Japanese (α/β): Grammar & Vocabulary.”

① **【Directed Research & Reading】 (MDR)**

This seminar stimulates comprehensive understanding of Japanese language and culture. By experiencing Japanese culture and society first-hand by going on field trips, and by participating in project-based learning guided by teaching assistants (graduate students), you will come closer to this seminar’s ultimate goal: a comprehensive understanding of Japanese language, culture, and society. To ensure effective and smooth communication, we will focus on the development of three key skills: acquiring knowledge, conveying information, and discussion.

② **【Pre-intermediate Japanese α/β : Grammar & Vocabulary】 (MGV)**

These courses are for students evaluated to be within the CJLC’s A2 range of Japanese language proficiency. The goal of these courses is to improve students’ knowledge of grammar and vocabulary as well as increase their range of practical fluency. Based on the results of a placement examination, students will be required to take either both Pre-intermediate Japanese α (4 units per week) and Pre-intermediate Japanese β (2 units per week), or Pre-intermediate Japanese α alone.

③ **【Intermediate Japanese α/β : Grammar & Vocabulary】 (MGV)**

These courses are for students evaluated to be within the CJLC’s B1 range of Japanese language proficiency. The goal of these courses is to improve students’ knowledge of grammar and vocabulary as well as increase their range of practical fluency. Based on the results of a placement examination, students will be required to take either both Intermediate Japanese α (4 units per week) and Intermediate Japanese β (2 units per week), or Intermediate Japanese α alone.

3-2. Electives

There are three categories of elective class: ① **【Japanese Language Subjects】**, ② **【Research Subjects】**, ③ **【Independent Study】**, ④ **【Multicultural Community Cohesion Subject】**.

For detailed information on classes available each semester, please refer to List of Classes.

① **【Japanese Language Subjects】**

Participating students select from a broad range of elective subjects matched to their individual proficiency level. These include Reading (RDG), Listening (LIS), Writing (WRT), Speaking (SPK), Grammar & Vocabulary (GV), and Kanji & Vocabulary (KV) and are offered at the Pre-intermediate, Intermediate, Upper-intermediate and Advanced course levels.

Japanese Pre-intermediate Reading (RDG)

For A2 students who can:

- understand the Japanese alphabet and basic passages about daily-life situations (for example: pamphlets, schedules, menus, short e-mails, and private letters).

Japanese Pre-intermediate Listening (LIS)

For A2 students who can:

- comprehend audio in daily situations, such as simple short messages or announcements.

Japanese Pre-intermediate Writing (WRT)

For A2 students who can:

- write short messages or memos on daily matters;
- write brief private e-mails.

Japanese Pre-intermediate Speaking (SPK)

For A2 students who can:

- explain daily matters using elementary words, phrases and sentences;
- conduct brief social exchanges with others.

Japanese Pre-intermediate Grammar & Vocabulary (GV)

For A2 students who can:

- understand basic, commonly-used words within elementary vocabulary;
- understand expressions written in basic sentence patterns.

Japanese Pre-intermediate Kanji & Vocabulary (KV)

For A2 students who can:

- read and write basic kanji commonly-used in daily life;
- understand basic and commonly-used kanji expressions.

Japanese Intermediate Reading (RDG)

For B1 students who can:

- comprehend passages written about daily matters or a topic of their interest, for example, newspaper articles or private letter exchanges.

Japanese Intermediate Listening (LIS)

For B1 students who can:

- comprehend audio about daily matters or a topic of their interest, such as weather forecasts or train station announcements.

Japanese Intermediate Writing (WRT)

For B1 students who can:

- write a short essay about their daily life or a topic of their interest;
- write a short letter or e-mail;
- write a cohesive text using basic words and expressions.

Japanese Intermediate Speaking (SPK)

For B1 students who can:

- make a speech about their daily life or a topic of their interest while using tense correctly;
- express their views using subordinate sentences;
- participate in one-to-one conversation;
- pronounce words without causing misunderstandings.

Japanese Intermediate Grammar & Vocabulary (GV)

For B1 students who can:

- understand most elementary vocabulary;
- understand expressions using basic sentence patterns.

Japanese Intermediate Kanji & Vocabulary (KV)

For B1 students who can:

- read and write basic kanji;
- understand basic kanji expressions.

Japanese Upper-intermediate Reading (RDG)

For B2 students who can:

- understand somewhat technical contents within their field of specialty, including introductory textbooks or lecture materials;
- read modern novels;
- infer the meaning of an unfamiliar word;
- read and understand the stance and opinion of the author.

Japanese Upper-intermediate Listening (LIS)

For B2 students who can:

- understand somewhat technical contents in a long conversation or a lecture within their field of specialty;
- understand news, broadcasts, current events or movies;
- infer the meaning of an unfamiliar word.

Japanese Upper-intermediate Writing (WRT)

For B2 students who can:

- write a report relating to their field of specialty;
- write an article or a report given enough time;
- distinguish fact from their own opinion;
- create paragraphs while considering essay structure;
- write a cohesive text.

Japanese Upper-intermediate Speaking (SPK)

For B2 students who can:

- present a speech about their field of specialty clearly and in detail;
- present their research findings with enough preparation;
- distinguish fact from their own opinion;
- actively engage in a conversation;
- speak fluently to a certain extent.

Japanese Upper-intermediate Grammar & Vocabulary (GV)

For B2 students who can:

- understand fundamental vocabulary relating to their field of specialty;
- understand expressions using somewhat high-level sentence patterns.

Japanese Upper-intermediate Kanji & Vocabulary (KV)

For B2 students who can:

- read and write somewhat high-level commonly-used kanji;
- understand commonly-used kanji expressions in addition to somewhat high-level kanji expressions within their field of specialty.

Japanese Advanced Reading (RDG)

For C1 students who can:

- understand texts from various fields written in standard Japanese;
- understand an introductory book even if it is not of their field of specialty;
- understand a technical book, an article or lecture material of a high level if it is of their field of specialty;
- understand the part of a text emphasized by the author.

Japanese Advanced Listening (LIS)

For C1 students who can:

- understand topics from various fields spoken in standard Japanese;
- understand a basic-level lecture even if it is not of their field of specialty;
- understand a higher-level lecture of their field of specialty;
- enjoy most TV programs or movies without any special effort;
- grasp the flow of a conversation with more than three participants.

Japanese Advanced Writing (WRT)

For C1 students who can:

- write a somewhat technical article or report about subjects from various fields;
- write a cohesive text;
- put an emphasis on their opinion in the text.

Japanese Advanced Speaking (SPK)

For C1 students who can:

- present a speech containing somewhat technical content about subjects from various fields;
- coherently present an argument from a single perspective;
- participate in conversations while cooperating with other participants;
- express themselves fluently.

Japanese Advanced Grammar & Vocabulary (GV)

For C1 students who:

- understand fundamental vocabulary within a variety of fields;
- understand the highest level sentence patterns necessary for any social situation.

Japanese Advanced Kanji & Vocabulary (KV)

For C1 students who:

- read and write almost all kanji used in daily life;
- understand almost all kanji expressions necessary for conducting any social situation;
- understand higher-level kanji expressions if it is of their field of specialty.

② 【Research Subjects】

These subjects offer students the opportunity to pursue academic knowledge in their field. Through language and language education, as well as the study of literature, history, sociology and Japanese thought, students acquire a contrastive perspective of Japanese culture and discuss content learned in class. Classes are conducted in Japanese, with some classes conducted in English.

The following classes are offered: Japanese Linguistics, Japanese Language Education, Japanese Thought, Japanese History, Japanese Literature, Japanese Contemporary Culture, and Japanese Social Sciences.

For each Research Subject, there is an introductory course (“Introduction to XX”) that provides foundational knowledge in the subject concerned while taking into consideration students’ practical ability.

Japanese Linguistics (LIN)

Students analyze various characteristics of the Japanese language from a linguistic perspective. This involves the subfields of phonetics and phonology, morphology and syntax, pragmatics and semantics, typology, contrastive linguistics, social linguistics, and the history of Japanese.

Japanese Language Education (EDU)

This subject provides students with the requisite knowledge and perspective used in examining various aspects of Japanese language education. This includes basic knowledge of Japanese language education, second language acquisition and language pedagogy. Students learn to apply knowledge from related fields such as linguistics and Japanese linguistics in order to deepen their understanding of language education.

Japanese Thought (THO)

This subject examines Japanese thought through disciplines such as religious studies, folkloristics, and cultural anthropology. Students investigate Japanese culture and society from a historical perspective, looking closely at aspects of traditional Japanese culture such as annual festivals and functions.

Japanese History (HIS)

This subject teaches Japanese history spanning from ancient to modern times. Students explore topics in Japanese society and Japanese culture through the lens of Japanese history. This includes cultural history, as well as practices like Japanese calligraphy and tea ceremony.

Japanese Literature (LIT)

This subject teaches Japanese classical literature, dating from the Nara period to the Edo period, as well as modern and contemporary literature, written from the Meiji period onward. This subject deals also with literary history and criticism, as well as traditional Japanese performing arts.

Japanese Contemporary Culture (CON)

This subject teaches contemporary and modern Japanese culture as well as research methodology. Students familiarize themselves with cultural characteristics, historical trends and current problems facing Japanese society. Knowledge of research methods used in sociology and comparative culture deepens students' understanding of cultural research.

Japanese Social Sciences (SOC)

This subject examines Japanese society from a sociological perspective, considering politics, economics and management, including discussion of international relations. Students deepen their understanding of Japanese society through investigations of current affairs and historical analyses.

③ 【Independent Study】 (MIS)

In Independent Study, students read and interpret primary sources they have gathered in Japan and conduct investigative research. Students acquire deeper knowledge of Japanese language and culture through self-directed data collection and analysis, under the guidance and instruction of a supervisor. In order to enroll in the course, students must pass a review based on document submission and an interview exam.

④ 【Multicultural Community Cohesion Subject】 (MCC)

This subject seeks to strengthen exchanges between students and local residents through participation in community development initiatives (まちづくり) alongside local partners, with the objective of realizing a multicultural and cohesive society. The students will plan and manage exchange activities aimed at understanding and accepting the diverse people living in the area, while also building the community together.

This is a term subject designed so that the learning process is completed by enrolling in both the “Multicultural Community Cohesion (Winter)” intensive course in the winter term and the “Multicultural Community Cohesion (Spring)” course in the spring term.

4. Extracurricular Activities

To improve students' Japanese language skills and to deepen their understanding of Japanese language, culture and society, the CJLC plans various activities on and off campus.

- (1) As part of Directed Research and Reading, educational field trips are scheduled for locations in the vicinity. These trips are intended to provide students with an immersive experience of Japanese society and culture.
- (2) The CJLC plans tours of places of interest for students to help them better understand Japanese history, folklore, economy and business management.
- (3) The CJLC also offers opportunities to view Japanese traditional performing arts, such as *kabuki* and *bunraku*, in order to help students deepen their understanding of Japanese art and culture.
- (4) Students enrolled in the “Multicultural Community Cohesion” Subject can participate in planning and managing “No Border Fest in Minoh”, an event organized in collaboration with the community with the objective of strengthening exchanges with local residents.
- (5) To experience the culture of Japanese daily life, students may participate in the host family program and other events organized or introduced by The University of Osaka Center for International Education and Exchange (5th floor, Minoh Campus).

※ Various activities are organized in addition to those listed above. Detailed information will be posted on the bulletin board near the CJLC Office or CJLC Library Room.

授 業 一 覧

List of Classes

※授業の詳しい内容は KOAN を見てください。

See KOAN for details of each subject.

M Code	J Code	Category	Day・Period	Program	Level	Type	種別	授業科目名	Instructor(s)	教員	サブタイトル／授業テーマ
J/M/F (A2) Japanese Language Subjects											
日本語実習科目											
1	395010	RDG	Mon. 3	J/M/F	A2	Rec.	実習	日本語初中級読解(秋冬)	TANAKA, Y.	田中泰子	音読と理解の基礎練習
2	395015	LIS	Wed. 3	J/M/F	A2	Rec.	実習	日本語初中級聴解(秋冬)	MIYAZAKI	宮崎さとみ	音声による言葉の認識と理解の基礎練習
3	395020	WRT	Thu. 4	J/M/F	A2	Rec.	実習	日本語初中級文章表現(秋冬)	ATSUTA	熱田万美	書き言葉と話し言葉
4	395025	SPK	Thu. 3	J/M/F	A2	Rec.	実習	日本語初中級口頭表現(秋冬)	MITO	三登由利子	描写・説明
5	395055	GV	Wed. 4	J/M/F	A2	Rec.	実習	日本語初中級文法・語彙(秋冬)	DUONG, T.	ズオン, T.	基本文型の整理と完成
6	395030	KV	Fri. 3	J/M/F	A2	Rec.	実習	日本語初中級漢字・語彙(秋冬)	HIGUCHI	樋口尊子	身近な漢字語彙
J/M/F (B1) Japanese Language Subjects											
日本語実習科目											
7	395036	RDG	Wed. 1	J/M/F	B1	Rec.	実習	日本語中級読解(秋冬)	MATSUZAKI	松崎かおり	速読の練習
8	395037	RDG	Thu. 1	J/M/F	B1	Rec.	実習	日本語中級聴解(秋冬)	YAMASHITA	山下春菜	速読の練習
9	395038	RDG	Fri. 1	J/M/F	B1	Rec.	実習	日本語中級読解(秋冬)	JIN	金珠	音読と理解の発展練習
10	395040	LIS	Mon. 3	J/M/F	B1	Rec.	実習	日本語中級聴解(秋冬)	KYOTANI	京谷麻矢	フォーマル・カジュアルな場における対話の聴解
11	395041	LIS	Wed. 2	J/M/F	B1	Rec.	実習	日本語中級文章表現(秋冬)	HATANO	波多野吉徳	身の回りの日本語を聞く
12	395045	WRT	Wed. 4	J/M/F	B1	Rec.	実習	日本語中級文法・語彙(秋冬)	WADA	和田亜矢子	書くために必要なこと
13	395046	WRT	Thu. 3	J/M/F	B1	Rec.	実習	日本語中級文章表現(秋冬)	NAMBA	南場尚子	まとまりのある文章を書く
14	395050	SPK	Mon. 1	J/M/F	B1	Rec.	実習	日本語中級口頭表現(秋冬)	ARASHIMA	荒島和子	交渉会話・交流会話
15	395051	SPK	Thu. 4	J/M/F	B1	Rec.	実習	日本語中級口頭表現(秋冬)	KAI	甲斐朋子	描写・説明
16	395056	GV	Wed. 3	J/M/F	B1	Rec.	実習	日本語中級文法・語彙(秋冬)	DUONG, T.	ズオン, T.	類似表現の整理と使い分け
17	395057	GV	Thu. 5	J/M/F	B1	Rec.	実習	日本語中級文法・語彙(秋冬)	KIM	金吉任	類似表現の整理と使い分け
18	395060	KV	Tue. 1	J/M/F	B1	Rec.	実習	日本語中級漢字・語彙(秋冬)	DUONG, T.	ズオン, T.	語構成から学ぶ漢語
19	395062	KV	Wed. 5	J/M/F	B1	Rec.	実習	日本語中級漢字・語彙(秋冬)	WADA	和田亜矢子	漢語と和語での類義表現
20	395064	KV	Fri. 3	J/M/F	B1	Rec.	実習	日本語中級漢字・語彙(秋冬)	WATANABE, A.	渡邊あやめ	大学生生活に必要な漢字語彙

M Code	J Code	Category	Day・Period	Program	Level	Type	種別	授業科目名	Instructor(s)	教員	サブタイトル/授業テーマ
J/M/F (B2) Japanese Language Subjects											
日本語実習科目											
21	395005	RDG	Mon. 1	J/M/F	B2	Rec.	実習	日本語中上総読解(秋冬)	WADA	和田亜矢子	現代社会に関連した文章の読解
22	395006	RDG	Tue. 1	J/M/F	B2	Rec.	実習	日本語中上総読解(秋冬)	SUMIDE	角出凱紀	専門性のある文章の読解
23	395007	RDG	Wed. 4	J/M/F	B2	Rec.	実習	日本語中上総読解(秋冬)	HIROKAWA	廣川直幸	比較文学の読解の練習
24	395008	RDG	Thu. 1	J/M/F	B2	Rec.	実習	日本語中上総読解(秋冬)	TANAKA.S.	田中里美	日本語・日本文化を題材とした文章の読解
25	395009	RDG	Thu. 3	J/M/F	B2	Rec.	実習	日本語中上総読解(秋冬)	MASHITA	真下森子	現代社会に関連した文章の読解
26	395070	RDG	Fri. 2	J/M/F	B2	Rec.	実習	日本語中上総読解(秋冬)	FURUTA	古田朋子	施設等学習用書籍の速読ストラテジー
27	395071	LIS	Mon. 2	J/M/F	B2	Rec.	実習	日本語中上総読解(秋冬)	WADA	和田亜矢子	日本社会を題材とした独話・対話の読解
28	395072	LIS	Mon. 4	J/M/F	B2	Rec.	実習	日本語中上総読解(秋冬)	KAWASHIMA	川島信恵	日常的な話題・場面の対話や独話の読解
29	395073	LIS	Tue. 1	J/M/F	B2	Rec.	実習	日本語中上総読解(秋冬)	KIDA	木田則子	複数人の会話を聞く技術
30	395074	LIS	Thu. 2	J/M/F	B2	Rec.	実習	日本語中上総読解(秋冬)	NAMBA	南場尚子	複数人の会話を聞く技術
31	395075	LIS	Thu. 5	J/M/F	B2	Rec.	実習	日本語中上総読解(秋冬)	ATSUTA	熱田万美	時事的な話題の独話・対話の読解
32	395076	LIS	Fri. 1	J/M/F	B2	Rec.	実習	日本語中上総読解(秋冬)	SHINJO	新庄あいみ	様々なタイプの話者による独話・対話の読解
33	395375	WRT	Mon. 1	J/M/F	B2	Rec.	実習	日本語中上総文章表現(秋冬)	KURODA	黒田真代	自然な日本語を書くためのトレーニング
34	395376	WRT	Mon. 4	J/M/F	B2	Rec.	実習	日本語中上総文章表現(秋冬)	KOMORI	小森万里	アカデミック・ライティングの基礎
35	395377	WRT	Wed. 1	J/M/F	B2	Rec.	実習	日本語中上総文章表現(秋冬)	KITAGAWA	北川美香	自然な日本語を書くためのトレーニング
36	395378	WRT	Wed. 5	J/M/F	B2	Rec.	実習	日本語中上総文章表現(秋冬)	HIROKAWA	廣川直幸	様々な文書作成の基本
37	395379	WRT	Thu. 2	J/M/F	B2	Rec.	実習	日本語中上総文章表現(秋冬)	NONAKA	野中篤	書評を書く
38	395380	WRT	Thu. 5	J/M/F	B2	Rec.	実習	日本語中上総文章表現(秋冬)	OKUNO	奥野紗衣	レポート・小論文の日本語
39	395080	SPK	Mon. 2	J/M/F	B2	Rec.	実習	日本語中上総口頭表現(秋冬)	MATSUSHIMA	松島弘枝	交渉会話
40	395081	SPK	Wed. 2	J/M/F	B2	Rec.	実習	日本語中上総口頭表現(秋冬)	TANAKA.M.	田中舞	描写・説明
41	395082	SPK	Thu. 3	J/M/F	B2	Rec.	実習	日本語中上総口頭表現(秋冬)	TANAKA.MA.	田中真衣	関係構築のための日本語会話
42	395083	SPK	Fri. 2	J/M/F	B2	Rec.	実習	日本語中上総口頭表現(秋冬)	MATSUZAKI	松崎かおり	スピーチ/プレゼンテーション
43	395084	SPK	Fri. 3	J/M/F	B2	Rec.	実習	日本語中上総口頭表現(秋冬)	ATARASHI	新聖子	交流会話
44	395385	GV	Mon. 3	J/M/F	B2	Rec.	実習	日本語中上総文法・語彙(秋冬)	ISHIBASHI	石橋玲央	接続表現・副詞句
45	395386	GV	Tue. 2	J/M/F	B2	Rec.	実習	日本語中上総文法・語彙(秋冬)	SUMIDE	角出凱紀	文章を通して学ぶ表現・語彙
46	395387	GV	Wed. 2	J/M/F	B2	Rec.	実習	日本語中上総文法・語彙(秋冬)	UEDA.M.	植田みのり	文法によって異なる表現形式
47	395388	GV	Wed. 3	J/M/F	B2	Rec.	実習	日本語中上総文法・語彙(秋冬)	HATANO	波多野吉徳	類義表現と言い換え
48	395389	GV	Thu. 3	J/M/F	B2	Rec.	実習	日本語中上総文法・語彙(秋冬)	KOZAKURA	小桜真未	学術的な場面に見える表現形式
49	395390	GV	Fri. 1	J/M/F	B2	Rec.	実習	日本語中上総文法・語彙(秋冬)	INUJ	乾逸子	論文・発表のための日本語
50	395092	KV	Mon. 2	J/M/F	B2	Rec.	実習	日本語中上総漢字・語彙(秋冬)	MIURA	三浦景星	理解語彙を増やすためのストラテジー
51	395093	KV	Tue. 2	J/M/F	B2	Rec.	実習	日本語中上総漢字・語彙(秋冬)	FURUKAWA	古川由理子	連想マップで学ぶ漢字語彙
52	395094	KV	Wed. 1	J/M/F	B2	Rec.	実習	日本語中上総漢字・語彙(秋冬)	AKIYAMA	秋山麻衣耶	理解語彙を増やすためのストラテジー
53	395095	KV	Wed. 3	J/M/F	B2	Rec.	実習	日本語中上総漢字・語彙(秋冬)	UEDA.M.	植田みのり	関連語を通して学ぶ漢字語彙
54	395096	KV	Thu. 1	J/M/F	B2	Rec.	実習	日本語中上総漢字・語彙(秋冬)	YAMAZAWA	山澤園子	同音異字語
55	395097	KV	Thu. 4	J/M/F	B2	Rec.	実習	日本語中上総漢字・語彙(秋冬)	UEDA.A.	上田安希子	論文やレポートの漢字語彙

M Code	J Code	Category	Day・Period	Program	Level	Type	種別	授業科目名	Instructor(s)	教員	サブタイトル／授業テーマ
J/M/F (C1) Japanese Language Subjects											
日本語実習科目											
56	395099	RDG	Tue. 2	J/M/F	C1	Rec.	実習	日本語上級読解(秋冬)	NAKATA	中田一志	日本語学の文章の読解
57	395100	RDG	Wed. 2	J/M/F	C1	Rec.	実習	日本語上級読解(秋冬)	MIZUNO	水野亜紀子	文学作品の読解
58	395101	RDG	Thu. 1	J/M/F	C1	Rec.	実習	日本語上級読解(秋冬)	NONAKA	野中篤	異文化比較・異言語比較に関する読解
59	395102	RDG	Thu. 4	J/M/F	C1	Rec.	実習	日本語上級読解(秋冬)	OKUNO	奥野紗衣	現代社会に関連した文章の読解
60	395103	RDG	Fri. 4	J/M/F	C1	Rec.	実習	日本語上級読解(秋冬)	ATARASHI	新聖子	クリティカルリーディング
61	395105	LIS	Mon. 1	J/M/F	C1	Rec.	実習	日本語上級聴解(秋冬)	MURA	三浦真星	時事的な話題の独話・対話の詳細な聴解
62	395106	LIS	Mon. 3	J/M/F	C1	Rec.	実習	日本語上級聴解(秋冬)	CHIDA	千田愛	日本語・日本文化を題材とした対話や独話の聴解
63	395107	LIS	Tue. 1	J/M/F	C1	Rec.	実習	日本語上級聴解(秋冬)	FURUKAWA	古川由理子	やや専門的な学術分野の独話・対話の聴解
64	395108	LIS	Wed. 2	J/M/F	C1	Rec.	実習	日本語上級聴解(秋冬)	IWAY.	岩井康雄	複数人の会話を聞く技術
65	395109	LIS	Wed. 5	J/M/F	C1	Rec.	実習	日本語上級聴解(秋冬)	MURATA.K.	村田幸一	時事的な話題の独話・対話の詳細な聴解
66	395310	WRT	Mon. 4	J/M/F	C1	Rec.	実習	日本語上級文章表現(秋冬)	BABA	馬場裕子	学術的な文章を書くために必要なこと
67	395311	WRT	Wed. 2	J/M/F	C1	Rec.	実習	日本語上級文章表現(秋冬)	OZAWA	小澤智恵子	多様な場面における文書作成
68	395312	WRT	Thu. 2	J/M/F	C1	Rec.	実習	日本語上級文章表現(秋冬)	TANAKA.S.	田中里美	小論文・レポート作成の技法
69	395313	WRT	Thu. 3	J/M/F	C1	Rec.	実習	日本語上級文章表現(秋冬)	YAMAMOTO.K.	山本一也	映像を見て、文章を書く
70	395314	WRT	Fri. 2	J/M/F	C1	Rec.	実習	日本語上級文章表現(秋冬)	INUJ	乾逸子	学術的な文章を書くために必要なこと
71	395116	SPK	Mon. 1	J/M/F	C1	Rec.	実習	日本語上級口頭表現(秋冬)	TANAKA.Y.	田中泰子	ビジネス・コミュニケーション
72	395117	SPK	Tue. 2	J/M/F	C1	Rec.	実習	日本語上級口頭表現(秋冬)	UEDA.M.	植田みのり	議論
73	395118	SPK	Wed. 3	J/M/F	C1	Rec.	実習	日本語上級口頭表現(秋冬)	TAKAI	高井美穂	関係構築のための日本語会話
74	395119	SPK	Thu. 2	J/M/F	C1	Rec.	実習	日本語上級口頭表現(秋冬)	HATANO	波多野吉徳	議論
75	395120	SPK	Fri. 1	J/M/F	C1	Rec.	実習	日本語上級口頭表現(秋冬)	FURUTA	古田朋子	交渉会話
76	395121	SPK	Fri. 3	J/M/F	C1	Rec.	実習	日本語上級口頭表現(秋冬)	FUJIM.	藤井みゆき	議論
77	395124	GV	Mon. 2	J/M/F	C1	Rec.	実習	日本語上級文法・語彙(秋冬)	KISHIDA	岸田泰浩	関西弁の文法
78	395125	GV	Wed. 1	J/M/F	C1	Rec.	実習	日本語上級文法・語彙(秋冬)	TANAKA.M.	田中舞	時事日本語
79	395126	GV	Wed. 4	J/M/F	C1	Rec.	実習	日本語上級文法・語彙(秋冬)	NAKATA	中田一志	日本事情から見る言葉
80	395127	GV	Thu. 1	J/M/F	C1	Rec.	実習	日本語上級文法・語彙(秋冬)	FUJIC.	藤井千枝	名言・名句
81	395128	GV	Thu. 5	J/M/F	C1	Rec.	実習	日本語上級文法・語彙(秋冬)	KANAI	金居明生	時事日本語
82	395129	GV	Fri. 1	J/M/F	C1	Rec.	実習	日本語上級文法・語彙(秋冬)	FURUKAWA	古川由理子	類義表現と言ひ換え
83	395130	KV	Mon. 2	J/M/F	C1	Rec.	実習	日本語上級漢字・語彙(秋冬)	KURODA	黒田真代	新聞で用いられる漢語
84	395131	KV	Mon. 5	J/M/F	C1	Rec.	実習	日本語上級漢字・語彙(秋冬)	KAWASHIMA	川駕信恵	四字熟語
85	395132	KV	Tue. 1	J/M/F	C1	Rec.	実習	日本語上級漢字・語彙(秋冬)	KASAMATSU	笠松瑞子	同音異字語
86	395133	KV	Wed. 1	J/M/F	C1	Rec.	実習	日本語上級漢字・語彙(秋冬)	OZAWA	小澤智恵子	理解語彙を増やすためのストラテジー
87	395134	KV	Fri. 2	J/M/F	C1	Rec.	実習	日本語上級漢字・語彙(秋冬)	SUZUKI.Y.	鈴木由香里	同音異字・同訓異字語

M Code	J Code	Category	Day・Period	Program	Level	Type	種別	授業科目名	Instructor(s)	教員	サブタイトル／授業テーマ
J/M (B2) Research Subjects 研究科目											
395140	39JN00	LIN	Wed. 3	J/M	B2	Lec./Sem.	講義/演習	日本語学研究基礎(秋冬)1	NAKATA	中田一志	語用論
395141	39JN02	LIN	Wed. 5	J/M	B2	Lec./Sem.	講義/演習	日本語学研究基礎(秋冬)2	SHOJI	荏司育子	形態論
395155	39JE02	EDU	Mon. 5	J/M	B2	Lec./Sem.	講義/演習	日本語教育学研究基礎(秋冬)1	KOMORI	小森万里	日本語教育学概論
395156	39JE04	EDU	Fri. 3	J/M	B2	Lec./Sem.	講義/演習	日本語教育学研究基礎(秋冬)2	SUZUKI.Y.	鈴木由香里	文法・語彙の指導
395165	39JT00	THO	Mon. 1	J/M	B2	Lec./Sem.	講義/演習	日本思想文化学研究基礎(秋冬)1	MOTOBAYASHI	本林靖久	日本民俗文化論
395166	39JT02	THO	Tue. 1	J/M	B2	Lec./Sem.	講義/演習	日本思想文化学研究基礎(秋冬)2	SHIBATA etc.	柴田芳成ほか	日本文化入門
395167	39JT04	THO	Fri. 3	J/M	B2	Lec./Sem.	講義/演習	日本思想文化学研究基礎(秋冬)3	WATANABEC.	渡邊親文	日本宗教思想論
395168	39JT06	THO	Fri. 4	J/M	B2	Lec./Sem.	講義/演習	日本思想文化学研究基礎(秋冬)4	ONISHI	大西薫	日本宗教文化論
395181	39JH02	HIS	Mon. 3	J/M	B2	Lec./Sem.	講義/演習	日本歴史文化学研究基礎(秋冬)2	HISAOKA	久岡明穂	茶道
395182	39JH04	HIS	Mon. 5	J/M	B2	Lec./Sem.	講義/演習	日本歴史文化学研究基礎(秋冬)3	FUKUMITSU	福光由布	書道
395183	39JH06	HIS	Wed. 4	J/M	B2	Lec./Sem.	講義/演習	日本歴史文化学研究基礎(秋冬)4	SANO.M.	佐野方郁	日本史入門
395184	39JH08	HIS	Thu. 4	J/M	B2	Lec./Sem.	講義/演習	日本歴史文化学研究基礎(秋冬)5	INOMO	井面舞	日本美術史
395185	39JH10	HIS	Fri. 1	J/M	B2	Lec./Sem.	講義/演習	日本歴史文化学研究基礎(秋冬)6	SATO.S.	佐藤早紀子	日本文化史入門
395186	39JH12	HIS	Fri. 4	J/M	B2	Lec./Sem.	講義/演習	日本歴史文化学研究基礎(秋冬)7	INOUE	井上徳子	東西交渉史
395190	39JL00	LIT	Mon. 3	J/M	B2	Lec./Sem.	講義/演習	日本文献文化学研究基礎(秋冬)1	GONOJI	五之治昌比呂	日本近現代文学
395191	39JL02	LIT	Mon. 4	J/M	B2	Lec./Sem.	講義/演習	日本文献文化学研究基礎(秋冬)2	HISAOKA	久岡明穂	日本古典文学
395201	39JC02	CON	Mon. 5	J/M	B2	Lec./Sem.	講義/演習	日本近現代文化学研究基礎(秋冬)2	TSUNODA	角田燎	社会学
395202	39JC04	CON	Wed. 1	J/M	B2	Lec./Sem.	講義/演習	日本近現代文化学研究基礎(秋冬)3	BEREZIKOVA	ベレジコフ, T.	日本近現代文化史
395203	39JC06	CON	Wed. 2	J/M	B2	Lec./Sem.	講義/演習	日本近現代文化学研究基礎(秋冬)4	IWAIS.	岩井茂樹	比較文化学
395204	39JC08	CON	Thu. 4	J/M	B2	Lec./Sem.	講義/演習	日本近現代文化学研究基礎(秋冬)5	KOBAYASHI.S.	小林翔	マンガ・アニメ学
395205	39JC10	CON	Thu. 5	J/M	B2	Lec./Sem.	講義/演習	日本近現代文化学研究基礎(秋冬)6	PENG	彭永成	日本のメディア文化
395215	39JS00	SOC	Wed. 2	J/M	B2	Lec./Sem.	講義/演習	日本社会文化学研究基礎(秋冬)1	IMURA	井村美根	日本経営学
395216	39JS02	SOC	Wed. 5	J/M	B2	Lec./Sem.	講義/演習	日本社会文化学研究基礎(秋冬)2	NAKAMURA.Y.	中村友一	日本政治学
395217	39JS04	SOC	Fri. 4	J/M	B2	Lec./Sem.	講義/演習	日本社会文化学研究基礎(秋冬)3	ITO	伊藤敏雄	日本経済学

M Code	J Code	Category	Day・Period	Program	Level	Type	種別	授業科目名	Instructor(s)	教員	サブタイトル/授業テーマ
J/M (C1) Research Subjects 研 究 科 目											
112	395136	39JN22	LN	Mon. 5	J/M	C1	Lec./Sem.	講義/演習	日本語学研究(秋冬)1	IMAI	意味論
113	395137	39JN24	LN	Wed. 4	J/M	C1	Lec./Sem.	講義/演習	日本語学研究(秋冬)2	IWAI.Y.	音声学・音韻論
114	395150	39JE22	EDU	Mon. 3	J/M	C1	Lec./Sem.	講義/演習	日本語教育学研究(秋冬)1	FUJHIRA	専門日本語教育とICT
115	395151	39JE24	EDU	Mon. 4	J/M	C1	Lec./Sem.	講義/演習	日本語教育学研究(秋冬)2	TACHIKAWA	日本語教授法・異文化理解論
116	395175	39JH22	HIS	Wed. 3	J/M	C1	Lec./Sem.	講義/演習	日本歴史文化学研究(秋冬)1	SANO.M.	日本近現代史
117	395176	39JH24	HIS	Thu. 1	J/M	C1	Lec./Sem.	講義/演習	日本歴史文化学研究(秋冬)2	TAIRA	日本近世史
118	395177	39JH26	HIS	Thu. 3	J/M	C1	Lec./Sem.	講義/演習	日本歴史文化学研究(秋冬)3	INO.MO	日本美術史
119	395178	39JH28	HIS	Thu. 4	J/M	C1	Lec./Sem.	講義/演習	日本歴史文化学研究(秋冬)4	YAMAMOTO.K.	日本古代史
120	395179	39JH30	HIS	Fri. 4	J/M	C1	Lec./Sem.	講義/演習	日本歴史文化学研究(秋冬)5	KOYAMA	日本服装史
121	395285	39JL22	LIT	Tue. 2	J/M	C1	Lec./Sem.	講義/演習	日本文献文化学研究(秋冬)1	MIZUNO	日本近現代文学
122	395286	39JL24	LIT	Fri. 2	J/M	C1	Lec./Sem.	講義/演習	日本文献文化学研究(秋冬)2	SATO.S.	日本古典文法
123	395287	39JL26	LIT	Fri. 3	J/M	C1	Lec./Sem.	講義/演習	日本文献文化学研究(秋冬)3	SHIBATA	日本古典文学
124	395195	39JC22	CON	Mon. 2	J/M	C1	Lec./Sem.	講義/演習	日本近現代文化学研究(秋冬)1	MOTOBAYASHI	日本現代社会
125	395196	39JC24	CON	Mon. 4	J/M	C1	Lec./Sem.	講義/演習	日本近現代文化学研究(秋冬)2	TSUDA	日本の映画
126	395197	39JC26	CON	Wed. 5	J/M	C1	Lec./Sem.	講義/演習	日本近現代文化学研究(秋冬)3	YANAGIDA	教育社会学
127	395198	39JC28	CON	Fri. 3	J/M	C1	Lec./Sem.	講義/演習	日本近現代文化学研究(秋冬)4	KOYAMA	女性学
128	395210	39JS22	SOC	Mon. 4	J/M	C1	Lec./Sem.	講義/演習	日本社会文化学研究(秋冬)1	HAYASHI.H.	国際関係
129	395211	39JS24	SOC	Thu. 5	J/M	C1	Lec./Sem.	講義/演習	日本社会文化学研究(秋冬)2	KIMURA	日本の法律
J (B1) Japanese Language Subjects 日本語実習科目 (JGV)											
130	—	39JGV1	JGV	Mon. 3	J	B1	Rec.	実習	日本語中級文法・語彙(秋冬)	KURODA	—
131	—	39JGV2	JGV	Tue. 2	J	B1	Rec.	実習	日本語中級文法・語彙(秋冬)	KIDA	—
132	—	39JGV3	JGV	Thu. 3	J	B1	Rec.	実習	日本語中級文法・語彙(秋冬)	FUJILC.	—
133	—	39JGV4	JGV	Thu. 4	J	B1	Rec.	実習	日本語中級文法・語彙(秋冬)	KANAI	—
Directed Research & Reading Subjects 日本語・日本文化研究 / 研修指導 (JDR)											
134	—	39J041	JDR	Tue. 3	J	—	Sem.	演習	日本語・日本文化研究指導(秋冬)	GONO.JI	五之治昌比呂
135	—	39J043	JDR	Tue. 3	J	—	Sem.	演習	日本語・日本文化研究指導(秋冬)	NAKATA	中田一志
136	—	39J044	JDR	Tue. 3	J	—	Sem.	演習	日本語・日本文化研究指導(秋冬)	MURATA.M.	村田真実
137	—	39J058	JDR	Tue. 3	J	—	Sem.	演習	日本語・日本文化研修指導(秋冬)	SHIBATA	柴田芳成
138	—	39J059	JDR	Tue. 3	J	—	Sem.	演習	日本語・日本文化研修指導(秋冬)	MIZUNO	水野亜紀子
139	—	39J042	JDR	Tue. 4	J	—	Sem.	演習	日本語・日本文化研究指導(秋冬)	SHOJI	荘司育子
140	—	39J045	JDR	Tue. 4	J	—	Sem.	演習	日本語・日本文化研究指導(秋冬)	IWAI.S.	岩井茂樹
141	—	39J046	JDR	Tue. 4	J	—	Sem.	演習	日本語・日本文化研究指導(秋冬)	IWAI.Y.	岩井康雄
142	—	39J047	JDR	Tue. 4	J	—	Sem.	演習	日本語・日本文化研究指導(秋冬)	GONO.JI	五之治昌比呂
143	—	39J048	JDR	Tue. 4	J	—	Sem.	演習	日本語・日本文化研究指導(秋冬)	KOMORI	小森万里
144	—	39J049	JDR	Tue. 4	J	—	Sem.	演習	日本語・日本文化研究指導(秋冬)	SANO.M.	佐野芳都
145	—	39J050	JDR	Tue. 4	J	—	Sem.	演習	日本語・日本文化研究指導(秋冬)	SHIBATA	柴田芳成
146	—	39J051	JDR	Tue. 4	J	—	Sem.	演習	日本語・日本文化研究指導(秋冬)	TAKAI	高井美穂
147	—	39J052	JDR	Tue. 4	J	—	Sem.	演習	日本語・日本文化研究指導(秋冬)	TACHIKAWA	立川真紀絵
148	—	39J053	JDR	Tue. 4	J	—	Sem.	演習	日本語・日本文化研究指導(秋冬)	MIZUNO	水野亜紀子
149	—	39J054	JDR	Tue. 4	J	—	Sem.	演習	日本語・日本文化研究指導(秋冬)	MURATA.M.	村田真実
150	—	39J055	JDR	Tue. 5	J	—	Sem.	演習	日本語・日本文化研究指導(秋冬)	FUJHIRA	藤平愛美
151	—	39J056	JDR	Tue. 5	J	—	Sem.	演習	日本語・日本文化研究指導(秋冬)	MATSUMURA	松村薫子
152	—	39J057	JDR	Tue. 5	J	—	Sem.	演習	日本語・日本文化研究指導(秋冬)	YAMAKAWA	山川太
153	—	39J061	JDR	Tue. 5	J	—	Sem.	演習	日本語・日本文化研修指導(秋冬)	IMAI	今井忍
154	—	39J062	JDR	Tue. 5	J	—	Sem.	演習	日本語・日本文化研修指導(秋冬)	MATSUURA	松浦幸祐

M Code	J Code	Category	Day-Period	Program	Level	Type	種別	授業科目名	Instructor(s)	教員	サブタイトル/授業テーマ
M (A2) Japanese Language Subjects 日本語実習科目 (MG V)											
155	395001	—	MGV α	Mon. 2	M	A2	Rec.	実習	KYOTANI	京谷麻矢	—
156	395001	—	MGV α	Tue. 2	M	A2	Rec.	実習	MATSUKA	松岡里奈	—
157	395001	—	MGV α	Thu. 2	M	A2	Rec.	実習	KOZAKURA	小椋真未	—
158	395001	—	MGV α	Fri. 2	M	A2	Rec.	実習	FUJIM.	藤井みゆき	—
159	395002	—	MGV β	Mon. 1	M	A2	Rec.	実習	MATSUSHIMA	松島弘枝	—
160	395002	—	MGV β	Wed. 2	M	A2	Rec.	実習	AKIYAMA	秋山麻衣耶	—
M (B1) Japanese Language Subjects 日本語実習科目 (MG V)											
161	395003	—	MGV α1	Mon. 2	M	B1	Rec.	実習	TACHIKAWA	立川真紀絵	—
162	395003	—	MGV α1	Tue. 2	M	B1	Rec.	実習	KASAMATSU	笠松瑞子	—
163	395003	—	MGV α1	Thu. 2	M	B1	Rec.	実習	TANAKA.MA.	田中真衣	—
164	395003	—	MGV α1	Fri. 2	M	B1	Rec.	実習	SHINJO	新庄あいみ	—
165	395004	—	MGV α2	Mon. 2	M	B1	Rec.	実習	TANAKA.Y.	田中泰子	—
166	395004	—	MGV α2	Tue. 2	M	B1	Rec.	実習	TAKAI	高井美穂	—
167	395004	—	MGV α2	Thu. 2	M	B1	Rec.	実習	FUJIC.	藤井千枝	—
168	395004	—	MGV α2	Fri. 2	M	B1	Rec.	実習	HIGUCHI	樋口尊子	—
169	395005	—	MGV α3	Mon. 2	M	B1	Rec.	実習	ARASHIMA	荒島和子	—
170	395005	—	MGV α3	Tue. 2	M	B1	Rec.	実習	SHOJI	荘司育子	—
171	395005	—	MGV α3	Thu. 2	M	B1	Rec.	実習	YAMAZAWA	山澤園子	—
172	395005	—	MGV α3	Fri. 2	M	B1	Rec.	実習	YAMAKAWA	山川太	—
M (—) Research Subjects in English 英語による研究科目											
173	395180	—	HIS	Mon. 4	M	—	Lec./Sem.	講義/演習	FUKUMITSU	福光由布	書道
174	395200	—	CON	Fri. 4	M	—	Lec./Sem.	講義/演習	WATANABE.C.	渡邊親文	日本現代社会
Directed Research and Reading Subjects 日本語日本文化専門演習 (MDR)											
175	395220	—	MDR	Tue. 3	M	—	Sem.	演習	IWALS.	岩井茂樹	—
176	395221	—	MDR	Tue. 3	M	—	Sem.	演習	TAKAI	高井美穂	—
177	395222	—	MDR	Tue. 3	M	—	Sem.	演習	TACHIKAWA	立川真紀絵	—
178	395223	—	MDR	Tue. 3	M	—	Sem.	演習	CIOLCA.R.	チョルカ. R.	—
179	395224	—	MDR	Tue. 3	M	—	Sem.	演習	MATSUKA	松岡里奈	—
180	395225	—	MDR	Tue. 3	M	—	Sem.	演習	WATANABEA.	渡邊あやめ	—
Independent Studies Subjects 自主研究科目 (MIS)											
181	395230	—	MIS	Tue. 5	M	—	Sem.	演習	IWALS.	岩井茂樹	—
182	395231	—	MIS	Tue. 5	M	—	Sem.	演習	GONOJI	五之治昌比呂	—
183	395232	—	MIS	Tue. 5	M	—	Sem.	演習	MURATA.M.	村田真実	—

じ かん わり
時 間 割
Weekly Schedule

令和7年度秋～冬学期時間割表

[illegible]

Fall and Winter Terms, 2025

Monday				Tuesday				Wednesday				Thursday				Friday			
Rq	U1	UJPN	CHIDA	Rq	U1	UJPN	KONDO	Rq	U	UJPN	INU1	Rq	U1	UJPN	KAN	Rq	U	UJPN	YAMAMOTO
Rq	U2	UJPN	SHIMA	Rq	U2	UJPN	KOBAYASHI, K.	Rq	U	UJPN	HAYASHI, KA.	Rq	U2	UJPN	MASHITA	Rq	U	UJPN	HIB1
Rq	U3	UJPN	MIYAZAKI	Rq	U3	UJPN	FUKUSHIMA	Rq	U4	UJPN	YAMAZAWA	Rq	U3	UJPN	NAKAMURA	Rq	U4	UJPN	FUJIMOTO
Rq	U4	UJPN	ISHIBASHI	Rq	U4	UJPN	SAITO	Rq	U5	UJPN	KYOTANI	Rq	U4	UJPN	OKEGAWA	Rq	U5	UJPN	SUZUKI, M.
Rq	U5	UJPN	KIDA	Rq	U5	UJPN	YAMASHITA	Rq	U6	UJPN	SUZUKI, M.	Rq	U5	UJPN	HAYASHI, KI.	Rq	U6	UJPN	SAITO
Rq	U6	UJPN	FUJIMOTO	Rq	U6	UJPN	MARUYAMA	Rq	U7	UJPN	MIYAZAKI	Rq	U6	UJPN	ARASHIMA	Rq	U7	UJPN	OTSUKA
Rq	U7	UJPN	MARUYAMA	Rq	U7	UJPN	AKIYAMA	Rq	U8	UJPN	KOGA	Rq	U7	UJPN	MATSUMOTO, E.	Rq	U8	UJPN	NAKAJIMA
Rq	U8	UJPN	HAYASHI, KI.	Rq	U8	UJPN	OTSUKA	Rq	J/M/F	B1	ROG	Rq	U8	UJPN	MITO	E1	J/M/F	B1	RDG
Rq	M	A2	MATSUMOTO, E.	Rq	J/M/F	B1	DUONG, T.	Rq	J/M/F	B2	WRT	Rq	J/M/F	B1	ROG	E1	J/M/F	B2	L1S
E1	J/M/F	B1	ARASHIMA	E1	J/M/F	B2	SUMIDE	E1	J/M/F	B2	KV	E1	J/M/F	B2	RDG	E1	J/M/F	B2	GV
E1	J/M/F	B2	WADA	E1	J/M/F	B2	KIDA	E1	J/M/F	C1	GV	E1	J/M/F	B2	KV	E1	J/M/F	C1	SPK
E1	J/M/F	B2	KURODA	E1	J/M/F	C1	FURUKAWA	E1	J/M/F	C1	KV	E1	J/M/F	C1	RDG	E1	J/M/F	C1	GV
E1	J/M/F	C1	MIURA	E1	J/M/F	C1	KASAMATSU	E1	J/M	B2	CON	E1	J/M/F	C1	GV	E1	J/M	B2	H1S
E1	J/M/F	C1	TANAKA, Y.	E1	J/M	B2	SHIBATA etc.	E1	J/M	B2	BEREZIKOVA	E1	J/M	C1	H1S	E1	J/M	B2	SATO, S.
E1	J/M	B2	MOTOBAYASHI	E1	J/M	B2	SHIBATA etc.	E1	J/M	B2	BEREZIKOVA	E1	J/M	C1	H1S	E1	J/M	B2	SATO, S.

Monday				Tuesday				Wednesday				Thursday				Friday			
Rq	U1	UJPN	CHIDA	Rq	U1	UJPN	KONDO	Rq	U	UJPN	INU1	Rq	U1	UJPN	KAN	Rq	U	UJPN	YAMAMOTO
Rq	U2	UJPN	SHIMA	Rq	U2	UJPN	KOBAYASHI, K.	Rq	U	UJPN	HAYASHI, KA.	Rq	U2	UJPN	MASHITA	Rq	U	UJPN	HIB1
Rq	U3	UJPN	MIYAZAKI	Rq	U3	UJPN	FUKUSHIMA	Rq	U4	UJPN	YAMAZAWA	Rq	U3	UJPN	NAKAMURA	Rq	U4	UJPN	FUJIMOTO
Rq	U4	UJPN	ISHIBASHI	Rq	U4	UJPN	SAITO	Rq	U5	UJPN	KYOTANI	Rq	U4	UJPN	OKEGAWA	Rq	U5	UJPN	SUZUKI, M.
Rq	U5	UJPN	KIDA	Rq	U5	UJPN	YAMASHITA	Rq	U6	UJPN	SUZUKI, M.	Rq	U5	UJPN	HAYASHI, KI.	Rq	U6	UJPN	SAITO
Rq	U6	UJPN	FUJIMOTO	Rq	U6	UJPN	MARUYAMA	Rq	U7	UJPN	MIYAZAKI	Rq	U6	UJPN	ARASHIMA	Rq	U7	UJPN	OTSUKA
Rq	U7	UJPN	MARUYAMA	Rq	U7	UJPN	AKIYAMA	Rq	U8	UJPN	KOGA	Rq	U7	UJPN	MATSUMOTO, E.	Rq	U8	UJPN	NAKAJIMA
Rq	U8	UJPN	HAYASHI, KI.	Rq	U8	UJPN	OTSUKA	Rq	M	A2	MGV β	Rq	U8	UJPN	MITO	Rq	M	A2	MGV α
Rq	M	A2	MATSUMOTO, E.	Rq	M	A2	MATSUMOTO, E.	Rq	J/M/F	B1	L1S	Rq	M	A2	MGV α	Rq	M	B1	MGV α 1
Rq	M	B1	TACHIKAWA	Rq	M	B1	KASAMATSU	Rq	J/M/F	B2	SPK	Rq	M	B1	MGV α 1	Rq	M	B1	MGV α 2
Rq	M	B1	TANAKA, Y.	Rq	M	B1	TAKAI	Rq	J/M/F	B2	GV	Rq	M	B1	MGV α 2	Rq	M	B1	MGV α 3
Rq	M	B1	ARASHIMA	Rq	M	B1	SHOJI	Rq	J/M/F	C1	RDG	Rq	M	B1	MGV α 3	Rq	M	B1	MGV α 3
E1	J/M/F	B2	WADA	Rq	J	B1	KIDA	Rq	J/M/F	C1	L1S	E1	J/M/F	B2	L1S	E1	J/M/F	B2	RDG
E1	J/M/F	B2	MATSUMOTO, E.	E1	J/M/F	B2	SUMIDE	E1	J/M/F	C1	L1S	E1	J/M/F	B2	L1S	E1	J/M/F	B2	SPK
E1	J/M/F	B2	MIURA	E1	J/M/F	B2	FURUKAWA	E1	J/M/F	C1	WRT	E1	J/M/F	B2	WRT	E1	J/M/F	C1	WRT
E1	J/M/F	C1	KISHIDA	E1	J/M/F	C1	NAKATA	E1	J/M	B2	CON	E1	J/M/F	C1	WRT	E1	J/M/F	C1	KV
E1	J/M/F	C1	KURODA	E1	J/M/F	C1	UEDA, M.	E1	J/M	B2	SOC	E1	J/M/F	C1	WRT	E1	J/M/F	C1	KV
E1	J/M	C1	MOTOBAYASHI	E1	J/M	C1	MIZUNO	E1	J/M	B2	SOC	E1	J/M/F	C1	SPK	E1	J/M	C1	L1T

[illegible]

M

Fall and Winter Terms, 2025

Monday					Tuesday					Wednesday					Thursday					Friday				
level	subject	code	Instructor(s)		level	subject	code	Instructor(s)		level	subject	code	Instructor(s)		level	subject	code	Instructor(s)		level	subject	code	Instructor(s)	
A2	MGVβ	395002	MATSUSHIMA		B1	KV	395060	DUONG, T.		B1	RDG	395036	MATSUZAKI		B1	RDG	395037	YAMASHITA		B1	RDG	395038	JIN	
B1	SPK	395050	ARASHIMA		B2	RDG	395066	SUMIDE		B2	WRT	395377	KITAGAWA		B2	RDG	395068	TANAKA, S.		B2	LIS	395076	SHINJO	
B2	RDG	395065	WADA		B2	LIS	395073	KIDA		B2	KV	395094	AKIYAMA		B2	KV	395096	YAMAZAWA		B2	GV	395390	INUJ	
B2	WRT	395375	KURODA		C1	LIS	395107	FURUKAWA		C1	GV	395125	TANAKA, M.		C1	RDG	395101	NONAKA		C1	SPK	395120	FURUTA	
C1	LIS	395105	MIURA		C1	KV	395132	KASAMATSU		C1	KV	395133	OZAWA		C1	GV	395127	FUJII, C.		C1	GV	395129	FURUKAWA	
C1	SPK	395116	TANAKA, Y.		B2	THO	395166	SHIBATA etc.		B2	CON	395202	BEREZIKOVA		C1	HIS	395176	TAIRA		B2	HIS	395185	SATO, S.	
B2	THO	395165	MOTOBAYASHI																					
A2	MGVα	395001	KYOTANI		A2	MGVα	395001	MATSUOKA		A2	MGVβ	395002	AKIYAMA		A2	MGVα	395001	KOZAKURA		A2	MGVα	395001	FUJII, M.	
B1	MGVα1	395003	TACHIKAWA		B1	MGVα1	395003	KASAMATSU		B1	LIS	395041	HATANO		B1	LIS	395041	HATANO		B1	MGVα1	395003	SHINJO	
B1	MGVα2	395004	TANAKA, Y.		B1	MGVα2	395004	TAKAI		B2	SPK	395081	TANAKA, M.		B1	MGVα2	395004	FUJII, C.		B1	MGVα2	395004	HIGUCHI	
B1	MGVα3	395005	ARASHIMA		B1	MGVα3	395005	SHOJI		B2	GV	395387	UEDA, M.		B1	MGVα3	395005	YAMAZAWA		B1	MGVα3	395005	YAMAKAWA	
B2	LIS	395071	WADA		B2	GV	395386	SUMIDE		B2	RDG	395100	MIZUNO		B2	LIS	395074	NAMBA		B2	RDG	395070	FURUTA	
B2	SPK	395080	MATSUSHIMA		B2	KV	395093	FURUKAWA		C1	LIS	395108	IWAI, Y.		B2	WRT	395379	NONAKA		B2	SPK	395083	MATSUZAKI	
B2	KV	395092	MIURA		C1	RDG	395099	NAKATA		C1	WRT	395311	OZAWA		C1	WRT	395312	TANAKA, S.		C1	WRT	395314	INUJ	
C1	GV	395124	KISHIDA		C1	SPK	395117	UEDA, M.		B2	CON	395203	IWAI, S.		C1	SPK	395119	HATANO		C1	KV	395134	SUZUKI, Y.	
C1	KV	395130	KURODA		C1	LIT	395285	MIZUNO		B2	SOC	395215	IMURA		C1	LIT	395286	SATO, S.		C1	LIT	395287	SHIBATA	
C1	CON	395195	MOTOBAYASHI																					
A2	RDG	395010	TANAKA, Y.		MDR	395220	IWAI, S.		A2	LIS	395015	MIYAZAKI		A2	SPK	395025	MITO		A2	KV	395030	HIGUCHI		
B1	LIS	395040	KYOTANI		MDR	395221	TAKAI		B1	GV	395056	DUONG, T.		B1	WRT	395046	NAMBA		B1	KV	395064	WATANABE, A.		
B2	GV	395385	ISHIBASHI		MDR	395222	TACHIKAWA		B2	GV	395388	HATANO		B2	RDG	395069	MASHITA		B2	SPK	395084	ATARASHI		
C1	LIS	395106	CHIDA		MDR	395223	CIOLCA, R.		B2	KV	395095	UEDA, M.		B2	SPK	395082	TANAKA, MA.		C1	SPK	395121	FUJII, M.		
B2	HIS	395181	HISHOKA		MDR	395224	MATSUOKA		C1	SPK	395118	TAKAI		B2	GV	395389	KOZAKURA		B2	EDU	395156	SUZUKI, Y.		
B2	LIT	395190	GONOJI		MDR	395225	WATANABE, A.		B2	LIN	395140	NAKATA		C1	WRT	395313	YAMANOTO, K.		B2	THO	395167	WATANABE, C.		
C1	EDU	395150	FUJIIHARA						C1	HIS	395175	SANO, M.		C1	HIS	395177	INOMO		C1	LIT	395287	SHIBATA		
—	HIS	395180	FUKUMITSU						A2	GV	395055	DUONG, T.		A2	WRT	395020	ATSUTA		—	CON	395200	WATANABE, C.		
B2	LIS	395072	KAWASHIMA		B1	WRT	395045	WADA	B1	WRT	395045	WADA		B1	SPK	395051	KAI		C1	RDG	395103	ATARASHI		
B2	WRT	395376	KOMORI		B2	RDG	395067	HIROKAWA	B2	RDG	395067	HIROKAWA		B2	KV	395097	UEDA, A.		B2	THO	395168	ONISHI		
C1	WRT	395310	BABA		C1	GV	395126	NAKATA	C1	GV	395126	NAKATA		C1	RDG	395102	OKUNO		B2	HIS	395186	INOUE		
B2	LIT	395191	HISHOKA		B2	HIS	395183	SANO, M.	B2	HIS	395183	SANO, M.		B2	HIS	395184	INOMO		B2	SOC	395217	IITO		
C1	EDU	395151	TACHIKAWA		C1	LIN	395137	IWAI, Y.	C1	LIN	395137	IWAI, Y.		B2	CON	395204	KOBAYASHI, S.		C1	HIS	395179	KOYAMA		
C1	CON	395196	TSUDA						C1	LIN	395137	IWAI, Y.		C1	HIS	395178	YAMANOTO, K.							
C1	SOC	395210	HAYASHI, H.																					
C1	KV	395131	KAWASHIMA		MIS	395230	IWAI, S.		B1	KV	395062	WADA		B1	GV	395057	KIM							
B2	EDU	395155	KOMORI		MIS	395231	GONOJI		B2	WRT	395378	HIROKAWA		B2	LIS	395075	ATSUTA							
B2	HIS	395182	FUKUMITSU		MIS	395232	MURATA, M.		C1	LIS	395109	MURATA, K.		B2	WRT	395380	OKUNO							
B2	CON	395201	TSUNODA						B2	LIN	395141	SHOJI		C1	GV	395128	KANAI							
C1	LIN	395136	IMAI		B2	SOC	395216	NAKANURA, Y.		B2	SOC	395216	NAKANURA, Y.		CON	395205	PENG							
					C1	CON	395197	YAMAGIDA		C1	CON	395197	YAMAGIDA		SOC	395211	KIMURA							

My Weekly Schedule

I	II	III	IV	V
Monday				
Tuesday				
Wednesday				
Thursday				
Friday				

りゃくごう
略号 / Abbreviations

プログラム/Programs	
【U】	Undergraduate Students Program
【J】	Japanese Studies Program
【M】	Maple Program
【F】	Foundation Program (秋～冬学期のみ)
【O】	O-M Program (春～夏学期のみ)

日本語レベル/Japanese Levels	
A2	初中級/Pre-intermediate
B1	中級/Intermediate
B2	中上級/Upper-intermediate
C1	上級/Advanced

授業科目/Subjects for 【J】 【M】 【F】 【O】 Programs	
日本語実習科目/Japanese Language Subjects	
RDG	読解/Reading
LIS	聴解/Listening
WRT	文章表現/Writing
SPK	口頭表現/Speaking
GV	文法・語彙/Grammar & Vocabulary
KV	漢字・語彙/Kanji & Vocabulary
JWRT	J文章表現/Writing for 【J】 Program Students (春～夏学期のみ)
JGV	日本語初中級文法・語彙/日本語中級文法・語彙/Grammar & Vocabulary for 【J】 Program Students (秋～冬学期のみ)
MGV	現代日本語初中級文法・語彙/現代日本語中級文法・語彙/Grammar & Vocabulary for 【M】 Program Students
研究科目/Research Subjects	
LIN	日本語学研究基礎/日本語学研究/Japanese Linguistics
EDU	日本語教育学研究基礎/日本語教育学研究/Japanese Language Education
THO	日本思想文化学研究基礎/日本思想文化学研究/Japanese Thought
HIS	日本歴史文化学研究基礎/日本歴史文化学研究/Japanese History
LIT	日本文献文化学研究基礎/日本文献文化学研究/Japanese Literature
CON	日本近現代文化学研究基礎/日本近現代文化学研究/Japanese Contemporary Culture
SOC	日本社会文化学研究基礎/日本社会文化学研究/Japanese Social Sciences
演習科目/Seminar Subjects	
JDR	日本語・日本文化研究指導/日本語・日本文化研修指導/Directed Research and Reading for 【J】 Program
MDR	日本語日本文化専門演習/Directed Research and Reading for 【M】 Program Students
MIS	自主研究/Independent Studies for 【M】 Program Students
MCC	多文化・地域共生/Multicultural Community Cohesion

授業科目/Subjects for 【U】 【F】 【O】 Programs	
UJPN	学部留学生日本語/Japanese for 【U】 Program Students
FJPN	私費学部留学生日本語/Japanese for 【F】 Program Students (秋～冬学期のみ)
OJPN	大阪・マヒドン留学生日本語/Japanese for 【O】 Program Students (春～夏学期のみ)
JC	日本事情/Japanese Cultural Background
BIOL	生物/Biology
CHEM	化学/Chemistry
MATH	数学/Mathematics
PHYS	物理/Physics
HIST	日本史/History (秋～冬学期のみ)
POLI	政治・経済/Politics & Economics (秋～冬学期のみ)
ENG	英語/English

み の お
箕面キャンパスマップ
Minoh Campus Map

箕面キャンパスマップ Minoh Campus Map

- ❶ Graduate School of Language and Culture/School of Foreign Studies
- ❷ Center for Japanese Language and Culture
- ❸ International Studies Library

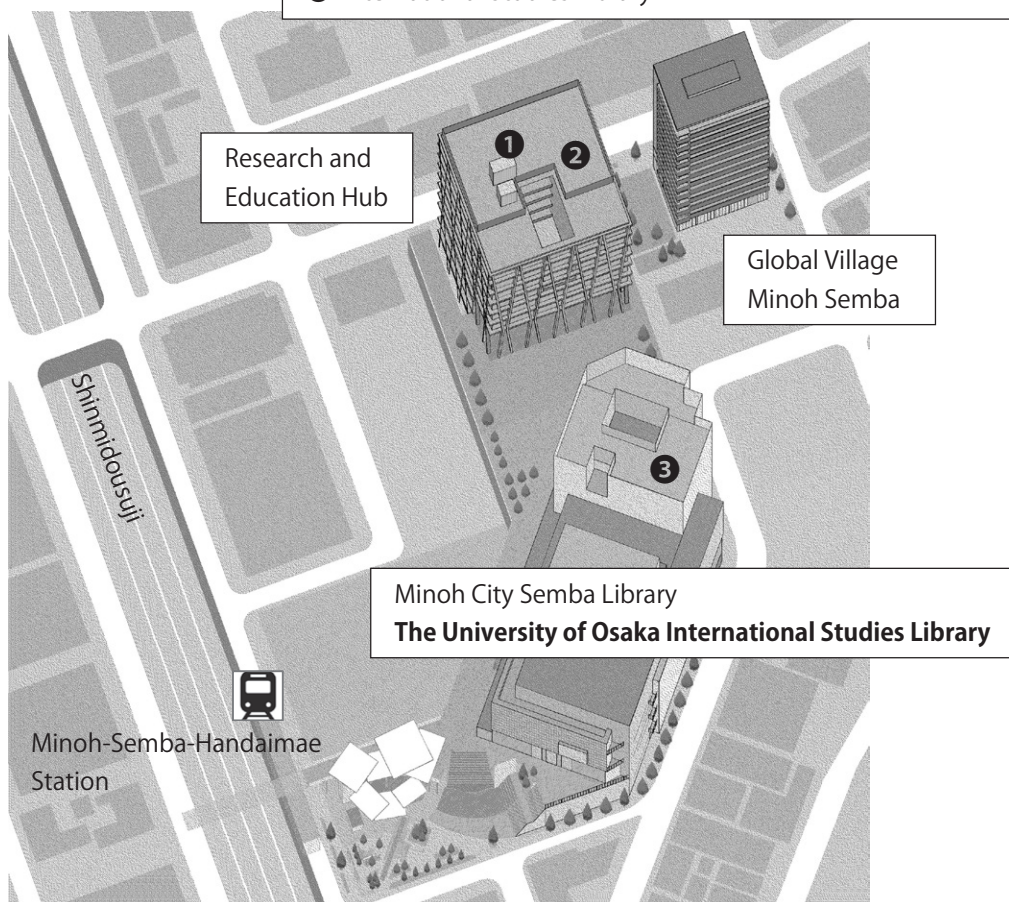

○住所

〒562-8678 大阪府箕面市船場東 3 丁目 5 番 10 号 / 3-5-10, Senba-higashi, Minoh, Osaka

【周辺駅・バス停地図 / Map of the surrounding Area】



○アクセス

- 電車 北大阪急行線 箕面船場阪大前駅下車 徒歩 約 3 分
- バス 阪急バス [千里中央バスターミナルから]
箕面中央線 箕面船場阪大前駅バス停下車 徒歩 約 3 分
小野原東線 (※朝・夕のみ) 船場団地バス停下車 徒歩 約 1 分
豊中市内線 新船場南橋バス停下車 徒歩 約 7 分

○How to get to Minoh Campus

- By railway
Kita Osaka Kyuko Railway, get off at Minoh-Semba-Handai-mae Station
→ 3 minutes on foot
- By Bus
Hankyu Bus [From Senri-Chuo Bus Terminal]
Minoh Chuo Line, get off at Minoh-Semba-Handai-mae Station bus stop
→ 3 minutes on foot
Onohara Higashi Line (*only in the morning and evening), get off at Senba Danchi bus stop
→ 1 minute on foot
Toyonaka City Line, get off at ShinSemba Minami-bashi bus stop
→ 7 minutes on foot

フロア図（関連部分抜粋）

外国学研究講義棟 Research and Education Hub	
10F	外国語学部
9F	外国語学部
8F	外国語学部
7F	日日センター CILC (Center for Japanese Language and Culture)
6F	講義室
5F	講義室・交流空間
4F	D3(旧サイバー)・講義
3F	食堂、ロビー、 南玄関
2F	事務部門・会議等
1F	北玄関, 記念ホール, 設備等

ピロティ

1F

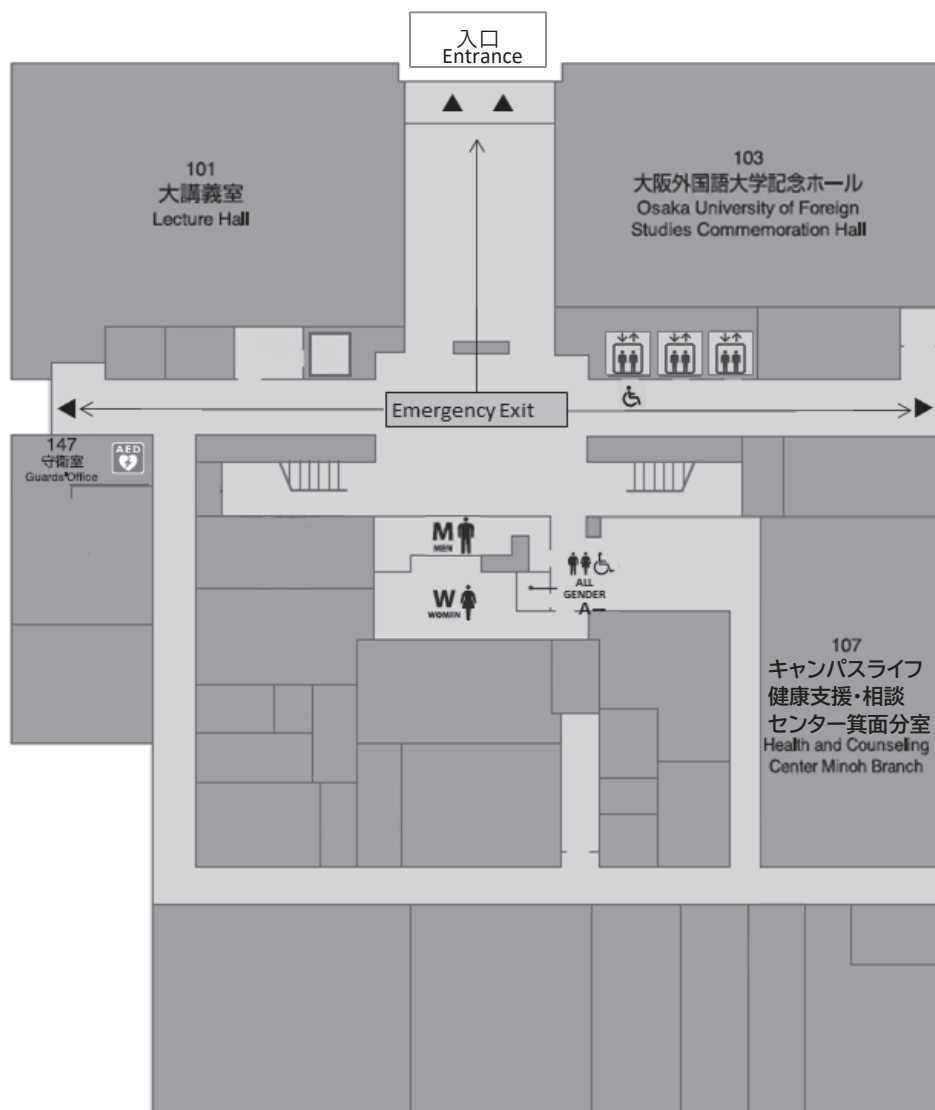

2F

吹き抜け

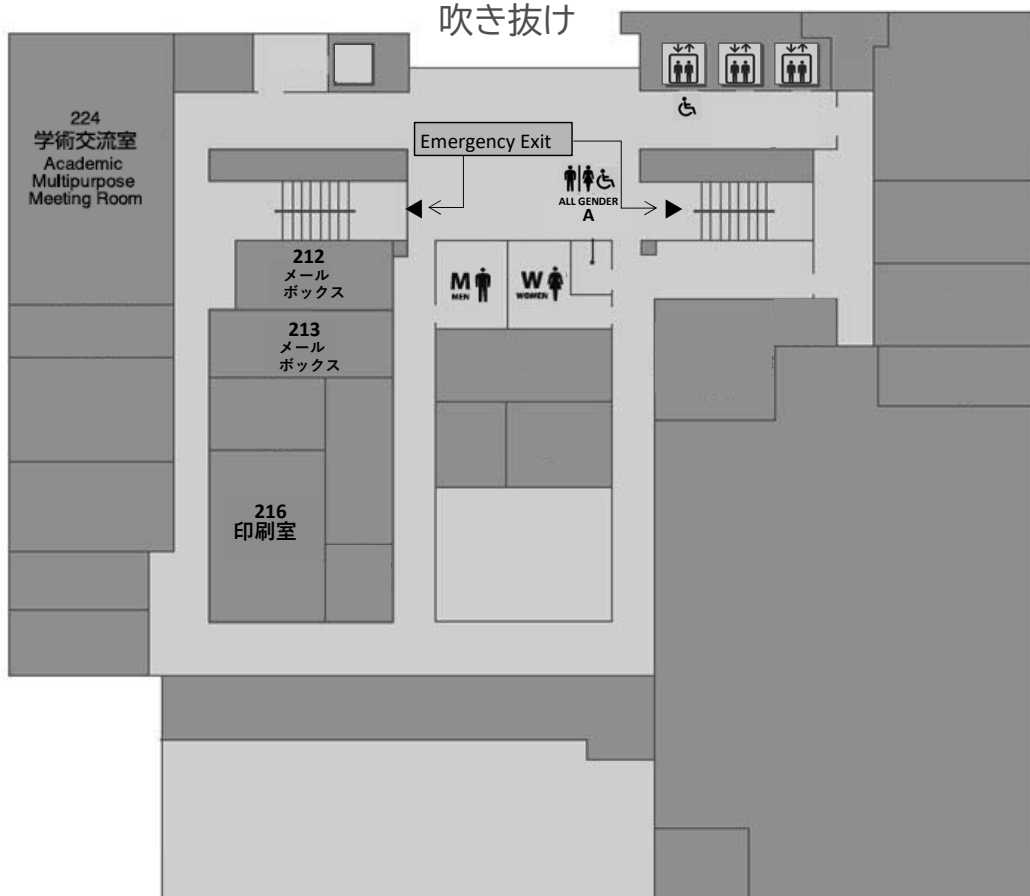

5F

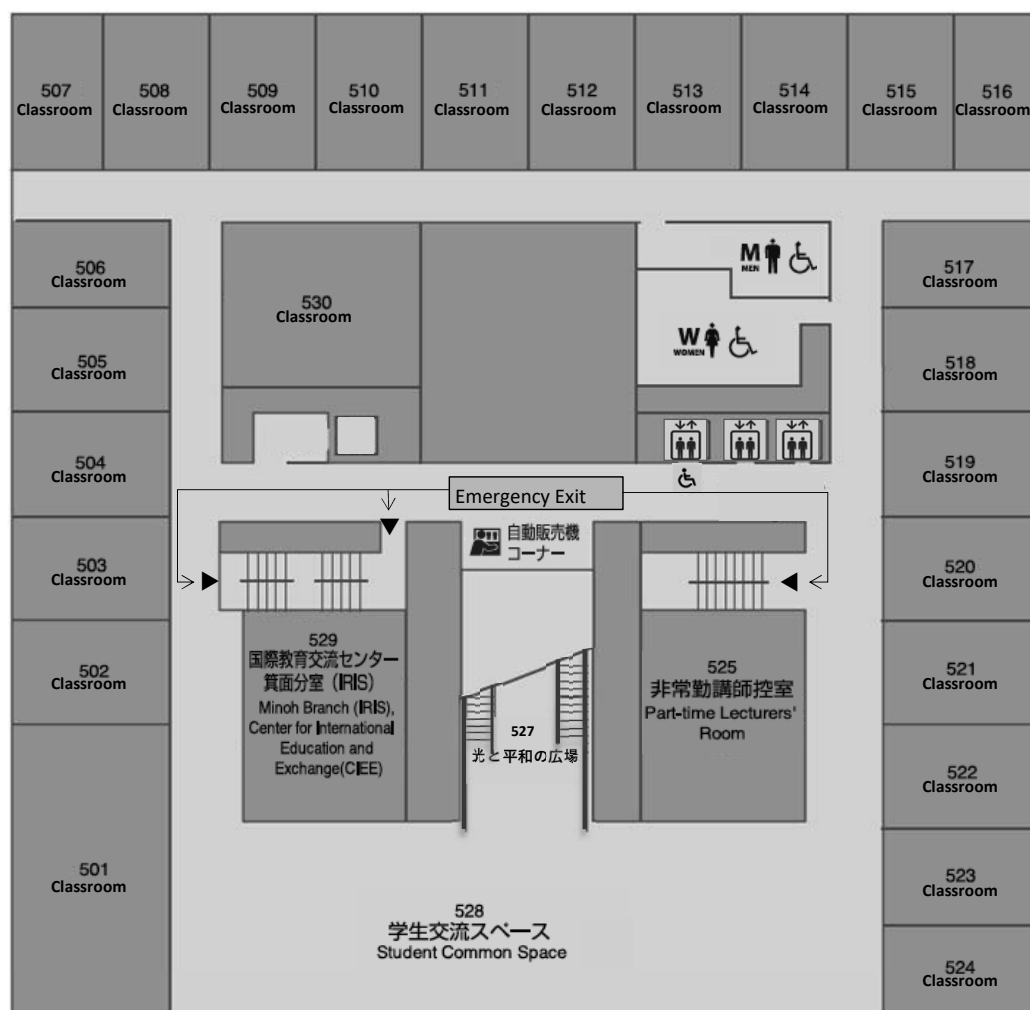

6F

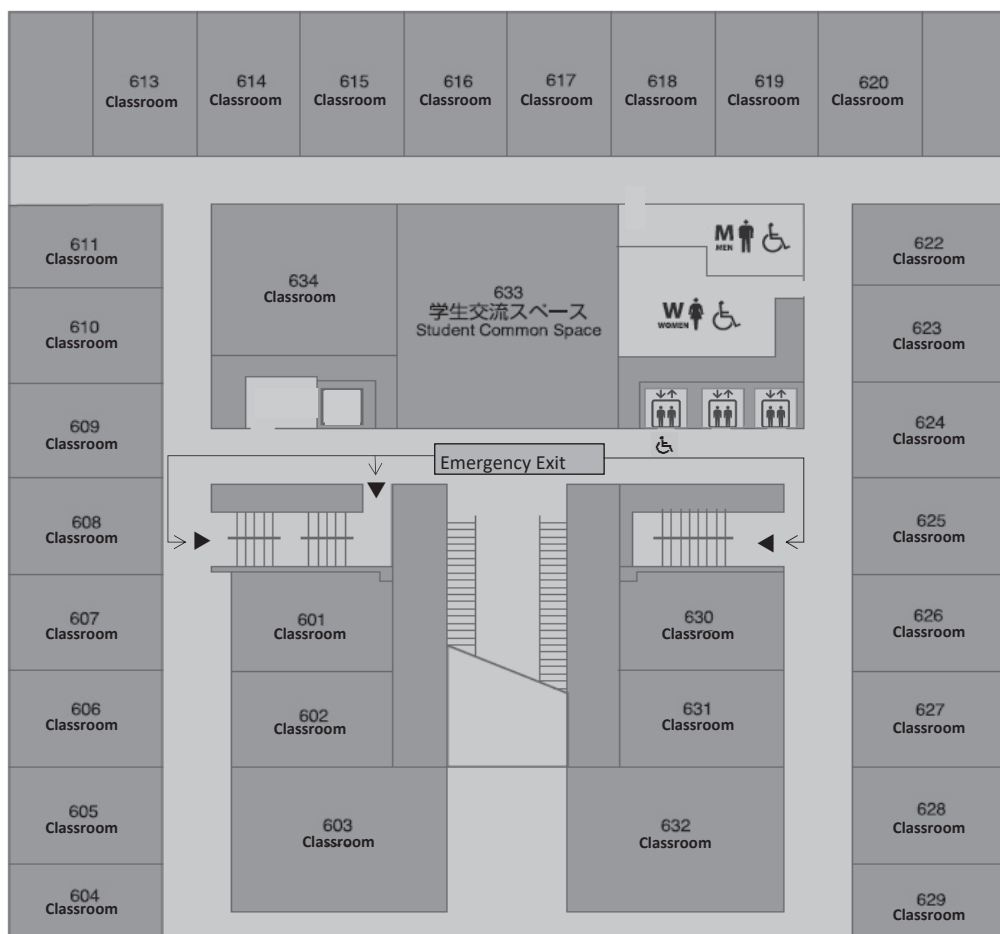

7F

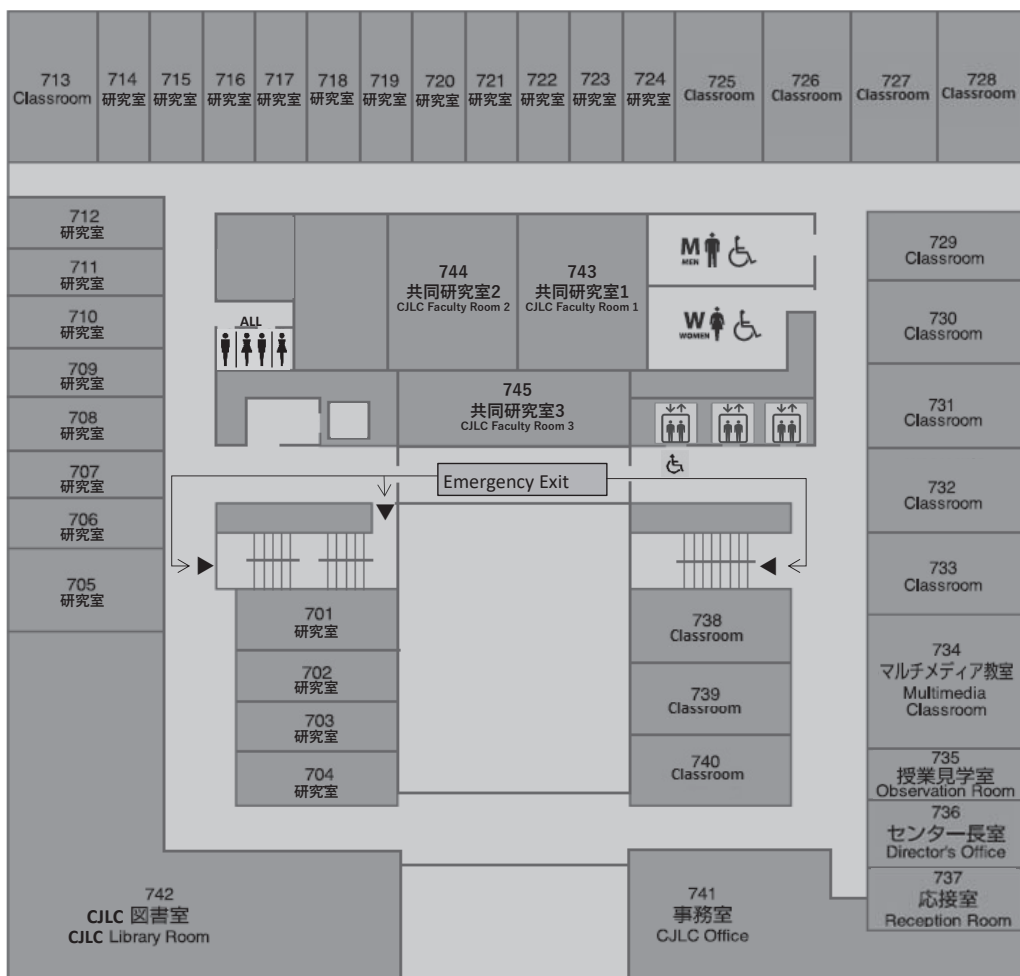

部屋番号 Room Number	施設 Facility
743	共同研究室 1 CJLC Faculty Room 1
744	共同研究室 2 CJLC Faculty Room 2
745	共同研究室 3 CJLC Faculty Room 3

教員研究室

Instructor's Office

部屋番号 Room Number	教 員 名 Instructor's Name	部屋番号 Room Number	教 員 名 Instructor's Name
701	日比 伊奈穂 HIBI I.	714	松浦 幸祐 MATSUURA K.
702	松岡 里奈 MATSUOKA R.	715	岩井 康雄 IWAI Y.
703	下村 朱有美 SHIMOMURA A.	716	佐野 方郁 SANO M.
704	藤平 愛美 FUJIHIRA M.	717	高井 美穂 TAKAI M.
705	チョルカ ラルカ マリア CIOLCA R. 渡邊 あやめ WATANABE A.	718	岸田 泰浩 KISHIDA Y.
706	松村 薫子 MATSUMURA K.	719	荘司 育子 SHOJI I.
707	中谷 真也 NAKATANI S.	720	小森 万里 KOMORI M.
708	岩井 茂樹 IWAI S.	721	水野 亜紀子 MIZUNO A.
709	中田 一志 NAKATA H.	722	立川 真紀絵 TACHIKAWA M.
710	柴田 芳成 SHIBATA Y.	723	五之治 昌比呂 GONOJI M.
711	今井 忍 IMAI S.	724	村田 真実 MURATA M.
712	山川 太 YAMAKAWA F.		

アドバイザー /Advisors

[U] Program		[J] Program	
U1 } U8	YAMAKAWA F.	SHIBATA Y.	
	IMAI S.	IWAI Y.	
	MATSUMURA K.	NAKATA H.	
	FUJIHIRA M.	IMAI S.	
	MATSUURA K.	SHOJI I.	
	HIBI I.	GONOJI M.	
	NAKATANI S.	IWAI S.	
	SHIMOMURA A.	KOMORI M.	
[M] Program		YAMAKAWA F.	
M1 } M6	TAKAI M.	MATSUMURA K.	
	IWAI S.	SANO M.	
	TACHIKAWA M.	MIZUNO A.	
	MATSUOKA R.	TAKAI M.	
	CIOLCA R.	MURATA M.	
	WATANABE A.	TACHIKAWA M.	
[F] Program		FUJIHIRA M.	
F1 } F2	SANO M.	MATSUURA K.	
	IWAI Y.		

発 行 令和 7 年 9 月

Published in September, 2025

編 集 大阪大学日本語日本文化教育センター

Edited by Center for Japanese Language and Culture,

The University of Osaka

〒562-8678 大阪府箕面市船場東 3 丁目 5 番10号

3-5-10, Senba-higashi, Minoh, Osaka

Phone (072) 730-5075, 5072

(日本語日本文化教育センター事務室)

<https://www.cjlc.osaka-u.ac.jp/>

Email cjlc@office.osaka-u.ac.jp